



KABE MADE IN
SWEDEN

KABE 2024

Motorhome



KABE



Always a step ahead...



At home – anywhere in the world!

Our goal is to be one step ahead and surprise you with technology and amenities beyond the ordinary. With functions that enhance your environment and improve your quality of life, wherever you are. It can be adventurous and strenuous, or calm and peaceful. The focus is always on design, comfort, quality and safety, seasoned with smart solutions for a greater experience and smoother holiday on wheels. In any season.

At home, anywhere you go!

KABE motorhomes are among the most well-equipped in the market, in every price segment. Find your favourite today.

Contents

04	SCANDINAVIAN DESIGN
14	COMFORT
26	QUALITY
36	SAFETY
46	2024 MODEL PROGRAM
48	KABE FLEXIBILITY
50	2024 STANDARD EQUIPMENT
56	KABE VAN
64	KABE NOVUM
70	KABE ROYAL
78	KABE CROWN
86	KABE IMPERIAL

KABE will not be held liable for printing errors and typos.
KABE reserves the right to change design and data without prior notice.
The images in this catalogue may contain some optional equipment.

SCANDINAVIAN DESIGN

With style and function

Scandinavian design and Swedish quality have always been the hallmark in the development of every KABE model. Style and function go hand in hand. The result is luxurious and comfortable motorhomes, with a timeless feel and many innovative solutions to provide you with a mobile holiday home beyond the ordinary.



KABE – an investment in quality of life

A motorhome from KABE is an investment in quality of life. We leave nothing to chance. For more than 65 years, we have developed and manufactured leisure vehicles that allow you to travel safely, securely and environmentally friendly on the road, while enjoying the greatest possible comfort at your destination.

Behind every detail there is a thought, to provide you with the very best. We go all the way – and then some – in our quest to fill our motorhomes with smart solutions and functions to provide you with a life-style that is as smooth as possible.

With KABE quality built into our unique construction, from carpentry produced in-house, to practical interior details and technical solutions that are always at the absolute forefront of the industry.

All the things you may not notice right away, when you compare a KABE with other brands, are there to make your motorhome life easier every single day.

All the "extras", are simply included from KABE.

Some examples are:

- Insulated energy efficient windows.
- Sound-insulating ceiling.
- Extra wide entrance door.
- KABE custom designed upholstery for front seats.
- KABE Smart D control panel.
- Smoke detector in the bedroom area.
- AGS II Pro automatic floor heating system.
- Indirect lighting, mood lighting and night lights.
- Passenger sofa with slide-out function in several models (not for Van and Novum Light).
- Drying cabinet with a custom design drip pan for drying shoes in several models.
- Built-in kitchen fan with lighting and two speeds.
- The best refrigerator ventilation in the market.

To find out more, see pages 28-35.



Updated exterior in 2024 – Royal, Crown and Imperial!



Luxury inside and out

Design, comfort, quality and safety – that's what KABE stands for. Our classic features are clearly recognizable on the road. And when you get to know your KABE, with all its well thought-out conveniences, you realize the true value of our design. It's all in the details.

KABE's characteristic exterior is a stylish statement. All motorhomes are designed with extra bold graphics and our unique Innovation Design décor is printed directly on the exterior with a high UV resistance. The colour will last for many years without fading.

Largest windows possible provide a bright and open indoor environment.

KABE Van, Crown and Imperial have LED headlights, for ultimate safety (available in Novum and Royal Design Packages).

Every motorhome has an extra wide entrance door. In our Novum and Royal models, the Hartal Evolution door is installed (except for 750 T, which features a Dometic door). Crown and Imperial include the HartaLux door, with extra strong hinges, frame and handle as well as a three-point lock. A sliding door is included in Van.

At KABE, we put a lot of work into the constant development of our motorhomes. We strive to be at the forefront or even a step ahead of the competition. To provide you, the KABE-owner, with the very best – a safe motorhome that maintains the highest standard and an exclusive feeling inside and out.

NEWS! New aluminium rims in all models (available in Novum and Royal Design Packages).

This year, we introduce two new models with 790 length – Crown and Imperial i790 LQB!

KABE's printed Innovation Design exterior makes it possible to create unique design elements that follow the shape of the motorhome body and complement the placement of windows and doors. In 2024, our Royal, Crown and Imperial models are updated with a new expressive design that reinforces the elegant look.



Updated interior in all motorhomes as of 2024!

Modern, stylish and elegant

In a KABE motorhome, you'll experience comfort and quality in every detail, every day. We select all materials with the utmost care, to meet your expectations in terms of both aesthetics as well as durability. The look is timeless. Rest assured that your KABE will always feel modern, stylish and elegant.

Updated interior in all motorhomes as of 2024!

Van, Novum, Royal, Crown and Imperial feature the brand-new wood laminate Atlas Zeder, in a warm brown tone. The exclusive feeling of our interior is enhanced with a lighter new floor covering and upper cabinets in Cashmere. The new cabinets and doors in Van are called Grau.

The updated interior shades create an inviting living space that is followed up with a counter top in the modern laminate Light Concrete, in our Novum, Royal and Crown models. Imperial-models include the luxurious counter top Corian Savannah that is also brand new for this year.

Swivel front seats with maximum space in between, result in flexible use. From drive mode to relax mode around the dining table in just a few seconds! Our Mercedes front seats feature KABE custom upholstery design. KABE Crown and Imperial are equipped with exclusive driver and passenger front seats with integrated seat belts.

Every motorhome has a sound-insulating fitted ceiling that effectively prevents interference from both inside and outside noise.

The lighting in your home is an important factor and it is equally valuable in your motorhome. The inside entrance light, the handle in the inside entry area and lights along the steps, all turn on when you unlock the door. A smart and practical solution for your safety. Some other details worth mentioning are the indirect lighting by upper cabinets, wardrobe lights, storage area lights and a dimmer for the front ceiling light.

In the front window of our Crown and Imperial models, an electric privacy shade is included, to create that cosy and private motorhome you desire when evening darkness falls.



FABRIC



ONTARIO (dark brown)
Novum, Royal, Crown, Imperial



TULSA (beige)
Novum, Royal, Crown, Imperial



FREMONT (black)
Novum, Royal, Crown, Imperial

LEATHER



HOLLYWOOD (dark grey)
Novum, Royal, Crown (surcharge)
Imperial (standard)



BALTIMORE (beige)
Novum, Royal, Crown (surcharge)
Imperial (standard)



LANCASTER (brown)
Novum, Royal, Crown (surcharge)
Imperial (standard)

ARTIFICIAL LEATHER
35% recycled material

KABE VAN – FABRIC



CHARLOTTE (dark beige)



RIVERSIDE (grey)

2024



Design and upholstery

It is the details and many comfort values, that create the pleasant overall feeling in a KABE. In addition to sitting and sleeping comfortably, we think it is important to offer textiles and upholstery that meet the design, care and durability requirements of modern motorhome families.

This year's collection includes three options in fabric, two in leather and one in artificial leather. Leather or artificial leather is standard in Imperial and optional in Novum, Royal and Crown.

Design, function or environmentally friendly? Why choose?

In 2024, we introduce brand new Lancaster! This collection in artificial leather has a surface made of PU and the back is made from recycled leather that creates an overall real leather feel! The material is soft, resistant to wear and very easy to keep clean. Use lukewarm PH-neutral soapy water and dry with a damp cloth. The launch of this new material is a step further in our work with a focus on sustainability. Lancaster upholstery is stylish and environmentally conscious at the same time!

KABE Van offers two fabric collections that complete the design and look of the vehicle.

Our new Ontario, Tulsa, Fremont, Baltimore and Lancaster collections are complemented with fresh new curtains.

A white Mercedes-Benz Kabe motorhome is parked on a grassy bank next to a lake. The motorhome has "KABE" and "TRAVEL READY" written on its side. The background features a large body of water, a dense forest of evergreen trees, and a person fishing in the distance. The scene is set during the day with soft lighting.

COMFORT

Year round, in any road conditions and directions

The comfortable KABE-life is characterized by convenient travel and maximum relaxation when you arrive with your motorhome. We include every detail in the design of our vehicles. Whether the goal is the journey itself or the destination, the comforts are there and create safety and a sense of home year round. On any road, anytime.

Full-scale culinary delight

Just like at home, the kitchen is an important part of your motorhome and the heart of family life. All KABE kitchens are well-equipped with plenty of storage and a well-thought-out design. We know that fine cooking requires its own space. Smart solutions provide extra work space when you need it most.

Recessed cabinet doors and drawers are included. And our drawers are equipped with soft-close and central locking. There are many exclusive details here, such as a rounded sink with a surface-mounted faucet, pull-out cutting board in carefully selected beech wood and a functional cutlery drawer. Naturally, you can sort your waste with separate bins, just like at home.

It's a kitchen that attracts full-scale dining pleasure, regardless of how many people gather at the table.

Counter top with a 3-burner gas stove is included in all KABE motorhomes, except for KABE Van, which has a 2-burner gas stove. Our three-burner stove's split lid creates a smart, extra work surface. And with a cover for the sink, you quickly have an even larger continuous area. The stylish TecTower refrigerator with its bronze coloured front and freezer compartment is standard in our Crown and Imperial series.

Neonflex thin silicone profile with LED lighting frames the refrigerator on both sides.

The kitchen cabinet doors in Novum, Royal and Crown feature the same beige shade Cashmere as the model's new upper cabinets in living area and bedroom.

NEWS! The new Light Concrete counter top in our Novum, Royal and Crown models and Perla in Van are part of our major KABE interior design update.

Back splash in Latte laminate with Plexiglas on the wall behind the counter top (not for Van), gives an expanded feeling behind stove and sink. At the same time, it's easy to clean.

A new modern kitchen faucet is included in all our models (except for Van).



The Imperial kitchen is not your ordinary motorhome kitchen! The concept of premium taken one step further, to create a kitchen for the true connoisseur. Soft, crème-coloured kitchen cabinet doors in new Sabbia High Gloss and the luxurious kitchen counter top Corian Savannah (above) are included. The models are also equipped with a built-in oven in TecTower. Imperial i910 has a practical adjustable shelf that is suitable for a coffee maker.

NEWS! Our new, modern flexible kitchen faucet (left) is included in all our Imperial models. Easier than ever to use and keep the kitchen clean!



Room for everyone

The living room is the place to relax and socialise. In order to enjoy each other's company, comfortable space is needed for everyone. Or maybe you want to work from home sometimes?

That's why our L-shaped sofas are generously proportioned and equipped with comfortable, ergonomically shaped cushions with high-quality Premium Foam inside (not for Van). You'll always be comfortably seated! All our cushions are equipped with anti-slip material on the underside, to keep them firmly in place (not for Van).

Choose the upholstery collection that suits your taste, from our unique and carefully tested selections. See page 12. In KABE Imperial, luxurious leather upholstery or brand-new artificial leather is always included.

The seating area in your motorhome requires a very different design than that of your sofa at home. For a comfortable and safe drive, we have developed a passenger sofa with seat belts and slide-out function (not for Novum Light and Van). You can easily adjust the angle of both seat- and backrest.

Adjustable armrest is standard in Novum Heavy, Royal, Crown and Imperial and guarantees the best driving comfort even for the passengers. The passenger seats in KABE Novum, Royal, Crown and Imperial have deformation-proof seat belts with integrated three-point belts, Isofix mount and an adjustable head rest. Passengers of all ages can travel safely and comfortably in your KABE.

A vital safety measure is KABE's L-shaped sofa solution with a built-in safety frame, which prevents the passenger from sliding under the belt in the event of a collision.

The clean lines of our high-gloss table are complemented by details such as rounded corners in the sofa and indirect lighting along the underside of the upper cabinets, for a cosy feeling. Smart storage space in the upper cabinets with shelves makes it easy to keep everything in order.

Imperial is equipped with KABE's exclusive Premium Sound System with DAB.

To make your connected life easier, a wireless network router is included in all KABE models. External antenna for the router is available as an option. A wireless charger for your mobile phone is included (not for Royal x780 LB/LGB).

KABE Royal x780 LXL is available with a "face-to-face" sofa option. This sofa solution creates an inviting feeling at the dinner table.

Wake up rested and refreshed

A good night's sleep is important in your motorhome to wake up rested and refreshed, ready for travels and new experiences. We include very comfortable beds and mattresses, often an additional charge from other manufacturers.

You deserve the best!

In KABE, you can choose the bedroom layout that works best for your family's needs. Regardless of which layout you choose, the beds are really comfortable with spring mattresses, thick mattress pads and a base with flexible slats. In our QB models, the bed is raised with a smart built-in storage solution.

If you choose a semi-integrated model in Crossover design, a drop-down loft bed is included above the dining area (not in Novum Light, available as an option for Novum Heavy).

In our fully integrated models, you will find a practical drop-down double loft bed in the front, which provides a large extra sleeping space for temporary overnight guests. Maybe grandchildren or a teenager's friend who comes to visit.

The bed is not just a place to sleep. You may want to curl up with a book or newspaper for a moment to relax. For additional comfort, the headboard is covered in soft padded imitation suede, with a 3D printed look that contributes to the stylish and cosy feeling of your KABE-bedroom. Coordinating bedspreads are always included.

The aluminium bed frame is solid and sturdy (standard in Novum, Royal, Crown and Imperial) and an electrical adjustable headboard can be added (standard Imperial, option for Novum, Royal and Crown).

In addition, you will find details such as soft lighting by the headboard, blackout curtains and sound-insulating walls and ceilings. Sleep well at night and wake up well-rested in the morning.

Night light or not? When you want to turn the night light on or off, the button is exactly where it should be – by the bed. Van, Novum, Royal and Crown have modern reading lights in chrome, and in Imperial the lights are finished in black chrome. Some models feature DuoSpot reading light with three switches. A smart switch with touch-function is standard in all models.



Our bedrooms are furnished with spacious wardrobes and upper cabinets to provide storage for everything your family may need on your trip.

NEWS! The wardrobe doors match the new interior Atlas Zeder, with its warm brown tone.



Bathroom comfort just like home

A shower and toilet is at the top of the list for many people, in order to make everyday life in the motorhome as comfortable as possible. Would you like a large and spacious bathroom all the way in the back of the motorhome? Or do you prefer a separate shower and toilet? In the second option, you can section off the entire bedroom and bathroom space from the living room by opening the doors on both sides all the way. A completely private area, where you can get ready in the morning. We offer many flexible options, so that you can choose the solution and bathroom floor plan that's right for you and your family.

Everything to make you feel at home.

The well-thought-out details and the stylish design that characterizes your entire KABE motorhome, continue into the bathroom. In Novum, Royal, Crown and Imperial, the colour theme from the rest of the interior is completed with details in Atlas Zeder.

Exclusive handles and hangers, as well as a lock for the bathroom door add additional design details to your KABE bathroom. New bathroom counter top in the durable laminate Light Concrete is a contemporary touch and the material can also be found on the back wall and on the shower wall in our T-models and Royal x880 LQB.

Neonflex thin silicone profile with LED lighting is an added modern feature in our T-bathrooms and in Royal x880 LQB.

All KABE models include a swivel flush toilet with external emptying. In the Imperial series, a ceramic bowl is included. Cinderella incinerator toilet is available as an option for specific layouts (except for Novum). Heated towel racks are available as an option for Novum Royal, Crown and Imperial.

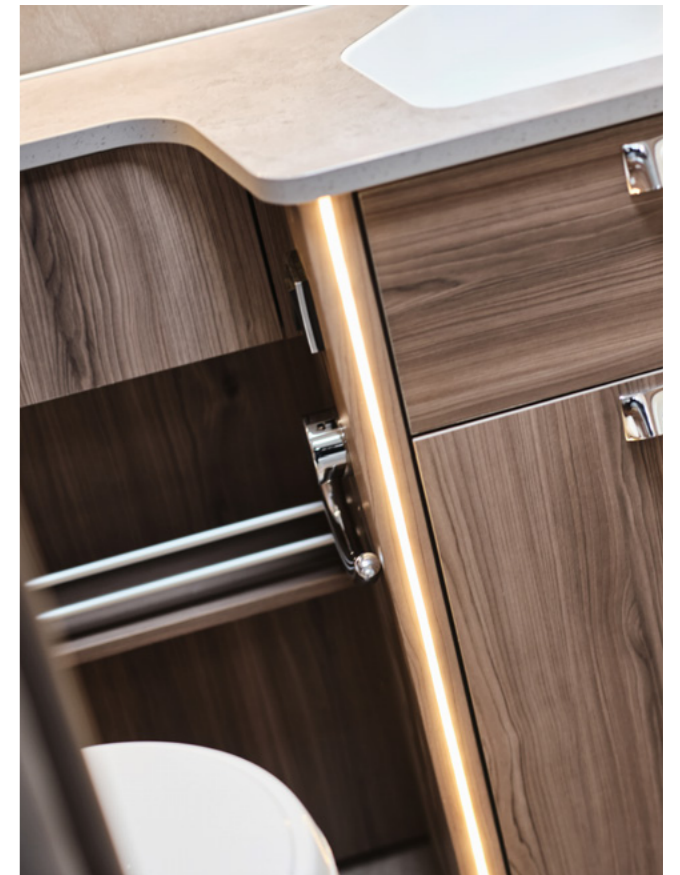

Smart technology for an even better KABE-life

With KABE Smart D control panel – winner of the **European Innovation Award** – you can manage many of the motorhome's functions. The panel is designed with a focus on user-friendliness and has an easy-to-understand touch-screen display. You can monitor freshwater level, wastewater level and battery voltage. You can control lighting, AC, boiler and temperature as well as the drop-down loft bed and some other options. The system has several alarm functions that remind you when it's time for service or if a fuse has blown. Everything conveniently featured in one screen. Included in all motorhomes.

Which language do you want to navigate your KABE Smart D-panel with? You can easily select the language of choice, just like your smartphone.

KABE Smart D Remote makes it possible to remotely manage the motorhome's control panel via an app, wherever you are. For example, you can start the AC on the way home from the beach or turn up the heat and fix a welcoming light before the last ride on the ski slope! KABE Smart D Remote is built with a 4G router with internal antenna and a mobile modem (external antenna is available as an option). In addition to controlling heating, lighting and keep track of the motorhome's functions and alarms via the phone, you also have access to a wireless internet connection on your trip. KABE Smart D Remote* is available as an option for all models.

KABE Smart Level – Winner of the European Innovation Award (EIA) in the Vehicle Equipment category 2023.

KABE Smart Level keeps track of your gas level (with use of one gas bottle, not for composite bottles), tyre pressure and the vehicle's inclination when parked. The panel shows the gas level, you don't have to worry about unexpectedly running out during your trip. Tyre pressure sensor helps you with the right air pressure in the tyres, so that your trip is extra safe and fuel efficient. KABE Smart Level also includes a level indicator that shows the inclination of the vehicle when you park. Important for both your well-being and the functionality of your motorhome.

KABE Smart Level is standard in Imperial and available as an option for Novum, Royal and Crown.



* With your purchase of KABE Smart D Remote, a 36 month subscription is included. After 36 months, you will pay a yearly fee for the use of the app. A separate mobile data subscription is needed as well.



The home page shows all the controls for lighting and digital dimmer sliders. It also displays the temperature, both outside and inside, and the current time.



Current status information about freshwater level, wastewater level and battery voltage is shown in a clear way.



All information and controls for heating is displayed on a separate page. It's easy to raise and lower the heat at the touch of a button.

QUALITY

More than 65 years of know-how and experience

KABE motorhomes are designed for the Scandinavian climate as well as the roads in southern Europe. All models are manufactured in our own factory in Tenhult, Småland, which today is one of Europe's most modern. We have a passionate team of developers, designers and installers who manage more than 65 years of know-how and experience. Our promise is to always offer the market's highest quality within each price segment.



How we build

Your KABE is easily recognizable with its exterior design and colour scheme. Behind the elegant exterior you will find a long list of unique construction and systems that have been developed to effectively interact with each other.

It is the whole that creates KABE's high quality and standard. With some essential parts in the form of an adapted chassis for safe driving, a sturdy and waterproof body and an elaborate system for heating, insulation and ventilation.

It's all about the details and in KABE, you will find lots of smart and sustainable solutions that contribute to the quality of the final motorhome. Many of these details and solutions are things you won't find from other manufacturers.

We simply build motorhomes that we ourselves want to live in. Comfortable, functional and well-equipped, with the best year-round features on the market. To provide you with a relaxing holiday experience on wheels and always feel satisfied and safe in your KABE, wherever you go.



KABE-quality from start to finish

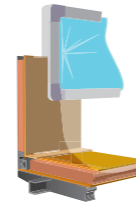

iWall construction

iWall construction deliver maximum stability and an absolutely waterproof body!

- The body is built with the Sandwich principle: outer sheet metal, 36 mm Ecoprime insulation, inner sheet metal and a wall covering that absorbs any condensation.
- Ecoprime is a waterproof material that is manufactured with closed cells, which means that it cannot absorb any moisture.
- Aluminium sheets on both sides of the Ecoprime insulation significantly reduce the impact from temperature differences.

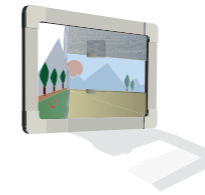

Windows with smart details

KABE's windows include all the features required for comfortable motorhome living.

- The smooth and medium tinted exterior of the window panes protect against heat.
- Integrated screens and blackout curtains are included.
- All windows (except in the kitchen) are continuously open-able.
- KABE's insulation in walls and windows provide warmth in winter and keep the motorhome cool in summer.



...additional equipment

All the extras make for a smooth and relaxing holiday.

- The electric step is automatically retracted when you start the motorhome.
- Remote control central locks for the driver's cab.
- Living area main door is connected to the central lock.
- Vehicle section AC.
- Alarm indicates if the 230 cable is connected when you start the engine.
- USB outlets.



Plastic beams

KABE's unique construction provides a safe motorhome with a long life span and documented good resale value.

- KABE uses plastic beams with integrated air ducts in all moisture-exposed parts of the body.
- Patent is pending for the KABE designed plastic beams.
- Our plastic beams have superior insulation properties.
- The plastic beams also provide better connections between the different parts of the body.

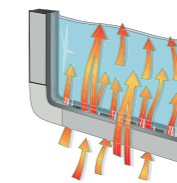

Unique windows and doors

Double-glazed energy efficient windows ensure that your motorhome does not release more heated air than necessary during the cold season and vice versa when it is hot.

- Energy efficient windows with polyurethane frame that creates a seal against the double pane glass provides maximum insulation.
- The window frame is insulated with built-in ventilation, which prevents condensation on the inside of the window when the curtain is drawn at night.
- Living area main door with a window, soft-close and screen door is standard.

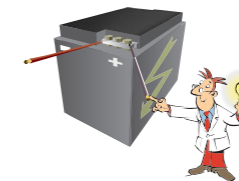

Powerful generator and battery

Our extra powerful electrical system increases the battery life, even during low outdoor temperature.

- Every KABE motorhome is equipped with extra powerful generator and batteries.



Sealed roof joints

The transition from roof to walls is sealed in several stages.

- First, the joint between roof and wall is carefully sealed with elastic butyl compound.
- In the next step, we overlap the roof sheet with the wall sheet to completely avoid leaks.
- KABE's unique iWall construction provides an unlimited number of attachment points – important for mounting optional equipment.



Prepared for support legs and a tow bar

We leave nothing to chance! Practical details are always included in your KABE.

- All KABE motorhomes are constructed with AL-KO framework extension and can easily be equipped with support legs and a tow bar.

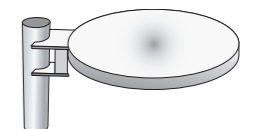

Ready for TV reception

Your KABE is equipped for the best reception.

- Electronic TV antenna for both analogue and digital reception.
- Exterior connection for the TV, cable TV and 12 / 230 V.
- Equipped with TV antenna outlet in three places: in the seating area, bedroom area and the electrical box.
- An alarm indicates if the antenna is raised when you start the motorhome.
- Media cabinet with a fold-out TV wall mount is included in many of our models.

The details make all the difference

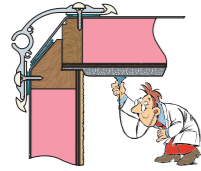

Soft, light reflecting and sound insulating ceiling

The soft inner ceiling creates a cosy indoor environment and reduces the sound from rain and wind.

- KABE is the only manufacturer to feature an exclusive 'soft ceiling' design, with better acoustics inside the motorhome.
- Our 'soft ceiling' absorbs sound and improves the ceiling's insulation properties.

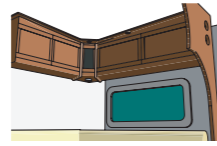

KABE-quality in every interior and all carpentry

Furniture construction and interior are always produced in KABE's own facilities.

- Scandinavian design throughout the interior.
- Upper cabinet doors open with a light touch.
- Kitchen drawers are equipped with soft-close and central locking.
- Robust and durable interior that is optimised for lighter weight.

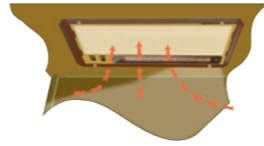

A well-equipped kitchen

In the KABE kitchen you will find equipment and details just like your kitchen at home.

- Built-in, two-speed kitchen fan with lighting.
- Removable grease filter for easy cleaning.
- Stove with electric ignition.
- The market's best refrigerator ventilation system.
- AES fully automatic refrigerator.
- Tec-Tower refrigerator in all integrated models.



Best seating comfort in the market, premium upholstery and textiles

With friends around the table or in front of the TV, you are always comfortably seated.

- Ergonomically designed sofas with durable, recycled Premium Foam cushions.
- Highest quality, wear-resistant upholstery.
- The passenger seat sofa is adjustable with slide-out function (not for Novum Light).
- Six upholstery collections with coordinating curtains to choose from.



Very comfortable beds

Guaranteed good night's sleep and extra comfortable reading in bed.

- Fitted bed slats support your body when resting.
- Spring mattresses and thick mattress pads guarantee a good night's sleep (not in bunk beds).
- Our adjustable headboards provide extra comfortable reading in bed (not Estate).
- Beds with fold-up function and soft-close for efficient cleaning.
- Electric headboard (standard Imperial and LQB-models – available as an option for Novum, Royal and Crown).
- Headboard with cosy lighting.

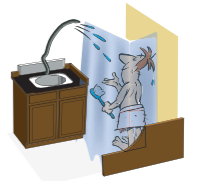

A bathroom with a shower

A shower gives you an increased feeling of freedom.

- Our different models include shower pans, water-proof wall covering, overhead showers and foldout or fixed shower enclosures.
- Several floor plans include a walk-in shower.
- Bathroom door lock.



Drying cabinet

Drying option after an active day outdoors is a practical feature in many of our models.

- Drying cabinet with custom design drip tray to dry your shoes.
- The drying cabinet has a special convector and an adjustable roof valve for maximum heat circulation.



Lots of lighting throughout

Night light provides a guiding light in the motorhome at night.

- Light fixtures with built-in spotlights.
- Indirect lighting above upper cabinets.
- Night light with the switch located by the bed.
- Interior light switch for exterior lights, the lighting in the gas compartment and ski box.
- Lighting in wardrobes and under bed storage.
- Modern switch with a touch-function.



KABE Smart D

With KABE Smart D control unit, you can manage many of the motorhome's functions.

- Easy-to-operate electrical panel with touch-screen display.
- The electrical system detects the battery strength and automatically charges when necessary.
- The system keeps track of water level, temperature and battery voltage.
- KABE Smart D Remote is available as an option for all motorhome models.



KABE Smart Level

Complete control with Smart Level! The KABE Smart D panel includes KABE Smart Level, with three practical functions.

- The panel shows the current gas level (for the use of one gas bottle, not for composite bottles). No need to worry about the gas running out unexpectedly.
- The tire pressure sensor helps you maintain the right air pressure in the tyres.
- A level indicator shows the inclination of the motorhome when it's parked.

Your comfortable KABE life made even a bit simpler with full control of the situation.



...and even more equipment

In our Imperial-series even more equipment is included (some are available as an option for other models).

- Living area AC.
- Central lock exterior access doors.
- Inverter.
- Corian Savannah kitchen counter.
- Premium Sound System with DAB.
- Leather upholstery or artificial leather.
- Solar panel.
- AL-KO HY4 hydraulic support legs.

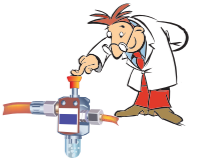

Safe and sound

With safety in mind! The following safety equipment is included in all KABE motorhomes:

- Air bag.
- ABS brakes and three-point seat belts in drivers cab and passenger seats.
- Leak indicator for manual control of the gas system.
- Hose break valve allows the gas to be on while driving.
- Smoke detector located in the bedroom area.
- Ground fault circuit breaker.
- Collision sensor for the gas system.
- Water tank frame, battery frame, reinforced sofa and metal frame in the refrigerator.



Wireless charger. A wireless mobile phone charger is standard in all models (except for Royal x780 LB/LGB).

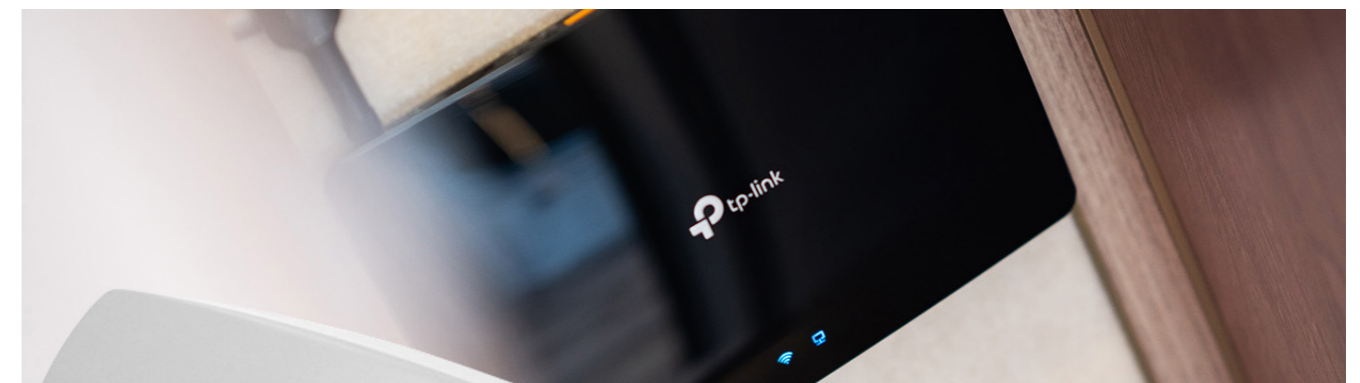

Wireless router. To maximize your media options, a router for wireless internet connection is standard in all models. An external antenna for the router is available as an option.

Unique comfort every day of the year

The European climate makes different demands depending on where you are. We know. It can vary from hot and dry summer, humid and windy autumn, and really cold winter with lots of snow. But you can rest assured that our motorhomes can cope with road conditions, wind and temperature changes without a problem. The technical solutions in our construction and our unique heating and ventilation solution (Smart Climate System) make your KABE the best year-round motorhome in the market.

Our goal is to make your winter travels as comfortable as your summer vacation. Insulation, windows, walls, heating and ventilation are developed to meet the high demands of nature, regardless of the season. In addition, all our motorhomes include a wide range of smart heating systems. Heating convectors that create pleasant heating zones in both the car and living area, heat exchangers (not in Novum Light) and the possibility to heat the driver's cab when the engine is switched off up to 24 hours before departure. These are just a few examples.

In our Imperial models, Alde zone heating is standard, which means you can control the heat in two separate zones, the rear and front of the motorhome. The bathroom area is always comfortably heated on the return loop.

In Crown and Imperial, the front seats include seat heating and cooling as an option. When it's hot out, fans can be activated in the front seat to provide a pleasant coolness and extra comfort on your journey.

NEWS! Dometic FreshJet FJX4 2200. In 2024, we upgrade the interior climate with the latest generation AC from Dometic. The new and efficient FreshJet FJX4 2200 is a ceiling-mounted air conditioning system with quiet and energy-efficient operation and an aerodynamic exterior design. The system can be controlled by remote control, the Dometic Climate app, the touch-panel on the inside of the AC or via the KABE Smart D panel. It also has a night mode with reduced fan speed and Clean Air technology that reduces bacteria and bad odours. Standard in Imperial, available as an option for other models.

With more than 65 years of experience and continuous development, we can proudly say that every KABE motorhome meets the toughest requirements – and more.

Find out more on the next page!



KABE Motorhome heating systems

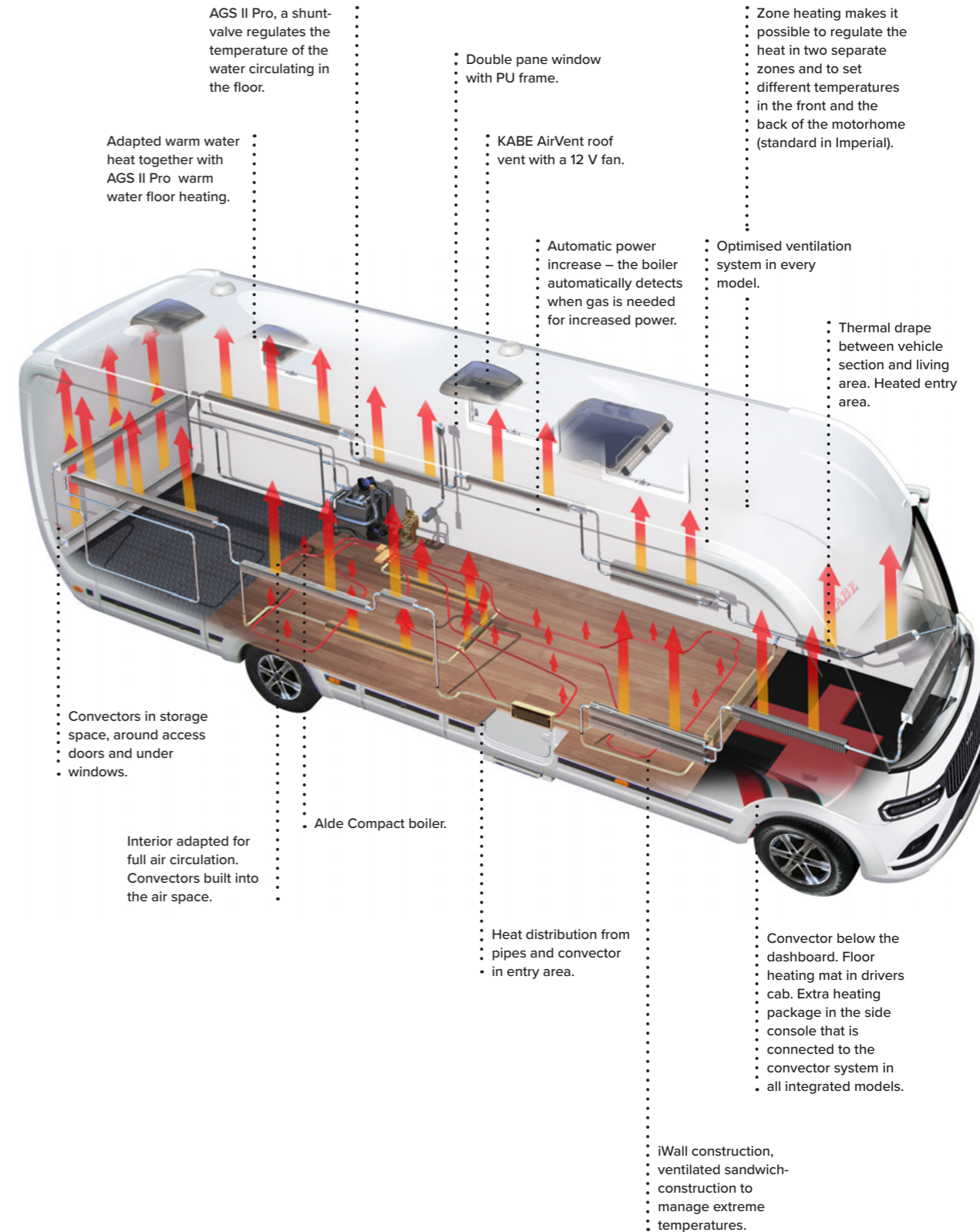

Warm in winter and cool in summer

SMART -CLIMATE+ SYSTEM

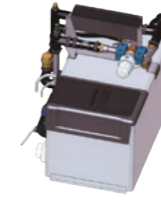
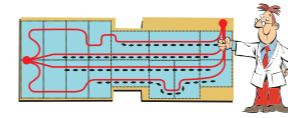
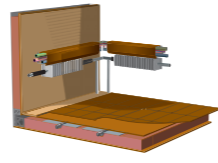

Intelligent heating system

Everything for your comfort! The following is always included in all KABE motorhomes:

- ALDE Compact boiler.
- AGS II Pro warm water floor heating system.
- Densely packed convectors.
- Optimised ventilation system.
- Interior adapted for full air circulation.
- iWall construction.



Inner sheet metal in walls

The sheet behind the wall covering is heated by the indoor temperature and helps prevent condensation.

- KABE sandwich construction consists of outer sheet, ecoprim insulation, inner sheet and inside wall covering.
- The heat from the radiators advance up along the walls.
- The inner sheet in the wall distributes the heat evenly across the entire wall, whereas plywood walls, for example, do not conduct any heat at all.

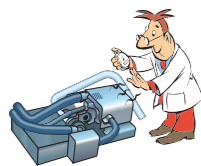

Fuel heater engine circuit

Enjoy your winter trip! With a heated driver's cab, you will always drive comfortably, even when it's extremely cold out.

- KABE motorhomes are equipped with a fuel heater engine circuit (not for Novum Light) to heat the engine circuit.
- The timer allows you to heat the driver's cab in advance, even with the engine turned off, up to 24 hours prior to departure.
- With the help of a heat exchanger, the fuel heater engine circuit can provide heat in the living areas of the motorhome as well (not for Novum Light).

Central heating

The powerful heating system can withstand large temperature differences between outside and inside temperatures.

- Heating boiler ALDE Compact 3030 with a touchscreen display and an electric cartridge of 3 kW, and Propane gas operation with 5,5 kW (5500 W), for a total effect of 8,5 kW.
- The heating system has a 12 V circulation pump, integrated water heater and separate expansion tank.
- A cover is placed around the gas unit for the most efficient hot water effect.

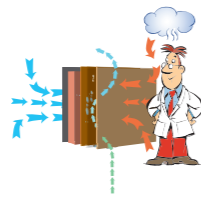

Ventilation in walls and floors

KABE's unique construction easily prevents moisture in the walls (especially winter time) and eliminates the risk of moisture damage.

- KABE is the only manufacturer to include a ventilating inside wall covering that allows the warm air circulating up the walls to pass through.
- Condensation on the floor is caught by the ventilating floor covering along the outer edge and is dried out when you turn on the heat.
- KABE's inside wall covering has a sound insulating effect.



Drivers Cabin Heating System (Crown, Imperial)

Driving comfort and a pleasant home in summer and winter.

- Heat exchanger connects the heat from the engine to the living area.
- Warm water floor heating mat, driver's cab.
- Built-in convectors inside door step (vehicle section).
- Thermal drape for lower part of the dashboard prevents cold air from the front.
- Convector between vehicle section and living area form a heat barrier.
- Extra heating package in side console is connected to the under floor heating system.

Integrated heating system

KABE's warm water heating system heats from the outside and in, so that walls, furniture and interior are heated as well.

- The floor heating system is connected to the convector system, which means that the air circulates throughout the entire motorhome when the heat is turned on.
- The system is powered by both gas and electric.
- KABE is constructed with extra wide convectors under all windows to maintain maximum heat in the air so that any condensation is vented away from the windows.
- Convectors between the driver's cab and living area create a heat barrier between the two areas.

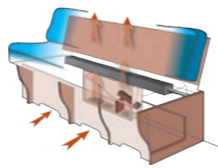

Optimal air flow

Ventilation and air flow are key to maximum living comfort in your motorhome both in winter and summer.

- Our interior is adapted to provide optimal air flow throughout the motorhome, even behind cabinets and sofas.
- The distance between sofas and beds and the angle of the sofa back rest are carefully calculated.



The best heating systems

Extra heat on really cold days.

- With our heat exchanger, you can easily conduct heat from the engine to the living area during your trip.
- All integrated motorhomes include heated double floors, which provide heated storage areas and a better heat in the living area.
- Heating convectors under the dashboard, by the side console and entry steps.
- Double pane glass in doors and side windows (driver's cab).

Superior floor heating comfort

Comfortable and warm floors throughout the entire motorhome!

- Our custom designed patent-pending automatic warm water floor heating system – AGS II – with four loops provides more even heat.
- The heat circulates in aluminium ducts that reach all the way to the entrance door, kitchen cabinets and bathroom.
- Heating plates distribute the heat evenly over the entire floor.



Angled cable ducts

Efficient and energy-smart details.

- Maximum heat is absorbed from the convector and accelerates the airflow past the windows.
- Our unique cable ducts are angled to allow the air to flow freely past the windows.
- Electrical wiring, water and waste water pipes are hidden in the cable ducts.
- In winter, the construction quickly thaws residual water in the pipes.



Load monitor

Helps you conserve electricity.

- The boiler's power consumption of electricity is automatically reduced during particularly heavy loads, for example when several electrical appliances are used at the same time.

AGS II Pro

Adjusts the heat according to your personal needs.

- With AGS II Pro (standard in Gemstone, Royal and Imperial), the floor heating can be operated separately.
- A shunt valve regulates the temperature of the water circulating in the floor.
- To reduce energy consumption, the system is interval controlled. The water circulates in the system during certain pre-set time periods, which reduces the energy consumption in the boiler and protects the battery at the same time.

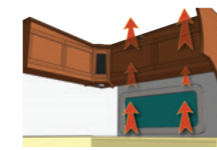

Free airflow

KABE's construction allows the air to flow freely from the floor, under beds and sofas, up to the ceiling, through our ventilated upper cabinets.

- The upper cabinets have built-in air ducts to let the warm air pass freely by the joint between the wall and ceiling and on towards the middle of the motorhome.
- A partition at the rear edge of the cabinets keep the ducts open even when the cabinets are full.

Balanced heat distribution

KABE motorhomes are designed for the best possible heat distribution.

- KABE design allows the warm air to pass freely from the floor, under beds and sofas, and up to the ceiling through our ventilated upper cabinets.
- KABE has the market's best and most even heat distribution in the living area and in other spaces (wardrobes, bathrooms and upper cabinets).

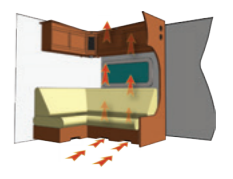

Ventilated sofas and beds

Sofas and beds are carefully spaced out. This creates an air space which enables full air circulation under all beds and bases.

- Sofa back rest and cable trays are angled to accelerate the airflow past the windows.
- The sofa back rest and the space by the bed are heated when warm air is distributed along the wall.

SAFETY

All the time and in any situation

We want you to feel secure in your investment, so that you can fully enjoy your days off. Our motorhomes are built to the highest safety standard and thoroughly tested to optimise use and experience in every location and in all situations.



KABE + Mercedes-Benz + AL-KO

We have great respect for the challenges you face on the road. A few examples are wet, slippery roads and rapid change in temperature. We devote a lot of time and many resources to keep you safe on the road. When you invest in a KABE, we deliver a motorhome that is built in one of Europe's most modern motorhome factories, and developed for an ultimate driving experience that is both safe and comfortable.

It is a well-known fact, that KABE will never compromise on quality. And now we take our efforts even one step further, to achieve the highest standard possible and superior driving characteristics, regardless of climate and road conditions.

In combination with a motorhome base from Mercedes-Benz, your KABE is a vehicle focused on the utmost safety and industry cutting edge technology. With a tailor-made chassis from AL-KO, KABE produces "time-tested" motorhomes with a driver feel similar to that of a passenger car.

In addition, we've made several updates and improved actions to further increase your safety in the event of a collision.



With a focus on safety

We have developed both passive safety systems (collision safety) and equipped our motorhomes with several active safety systems.

PASSIVE SAFETY SYSTEMS (Collision Safety)

Solid body: The driver's cab and living section are joined with a steel structure. The walls and the front of the motorhome are built with the "sandwich" principle to maximize torsional rigidity. The A-column is made with one piece solid construction. The steel structure is joined to the driver's cab with solid steel plates, which provides a strong attachment to the living section. The inner walls are joined to the outer walls with an F-shaped aluminium profile.

Unique construction of the passenger sofa prevents passengers from sliding under the seat belt: The sofa is equipped with a metal frame that hooks into a groove on the underside of the cushions and prevents the cushion from sliding away in the event of a collision.

Steel frame inside the sofa: The belted seats have a reinforced metal frame inside the sofa base to avoid collapse of the sofa in the event of a collision. The metal frame also holds the water tank securely in place. The sofa itself is integrated with the water tank enclosure, which is firmly anchored to the floor. This reduces the risk of the sofa breaking or detaching from the floor in the event of a collision.

Collision proof refrigerator with a steel beam (applies to certain models depending on the location of the refrigerator).

Steel frame around the battery: A new, robust metal frame keeps the living area's battery securely in place, even in the event of a collision.

Foldaway table top: The table can be folded down (or removed in Van) to create more space between the driver's front seat and the passenger sofa to provide a safer ride.

ACTIVE SAFETY SYSTEMS (Accident Prevention Systems)

All of our model-series are built on a base from Mercedes-Benz, with elaborate comfort and superior safety. Nothing is left to chance and a number of technical solutions provide you with a safe and excellent experience on the road.

Every motorhome from KABE includes a Heavy-Duty engine, automatic brakes, high beam assistant, side wind assistant (not for tandem models) attention assist and rain sensor.

Lane departure warning is included in KABE Novum, Royal and Van.

If you add the Comfort Package (available as an option for our Novum and Royal models), road sign assistant, high beam assistant and Thermotronic in the driver's cab are included.

KABE Van includes parking sensors and collision avoidance sensors.

In fully integrated vehicles with a tandem axle, the total weight is 5,500 kg.

Mercedes distance-sensing cruise control Distronic is included in Imperial models and available as an option for Novum, Royal and Crown.

Read more on the next page.

Mercedes feel all the way

In every KABE motorhome, you will find Mercedes' unique 9G-tronic. 9G-tronic is a fully integrated automatic transmission with 9 gears that is adapted to the specific requirements of a motorhome in terms of reduced consumption and emissions.

The latest voice-controlled multimedia system from Mercedes is included – a 10.25-inch MBUX touchscreen with a rear-view camera.



The MBUX multimedia system with a 10.25 inch (26 cm) touchscreen has everything you need as far as infotainment, navigation and communication. It is operated with a high-resolution touchscreen or the touch-controls on the multifunction steering wheel are particularly innovative.

- Intelligent voice control that continuously improves with the help of AI.
- 3D graphics.
- Dynamic navigation can help you avoid traffic and shorten drive time.
- The integration of smart phones via Android Auto, Apple CarPlay or Mirrorlink and Bluetooth with hands free function makes it possible to have a phone conversation while you are driving without distraction.
- Traffic information in real time.

All KABE motorhomes are built on the powerful combination of Mercedes-Benz and AL-KO, with a suspension and shock absorption that is developed and perfected by AL-KO together with Mercedes-Benz.

The chassis are prepared for the addition of HY4 hydraulic support legs (standard in Imperial) tow bar, ClickFix mechanical support legs and load carriers.

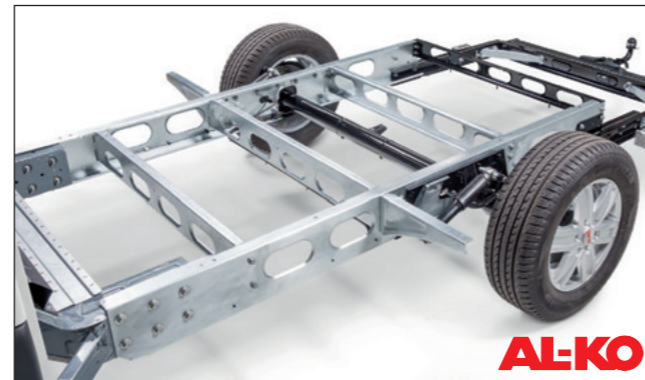

An elegant front exterior, luxurious driver's cab as well as a long list of technical and connected functions are included.

Exterior rearview mirrors, electrically adjustable and heated.

Multifunction steering wheel in leather with touch-controls for MBUX.

Distronic distance control. The active distance assistant Distronic can maintain the distance set by the driver to the vehicle in front. A safe and useful function on the highway or in stop-and-go traffic (standard Imperial, option for Novum, Royal and Crown).

Keyless Start.





CLIMATE CHAMBER

The motorhomes are carefully tested in our climate chamber.



-35 TO +55 DEGREES

Our motorhomes are tested in temperatures from -35 up to +55 degrees.

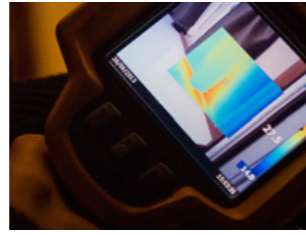

QUALITY

With the help of thermal cameras, we ensure that the construction reaches exactly the quality we strive for.



COMPLETELY WATER PROOF

Advanced technology is used to check that the motorhomes are absolutely waterproof.



OPTIMISED WEIGHT DISTRIBUTION

Scales are used to balance and optimise the weight distribution between axles.



TOWING CAPACITY

Measuring equipment is used to check towing capacity.



DURABILITY

Pressure is used to test the strength of the vehicles.



AIRFLOW

Airflows are carefully checked with smoke.



VENTILATION

Correct ventilation is vital and carefully tested.



GAS SYSTEM

The gas system is pressure tested.



ELECTRICAL SYSTEM

Electrical systems and other important functions are carefully checked before our motorhomes can leave the factory.



DRIVING DURABILITY TEST

Durability tests are performed and simulated with equipment corresponding to 10,000 km of normal driving.



RAIN CHAMBER

In the rain chamber, the motorhomes are tested with a high pressure sprayer.

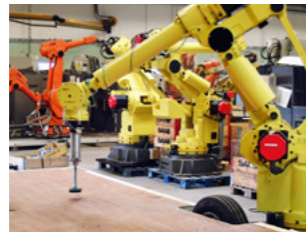

BODY ENDURANCE TEST

Endurance tests are performed on every part of the body.



MANUFACTURING

We use state-of-the-art technology to manufacture our motorhomes.

Built for the toughest tests

Nothing in a KABE is a coincidence. Everywhere you will find well-thought-out design combined with the highest quality in construction and materials.

To get there, we carry out extensive tests down to the smallest detail and function. Among other things, we have a climate chamber where the motorhome is tested to withstand temperature differences of as much as 90 degrees. With our advanced technology, we check that the motorhome is absolutely waterproof.

We also check endurance, durability, airflow, electrical systems and much more. It is a matter of KABE quality and safety that stand up to the tough tests.



10 strong reasons to choose KABE

YEAR-ROUND COMFORT

KABE motorhomes are designed for many different climates, to keep you equally comfortable in the middle of winter as on warm summer days. There are no shortcuts when it comes to insulation, ventilation and heating. For maximum stability and complete moisture control, the body is built with KABE's own iWall system. All models are equipped with the Aide 3030 boiler and warm water heating is standard. Many of the important year-round features are built into the design and may not be visible when you step into the motorhome for the first time. But you will definitely notice the difference when get to know your KABE.

QUALITY

A motorhome from KABE maintains the highest quality down to the smallest detail, and the models are developed from scratch in KABE's own development centre in Tenhult, Småland. KABE works continuously with product development and each new model year is characterized by several interesting innovations. We constantly design and test new solutions in our own development centre and every single motorhome is built in our own factory, which is one of Europe's most modern. We have skilled employees, our own electricians, a carpentry shop and a modern machine department. And our subcontractors are among Europe's leaders in their various fields.

RESALE VALUE

No matter which model you choose, you can be sure your KABE represents the best quality in the market and every price segment. Much of what is standard in a KABE, you have to pay extra for from other manufacturers. It is a matter of quality and function that lasts. You can feel confident that the value of your KABE will hold up well in the future.



TECHNOLOGY

Your new KABE always includes cutting edge technology and it is one of the most well-equipped motorhomes in the market. At KABE, we think ahead and put lots of time and effort into preparing for future challenges with new solutions and technology development. In recent years, we have received several prestigious awards for our innovations, including ventilation and heat recovery. We do everything possible for the most comfortable experience on the road. So, before you start comparing prices – find out what is actually included in your KABE.

DESIGN

Our modern and spacious interior in light colours and materials, is truly Scandinavian design at it's best. You will find well-thought-out details such as recessed cabinet doors, rounded corners and ergonomically designed seat cushions. All materials are made with high quality and the result is that special KABE feeling, where superior design and function always go hand in hand. The exterior is characterized by timeless, elegant lines and graphics that give each KABE its distinctive character.

FUNCTIONALITY

With more than 65 years of experience, KABE develops and builds motorhomes for active, year-round use. Your KABE includes many smart solutions for a KABE lifestyle that is as convenient and relaxing as you like. Some examples are the practical ski storage with lighting, central locks for kitchen drawers or a USB outlet that is placed exactly where you need it.

CLIMATE AND ENVIRONMENT

At KABE, environmental issues are top priority and we are committed all the way – from material selection and production technology to energy values and emission levels. We want to lead the development towards an even more climate- and environmentally adapted motorhome industry. Naturally, we stand behind UN's global goals for sustainable development, good working conditions, increased diversity and equality, and to maintain a high standard in business ethics.

SAFETY

When you buy a KABE you invest in safety. We want you to feel secure in your investment and fully enjoy the days in your motorhome. Our dealers include a 7-year warranty on water infiltration with all new models. Your safety on the road is extremely important to us, and our motorhomes are equipped with many active safety systems. Your KABE also includes many carefully developed passive safety systems to protect you in an accident. A few examples are a solid body and robust construction as well as steel frames around batteries and water tanks to prevent them from moving in a collision.

AUTHORISED DEALERS

KABE has a wide network of authorised dealers and service stations, not only throughout Scandinavia, but in several European countries as well. They provide expert advice and help you with financing and insurance for your KABE. And once you are on the road, we have more than 100 authorised service stations in northern Europe. You will always find professional help, should you need it. Many have worked with us for decades. You are in safe hands!

PLENTY OF OPTIONS

There is a KABE for everyone. It's just a matter of figuring out which size, model, equipment and price range is right for you and your family. When you find your favourite model, you can select your optimal floor plan with KABE's Flexline System. There are many options and great flexibility. With our online product configuration system, building your KABE is easy. Choose "Build your KABE" on our home page www.kabe.se/en, or visit one of our dealers.

2024 MODEL PROGRAM

Find your favourite!

We have developed five model series to satisfy the different needs among our KABE owners, each with unique features. No matter which motorhome you choose, you can be sure that KABE year-round comfort, high quality, safety and lots of smart solutions are included. KABE motorhomes are always among the most well-equipped in the market in each price segment.



KABE Van

Smart and carefully planned design with carefree and flexible mobile living in mind. KABE Van is optimised and compact in size, without compromising on KABE's high standard and Mercedes-Benz's many added values. The Van is 6.97 metres long and can be ordered with twin wheels, which gives a permissible load weight of 7 tons. Perfect if you want to tow a horse trailer, heavy work equipment or a boat.

Page 56

KABE Novum

Our Mercedes-built KABE Novum with a chassis from AL-KO, is a flexible semi-integrated motorhome with crossover design. It's the perfect option for anyone who wants a complete camping vehicle with full KABE standard and a total weight of 3.5 tons (Light) – and without any special drivers license requirements! KABE Novum is 7.50 meters long. The model is also offered with a weight of 4.5 tons (Heavy) as an option. Novum Heavy is prepared for a comfortable drop-down loft bed above the dining area (available as an option).

KABE Novum includes KABE's high quality throughout, and you will find that many solutions are included from us but often an additional cost from other manufacturers.

Page 64



KABE Royal

Semi-integrated KABE Royal is developed with high quality and great flexibility for your driving pleasure. The vehicle is 2.50 metres wide and equipped with an extra drop-down loft bed. Royal is built on a Mercedes-Benz Sprinter base with a chassis from AL-KO. 170 HP engine, 9-speed automatic transmission, Heavy-Duty, leather steering wheel, automatic brake, MBUX 10.25" touchscreen and attention assist are some examples of what is included. A motorhome for those with high demands on equipment and comfort. The model is available in lengths 780 and 880.

Page 70

KABE Crown

KABE Crown is a fully integrated premium series with top-notch design and a standard equipment list far beyond the ordinary. Crown is built for those who want the very best, but at the same time a motorhome that is not the absolute largest. The model is characterized by well-thought-out comfort and intelligent functionality throughout. Our Crown models are built on a base from Mercedes-Benz with all the latest technology and a custom chassis from AL-KO in lengths 760, 790, 810 and 860.

Page 78



KABE Imperial

It doesn't get better than this! From design, quality and comfort to driving characteristics. Imperial is KABE's real frontrunner, with extra-large and luxurious models that provide exceptionally comfortable accommodation. All Imperial models are built on a Mercedes-Benz base with a specially designed AL-KO chassis – both visible on the outside and experienced on the road. The motorhome is surprisingly similar to a passenger car as far as comfort and safety and it is loaded with many smart functions.

KABE Imperial is motorhome-living at a completely different level. Choose between lengths 790, 810, 860 and 910.

Page 86

KABE FLEXIBILITY

Your personal floor plan

Just like when you buy a permanent home, everyone has unique needs and preferences of the floor plan and the look of the motorhome. We are all simply different. That's why KABE offers a wide range of different layouts to make it possible to build a motorhome that works best for your personal requirements.



Floor plan: QB, LQB

A large double bed, centered in the back of the motorhome.

L= L-shaped kitchen



Floor plan: LB

Two single beds in the rear of the motorhome. Toilet and shower are located along one side, in the middle of the motorhome.

L= L-shaped kitchen



Floor plan: GB, LGB

The same floor plan solution as LB, but with raised beds to accommodate a large storage space underneath.

L= L-shaped kitchen

	CROSSOVER		INTEGRATED	
	Single axle	Tandem	Single axle	Tandem
NOVUM MERCEDES-BENZ				
Travel Master Novum 750	LXL, LGB, T			
ROYAL MERCEDES-BENZ				
Travel Master Royal 780	LXL, LB, LGB, LT, LQB			
Travel Master Royal 880		LT, LQB		
CROWN MERCEDES-BENZ				
Travel Master Crown i760			LXL, LGB, LT	
Travel Master Crown i790				LQB
Travel Master Crown i810				LGB, LT, LQB
Travel Master Crown i860				LGB, LQB
IMPERIAL MERCEDES-BENZ				
Travel Master Imperial i790				LQB
Travel Master Imperial i810				LGB, LT, LQB
Travel Master Imperial i860				LGB, LQB
Travel Master Imperial i910				GB, T, QB



Floor plan: T, LT

Two single beds are located in the middle of the motorhome. Bathroom with a walk-in shower spans the entire width of the rear of the motorhome.

L= L-shaped kitchen

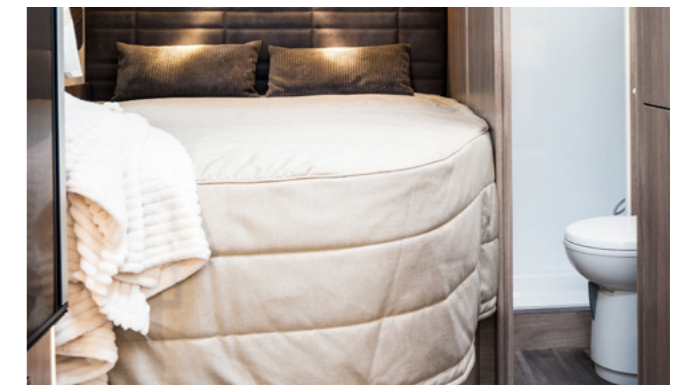

Floor plan: LXL

In the back of the motorhome, you will find a double bed on one side and bathroom with a shower on the other side.

L= L-shaped kitchen

2024 standard equipment

	TM Novum n750 Light	TM Novum n750 Heavy	TM Royal x780	TM Royal x880	TM Van 690	TM Crown 1760	TM Crown 1790	TM Crown i810	TM Crown i860	TM Imperial 1790	TM Imperial i810	TM Imperial i860	TM Imperial i910
ENGINE / CHASSIS													
Anti-lock braking system (ABS)	✓	✓	✓	✓	✓	✓	✓	✓	✓	✓	✓	✓	✓
Tempmatic in the car section	✓	✓	✓	✓									
Thermotronic (option for Novum, Royal – Comfort Package)					✓	✓	✓	✓	✓	✓	✓	✓	✓
Driver air bag	✓	✓	✓	✓	✓	✓	✓	✓	✓	✓	✓	✓	✓
Passenger air bag	✓	✓	✓	✓	✓	✓	✓	✓	✓	✓	✓	✓	✓
16" aluminium rims (option for Novum, Royal – Design Package, n/a for 5-ton Van)					✓	✓	✓	✓	✓	✓	✓	✓	✓
Aluminium exterior body, Innovation Design	✓	✓	✓	✓		✓	✓	✓	✓	✓	✓	✓	✓
Attention Assist	✓	✓	✓	✓	✓	✓	✓	✓	✓	✓	✓	✓	✓
Auto-brakes	✓	✓	✓	✓	✓	✓	✓	✓	✓	✓	✓	✓	✓
Automatic dimming for high beams (option for Novum, Royal – Comfort Package)					✓								
4210 mm wheelbase								✓			✓		
4400 mm wheelbase	✓	✓											
4325 mm wheelbase					✓								
4500 mm wheelbase						✓			✓				✓
4700 mm wheelbase				✓									
4800 mm wheelbase			✓										✓
AGM 92 Ah battery capacity	✓	✓	✓	✓	✓	✓	✓	✓	✓	✓	✓	✓	✓
65-litre (diesel) fuel tank	✓												
90-litre (diesel) fuel tank		✓	✓	✓	✓	✓	✓	✓	✓	✓	✓	✓	✓
3500 kg AL-KO chassis	✓												
4500 kg AL-KO chassis		✓	✓		✓								
5200 kg AL-KO chassis				✓									
5500 kg AL-KO chassis							✓	✓	✓	✓	✓	✓	✓
MB Sprinter A3 chassis with Super high roof					✓								
Fog lights						✓	✓	✓	✓	✓	✓	✓	✓
DISTRONIC (adaptive cruise control – keeps the distance to the vehicle in front)										✓	✓	✓	✓
Daytime running lights (DRL)	✓	✓	✓	✓	✓	✓	✓	✓	✓	✓	✓	✓	✓
Electric parking brake (n/a for 5-ton Van)	✓	✓	✓	✓	✓	✓	✓	✓	✓	✓	✓	✓	✓
Power windows	✓	✓	✓	✓	✓	✓	✓	✓	✓	✓	✓	✓	✓
Electronic stability programme (ESP)	✓	✓	✓	✓	✓	✓	✓	✓	✓	✓	✓	✓	✓
Cruise control	✓	✓	✓	✓	✓	✓	✓	✓	✓	✓	✓	✓	✓
Headlight assistant	✓	✓	✓	✓	✓	✓	✓	✓	✓	✓	✓	✓	✓
Driver / passenger seats with double armrests	✓	✓	✓	✓	✓	✓	✓	✓	✓	✓	✓	✓	✓
Driver / passenger seats with height adjustment	✓	✓	✓	✓	✓	✓	✓	✓	✓	✓	✓	✓	✓
Driver / passenger seats with swivel base	✓	✓	✓	✓	✓	✓	✓	✓	✓	✓	✓	✓	✓
Reinforced tyres	✓	✓	✓	✓		✓	✓	✓	✓	✓	✓	✓	✓
220 A generator	✓	✓	✓	✓		✓	✓	✓	✓	✓	✓	✓	✓
250 A generator					✓								
Upper shelf in the driver's cab		✓	✓	✓	✓	✓	✓	✓	✓	✓	✓	✓	✓
Heavy Duty Engine	✓	✓	✓	✓	✓	✓	✓	✓	✓	✓	✓	✓	✓
Wheel caps	✓	✓	✓	✓									
Controls on steering wheel	✓	✓	✓	✓	✓	✓	✓	✓	✓	✓	✓	✓	✓
Covered dashboard						✓	✓	✓	✓	✓	✓	✓	✓

2024 standard equipment

	TM Novum n750 Light	TM Novum n750 Heavy	TM Royal x780	TM Royal x880	TM Van 690	TM Crown 1760	TM Crown 1790	TM Crown i810	TM Crown i860	TM Imperial 1790	TM Imperial i810	TM Imperial i860	TM Imperial i910
Front grill with chrome decor (option for Novum, Royal – Design Package)					✓								
Lacquered front bumpers	✓	✓	✓	✓	✓	✓	✓	✓	✓	✓	✓	✓	✓
Lane departure warning	✓	✓	✓	✓	✓								
LED lights low / high beams (option for Novum, Royal – Design Package)					✓	✓	✓	✓	✓	✓	✓	✓	✓
Leather steering wheel and gear shift	✓	✓	✓	✓	✓	✓	✓	✓	✓	✓	✓	✓	✓
170 HP Mercedes-Benz engine (FWD)	✓	✓	✓	✓		✓	✓	✓	✓	✓	✓	✓	✓
170 HP Mercedes-Benz engine (RWD)					✓								
Cup holder	✓	✓	✓	✓	✓	✓	✓	✓	✓	✓	✓	✓	✓
Parking sensors and collision avoidance sensors					✓								
Particle filter	✓	✓	✓	✓	✓	✓	✓	✓	✓	✓	✓	✓	✓
Rain sensor	✓	✓	✓	✓	✓	✓	✓	✓	✓	✓	✓	✓	✓
Side wind assistant	✓	✓	✓		✓	✓							
Cover for the seat base	✓	✓	✓	✓	✓								
Spacers – wider track width						✓	✓	✓	✓	✓	✓	✓	✓
Tandem				✓			✓	✓	✓	✓	✓	✓	✓
9-speed automatic transmission – 9G-tronic	✓	✓	✓	✓	✓	✓	✓	✓	✓	✓	✓	✓	✓
Extended exterior side mirrors	✓	✓	✓	✓									
Electric exterior side mirrors (adjustable and heated)	✓	✓	✓	✓	✓	✓	✓	✓	✓	✓	✓	✓	✓
CLIMATE / HEATING													
12 V circulation pumps	✓	✓	✓	✓	✓	✓	✓	✓	✓	✓	✓	✓	✓
Living area AC – Fresh Jet FJX4 2200											✓	✓	✓
Alde Compact 3030 central heating	✓	✓	✓	✓	✓	✓	✓	✓	✓	✓	✓	✓	✓
AGS II Pro automatic floor heating system	✓	✓	✓	✓	✓	✓	✓	✓	✓	✓	✓	✓	✓
Fuel heater engine circuit	✓	✓	✓	✓	✓	✓	✓	✓	✓	✓	✓	✓	✓
Double pane windows, vehicle section sides						✓	✓	✓	✓	✓	✓	✓	✓
230 V 3 kW 3-step electric cartridge	✓	✓	✓	✓	✓	✓	✓	✓	✓	✓	✓	✓	✓
Extra heating package (side console) connected to the floor heating system						✓	✓	✓	✓	✓	✓	✓	✓
KABE AirVent	✓	✓	✓	✓	✓	✓	✓	✓	✓	✓	✓	✓	✓
Convectors inside door step	✓	✓	✓	✓	✓	✓	✓	✓	✓	✓	✓	✓	✓
Thermal drape in the lower part of the driver's cab	✓	✓	✓	✓	✓	✓	✓	✓	✓	✓	✓	✓	✓
Water heater	✓	✓	✓	✓	✓	✓	✓	✓	✓	✓	✓	✓	✓
Warm water floor heating in the driver's cab with convectors in the entry		✓	✓	✓	✓	✓	✓	✓	✓	✓	✓	✓	✓
Winter-adapted water system	✓	✓	✓	✓	✓	✓	✓	✓	✓	✓	✓	✓	✓
Heated front seats	✓	✓	✓	✓	✓								
Heating package for passenger seats						✓	✓	✓	✓	✓	✓	✓	✓
Heat exchanger (V VX)	✓	✓	✓	✓	✓	✓	✓	✓	✓	✓	✓	✓	✓
Alde zone heating										✓	✓	✓	✓
EXTERIOR													
12 V / 230 V outlet in the garage	✓	✓	✓	✓	✓	✓	✓	✓	✓	✓	✓	✓	✓
Central lock exterior access doors										✓	✓	✓	✓
Shower outlet in the garage										✓	✓	✓	✓
Ecoprime insulation in walls, floors and ceilings	✓	✓	✓	✓		✓	✓	✓	✓	✓	✓	✓	✓
EPS insulation in walls and ceilings (pellets) Ecoprime insulation in floors					✓								
Remote control central locking (incl. entrance door)	✓	✓	✓	✓	✓	✓	✓	✓	✓	✓	✓	✓	✓
Hydraulic support legs										✓	✓	✓	✓

2024 standard equipment

	TM Novum n750 Light	TM Novum n750 Heavy	TM Royal x780	TM Royal x880	TM Van 690	TM Crown 1760	TM Crown 1790	TM Crown i810	TM Crown i860	TM Imperial 1790	TM Imperial i810	TM Imperial i860	TM Imperial i910
King Size width			✓	✓									
Kitchen window	✓	✓	✓	✓	✓	✓	✓	✓	✓	✓	✓	✓	✓
Screen door	✓	✓	✓	✓	✓	✓	✓	✓	✓	✓	✓	✓	✓
Plastic beams	✓	✓	✓	✓		✓	✓	✓	✓	✓	✓	✓	✓
Sandwich-construction	✓	✓	✓	✓		✓	✓	✓	✓	✓	✓	✓	✓
Skyview	✓	✓	✓	✓									
Sturdy and moisture proof body	✓	✓	✓	✓	✓	✓	✓	✓	✓	✓	✓	✓	✓
Fixed skylight with black-out shade					✓								
Tinted double pane windows – D-Lux grey metallic	✓	✓	✓	✓	✓	✓	✓	✓	✓	✓	✓	✓	✓
Heated pull-out ski box with lighting and side drawers						✓	✓	✓	✓	✓	✓	✓	✓

INTERIOR

Atlas Zeder interior	✓	✓	✓	✓	✓	✓	✓	✓	✓	✓	✓	✓	✓
Aluminium bed frame	✓	✓	✓	✓	✓	✓	✓	✓	✓	✓	✓	✓	✓
Anti-slip material on the underside of cushions	✓	✓	✓	✓		✓	✓	✓	✓	✓	✓	✓	✓
Kitchen counter with 2-burner gas stove					✓								
Kitchen counter with 3-burner gas stove	✓	✓	✓	✓		✓	✓	✓	✓	✓	✓	✓	✓
Adjustable armrest passenger sofa (standard in Novum Heavy)		✓	✓	✓		✓	✓	✓	✓	✓	✓	✓	✓
Waste bin with source sorting	✓	✓	✓	✓	✓	✓	✓	✓	✓	✓	✓	✓	✓
Indirect lighting under kitchen counter	✓	✓	✓	✓	✓	✓	✓	✓	✓	✓	✓	✓	✓
Lighting on the underside of upper cabinets, in the entry area and bedroom area	✓	✓	✓	✓	✓	✓	✓	✓	✓	✓	✓	✓	✓
Wide entrance door – Hartal Evolution (not in Novum 750T)	✓	✓	✓	✓									
Premium entrance door – HartaLux						✓	✓	✓	✓	✓	✓	✓	✓
Sliding door					✓								
Shower with folding walls or walk-in shower (swivel wall in KABE Van)	✓	✓	✓	✓	✓	✓	✓	✓	✓	✓	✓	✓	✓
Shower door in glass (not for T-models)												✓	✓
Electric privacy shade for the windshield						✓	✓	✓	✓	✓	✓	✓	✓
Electric adjustable headboard										✓	✓	✓	✓
Electric emptying of freshwater tank (also manual function)	✓	✓	✓	✓	✓	✓	✓	✓	✓	✓	✓	✓	✓
Electric emptying of wastewater tank (also manual function)	✓	✓	✓	✓	✓	✓	✓	✓	✓	✓	✓	✓	✓
Single handle kitchen and bathroom faucets	✓	✓	✓	✓	✓	✓	✓	✓	✓	✓	✓	✓	✓
Ergonomic seat cushions					✓								
Ergonomic seat cushions with Premium Foam	✓	✓	✓	✓		✓	✓	✓	✓	✓	✓	✓	✓
Exclusive upper cabinet doors	✓	✓	✓	✓	✓	✓	✓	✓	✓	✓	✓	✓	✓
20/83-litre freshwater tank (also for the option face-to-face sofa, Royal x780 LXL)					✓								
20/90-litre freshwater tank	✓	✓	✓	✓									
20/150-litre freshwater tank						✓	✓	✓	✓	✓	✓	✓	✓
Driver and passenger front seats with KABE custom design fixed upholstery	✓	✓	✓	✓	✓	✓	✓	✓	✓	✓	✓	✓	✓
Curtains	✓	✓	✓	✓		✓	✓	✓	✓	✓	✓	✓	✓
Soft-close upper cabinet doors	✓	✓	✓	✓	✓	✓	✓	✓	✓	✓	✓	✓	✓
Gas filter	✓	✓	✓	✓	✓	✓	✓	✓	✓	✓	✓	✓	✓
New floor covering in a lighter shade	✓	✓	✓	✓	✓	✓	✓	✓	✓	✓	✓	✓	✓
Inside door handle (living area entry)	✓	✓	✓	✓		✓	✓	✓	✓	✓	✓	✓	✓
Premium quality carpentry	✓	✓	✓	✓	✓	✓	✓	✓	✓	✓	✓	✓	✓
Built-in oven		✓	✓	✓		✓	✓	✓	✓	✓	✓	✓	✓
Recessed kitchen drawers	✓	✓	✓	✓	✓	✓	✓	✓	✓	✓	✓	✓	✓
Interior with optimal air circulation	✓	✓	✓	✓	✓	✓	✓	✓	✓	✓	✓	✓	✓

2024 standard equipment

	TM Novum n750 Light	TM Novum n750 Heavy	TM Royal x780	TM Royal x880	TM Van 690	TM Crown 1760	TM Crown 1790	TM Crown i810	TM Crown i860	TM Imperial 1790	TM Imperial i810	TM Imperial i860	TM Imperial i910
Compressor refrigerator					✓								
Bronze coloured refrigerator and freezer (a slimmer refrigerator in Novum)	✓	✓	✓	✓									
Bronze coloured TecTower refrigerator and freezer						✓	✓	✓	✓	✓	✓	✓	✓
Motorised kitchen fan with grease filter (kitchen fan with carbon filter in KABE Van)	✓	✓	✓	✓	✓	✓	✓	✓	✓	✓	✓	✓	✓
Sound insulating ceiling	✓	✓	✓	✓	✓	✓	✓	✓	✓	✓	✓	✓	✓
Air space between interior ceiling and exterior roof (for loft bed comfort)			✓	✓									
Medium-tinted windows	✓	✓	✓	✓	✓	✓	✓	✓	✓	✓	✓	✓	✓
Blackout drapes (also vehicle section)	✓	✓	✓	✓	✓	✓	✓	✓	✓	✓	✓	✓	✓
Convertible sofa bed	✓	✓	✓	✓	✓	✓	✓	✓	✓	✓	✓	✓	✓
Electric drop-down double loft bed above the dinette (option for Novum Heavy)			✓	✓		✓	✓	✓	✓	✓	✓	✓	✓
Optimised refrigerator ventilation	✓	✓	✓	✓	✓	✓	✓	✓	✓	✓	✓	✓	✓
Optimised ventilation system	✓	✓	✓	✓	✓	✓	✓	✓	✓	✓	✓	✓	✓
Plexiglas above the kitchen counter	✓	✓	✓	✓		✓	✓	✓	✓	✓	✓	✓	✓
Upper kitchen cabinet doors in Grau					✓								
Upper kitchen cabinet doors in Cashmere	✓	✓	✓	✓		✓	✓	✓	✓				
Upper kitchen cabinet doors in Sabbia High Gloss										✓	✓	✓	✓
Accent pillows	✓	✓	✓	✓	✓	✓	✓	✓	✓	✓	✓	✓	✓
Set of side curtains with lighting	✓	✓	✓	✓		✓	✓	✓	✓	✓	✓	✓	✓
Shoe compartment	✓	✓	✓	✓		✓	✓	✓	✓	✓	✓	✓	✓
Foam mattress					✓								
Slide-out sofa		✓	✓	✓		✓	✓	✓	✓	✓	✓	✓	✓
Soft-close kitchen drawers	✓	✓	✓	✓	✓	✓	✓	✓	✓	✓	✓	✓	✓
Spring mattress and mattress pad (thinner mattress pad in LGB-models and Novum Light)	✓	✓	✓	✓		✓	✓	✓	✓	✓	✓	✓	✓
Stove with electric ignition	✓	✓	✓	✓	✓	✓	✓	✓	✓	✓	✓	✓	✓
Stepless roller blinds and screens in all windows that open	✓	✓	✓	✓	✓	✓	✓	✓	✓	✓	✓	✓	✓
Adjustable rear seats (side- and lengthwise)					✓								
Padded imitation suede headboard with lighting (no lighting in Van)	✓	✓	✓	✓	✓	✓	✓	✓	✓	✓	✓	✓	✓
Bathroom with sink, shower, cabinets and Light Concrete counter top	✓	✓	✓	✓	✓	✓	✓	✓	✓	✓	✓	✓	✓
Wire baskets in wardrobe	✓	✓	✓	✓		✓	✓	✓	✓	✓	✓	✓	✓
Adjustable bed	✓	✓	✓	✓		✓	✓	✓	✓				
Moulding with two hooks above the kitchen counter	✓	✓	✓	✓		✓	✓	✓	✓	✓	✓	✓	✓
Heated wastewater tank, 90-litre (Van 83-litre)	✓	✓	✓	✓	✓	✓	✓	✓	✓	✓	✓	✓	✓
Pull-out storage in double floor						✓	✓	✓	✓	✓	✓	✓	✓
Water-lock for the toilet	✓	✓	✓	✓	✓	✓	✓	✓	✓	✓	✓	✓	✓
Ventilated Mini Heki skylight with screen and blackout shade	✓	✓	✓	✓	✓	✓	✓	✓	✓	✓	✓	✓	✓
Ventilated Heki II skylight with screen and blackout shade						✓	✓	✓	✓	✓	✓	✓	✓
Ventilating wall covering	✓	✓	✓	✓	✓	✓	✓	✓	✓	✓	✓	✓	✓
Fixed swivel, flush toilet with external emptying	✓	✓	✓	✓	✓	✓	✓	✓	✓				
Fixed swivel, flush toilet with a ceramic bowl and external emptying										✓	✓	✓	✓
Gas turntable / pull-out rail					✓	✓	✓	✓	✓	✓	✓	✓	✓
2 fabric collections					✓								
3 fabric collections	✓	✓	✓	✓		✓	✓	✓	✓	✓	✓	✓	✓
2 leather collections and one in artificial leather (additional cost for Novum, Royal, Crown)										✓	✓	✓	✓
Fitted bedspreads	✓	✓	✓	✓	✓	✓	✓	✓	✓	✓	✓	✓	✓
Grau upper cabinet doors					✓								
Cashmere upper cabinet doors	✓	✓	✓	✓		✓	✓	✓	✓	✓	✓	✓	✓

2024 standard equipment

	TM Novum n750 Light	TM Novum n750 Heavy	TM Royal x780	TM Royal x880	TM Van 690	TM Crown 1760	TM Crown 1790	TM Crown i810	TM Crown i860	TM Imperial 1790	TM Imperial i810	TM Imperial i860	TM Imperial i910
BATTERY / CHARGER													
12 V / 230 V loft bed charger			✓	✓		✓	✓	✓	✓	✓	✓	✓	✓
Lithium battery 100 Ah	✓												
AGM 130 Ah battery (Imperial has two)		✓	✓	✓	✓	✓	✓	✓	✓	✓	✓	✓	✓
35 A battery charger	✓	✓	✓	✓	✓	✓	✓	✓	✓	✓	✓	✓	✓
Battery sensor	✓	✓	✓	✓	✓	✓	✓	✓	✓	✓	✓	✓	✓
Power monitor	✓	✓	✓	✓	✓	✓	✓	✓	✓	✓	✓	✓	✓
230 V (16 A) electric control unit	✓	✓	✓	✓	✓	✓	✓	✓	✓	✓	✓	✓	✓
KABE Smart D servicecenter with a touch screen panel that controls all functions	✓	✓	✓	✓	✓	✓	✓	✓	✓	✓	✓	✓	✓
Solar panel, inverter and double batteries										✓	✓	✓	✓
SOUND / VISUAL													
Lighting in under bed storage	✓	✓	✓	✓		✓	✓	✓	✓	✓	✓	✓	✓
Dimmable front ceiling light	✓	✓	✓	✓	✓	✓	✓	✓	✓	✓	✓	✓	✓
TV mount (only in the front in Novum, x780, Van)	✓	✓	✓	✓	✓	✓	✓	✓	✓	✓	✓	✓	✓
Wardrobe lights	✓	✓	✓	✓	✓	✓	✓	✓	✓	✓	✓	✓	✓
Rear speakers	✓	✓	✓	✓	✓	✓	✓	✓	✓	✓	✓	✓	✓
Indirect lighting upper cabinets	✓	✓	✓	✓	✓	✓	✓	✓	✓	✓	✓	✓	✓
Storage space lighting	✓	✓	✓	✓	✓	✓	✓	✓	✓	✓	✓	✓	✓
LED lighting	✓	✓	✓	✓	✓	✓	✓	✓	✓	✓	✓	✓	✓
MBUX (rear view camera included)	✓	✓	✓	✓	✓	✓	✓	✓	✓	✓	✓	✓	✓
Night lights	✓	✓	✓	✓	✓	✓	✓	✓	✓	✓	✓	✓	✓
Premium Sound System with DAB										✓	✓	✓	✓
Router (subscription excluded)	✓	✓	✓	✓	✓	✓	✓	✓	✓	✓	✓	✓	✓
Wireless charger (not in x780LB / x780LGB)	✓	✓	✓	✓	✓	✓	✓	✓	✓	✓	✓	✓	✓
TV antenna with amplifier	✓	✓	✓	✓	✓	✓	✓	✓	✓	✓	✓	✓	✓
USB outlets in the bedroom area	✓	✓	✓	✓	✓	✓	✓	✓	✓	✓	✓	✓	✓
Exterior 230 V / 12 V / TV outlet / inlet for central antenna	✓	✓	✓	✓	✓	✓	✓	✓	✓	✓	✓	✓	✓
ALARM / SAFETY													
Smoke detector	✓	✓	✓	✓	✓	✓	✓	✓	✓	✓	✓	✓	✓
Electric locking lower kitchen cabinets and drawers										✓	✓	✓	✓
Motorhome Assistance	✓	✓	✓	✓	✓	✓	✓	✓	✓	✓	✓	✓	✓
Burglar alarm with perimeter protection – Defa										✓	✓	✓	✓
Ground fault circuit breaker	✓	✓	✓	✓	✓	✓	✓	✓	✓	✓	✓	✓	✓
KABE Smart Level (gas level and tyre pressure sensor, level indicator)										✓	✓	✓	✓
Collision sensor for gas system	✓	✓	✓	✓	✓	✓	✓	✓	✓	✓	✓	✓	✓
Gas leak indicator	✓	✓	✓	✓	✓	✓	✓	✓	✓	✓	✓	✓	✓
Motion sensor for outdoor lighting	✓	✓	✓	✓		✓	✓	✓	✓	✓	✓	✓	✓
Hose break valve for the gas system	✓	✓	✓	✓	✓	✓	✓	✓	✓	✓	✓	✓	✓

KABE will not be held liable for printing errors and typos. KABE reserves the right to design and data updates without prior notice.

Design your perfect KABE

Create your dream KABE in peace and quiet, in front of your computer. With our flexible configuration tool at www.kabe.se/en, you can clearly see all the possibilities and options available. Choose everything from one of our many models and floor plans to details such as upholstery and optional equipment. When you complete the design, you receive a summary of your ultimate motorhome, with price information and contact information for your nearest dealer.

It couldn't be easier!

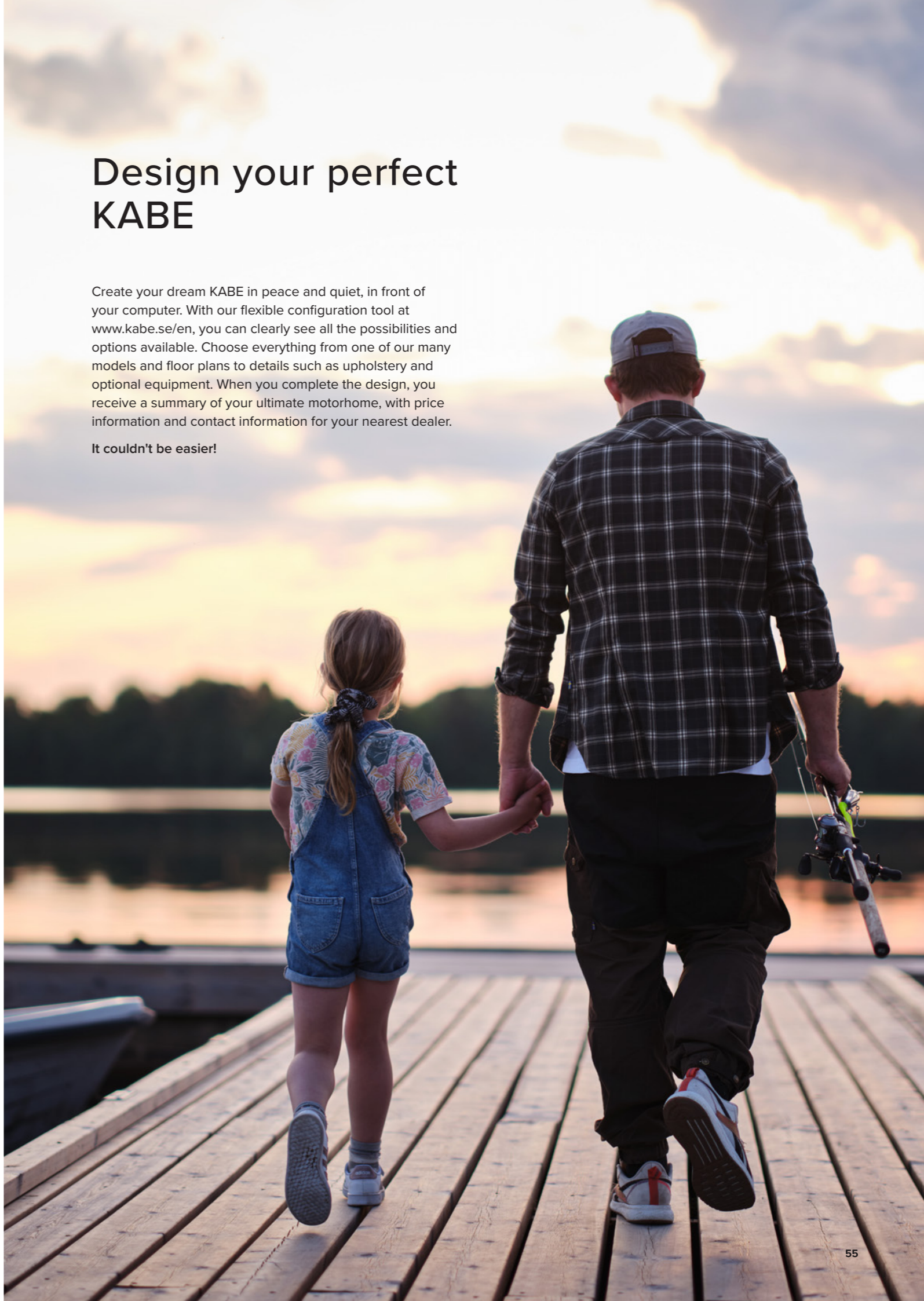

KABE Van

KABE Van is the perfect choice for a carefree and relaxed lifestyle with a focus on adventure. Just like our other motorhomes, the furnished van is built with KABE superior quality. KABE Van is a smart and carefully designed year-round vehicle built on a base from Mercedes-Benz Sprinter with a raised ceiling and a total length of 6,97 metres. KABE Van features rear wheel drive (four wheel drive together with 190 HP engine is available as an option) and Mercedes 4-cylinder 170 HP diesel engine with Euro-6 emission standard. For increased safety, the rear view camera image is displayed on the touchscreen.

KABE Van is delivered in stylish white exterior, Camper-White, with a white front bumper, white electric awning and KABE's unique decal graphics with a 3D-look.

As an option, you can order your KABE Van in elegant blue-grey metallic, Tenorite-Grey, which includes a black electric awning and decal graphics with a 3D-look.



KABE Van standard equipment:

- ▶ A Swedish-built premium van, built on a base from Mercedes-Benz Sprinter
- ▶ 6.97 metres long with a raised roof and an impressive 196 centimetres living area height
- ▶ Mercedes 4-cylinder 170 HP diesel engine with Euro-6 emission standard
- ▶ Rear wheel drive, four wheel drive is available as an option
- ▶ Active safety systems
- ▶ Attention assist
- ▶ Automatic brakes
- ▶ Automatic dimming high beam
- ▶ Electric parking brake
- ▶ Traffic light assistant
- ▶ Lane Departure warning
- ▶ Rain sensor
- ▶ Side Wind assistant
- ▶ Road Sign assistant
- ▶ Connected to digital services
- ▶ Built for year-round use with year-round comfort
- ▶ Fuel heater engine circuit
- ▶ Unique insulation method
- ▶ Warm water floor heating AGS II Pro, double floors and extra convectors
- ▶ Heated barrier by the sliding door and rear doors
- ▶ Heat exchanger
- ▶ KABE's built-in values, comfort and amenities
- ▶ Insulated tanks
- ▶ Panorama skylight
- ▶ Exterior lighting above the sliding door
- ▶ 4 belted seats and sleeps 4
- ▶ Compressor refrigerator
- ▶ Kitchen counter and refrigerator built with a collision frame
- ▶ Award-winning Smart D electrical system
- ▶ Cover for the seat base

See our options on page 62-63.



A grown-up van with unique year-round features

With its elegant exterior and luxurious interior – KABE Van is a compact and optimised vehicle with superior quality that is surprisingly similar to a personal car both as far as comfort and safety. KABE Van is built for year-round use.

Best heating comfort

The body floor space is insulated with 10 mm plastic cells to insulate the space between the body and living area floors. In that area, for example water tanks and water pipes are located and well protected from freezing. In addition, the living area floor is insulated with 25 mm Ecoprim insulation and equipped with our warm water floor heating which provides extremely comfortable temperatures in the living area. Our warm water floor heating system, AGS II Pro, with four loops provides very even heat. The heat circulates in aluminium pipes that reach all the way to the entrance door, kitchen area and bathroom. Heating plates distribute the heat evenly across the entire floor.

Insulation in every wall space

Insulation is sprayed into ceilings, walls, beams and every single space behind the interior walls. This is a new technique, where small glue-coated beads are injected and cured into a durable and solid insulation with a thickness of 35-50 mm. This technology minimizes the risk of cold zones.

Optimised insulation combined with ALDE heating system and excellent ventilation result in KABE's unique heat distribution throughout the living area.

Our interior is adapted to provide optimal air circulation in the entire van, even behind cabinets and sofas.

A warm water convector loop surrounds the entire living area in combination with three thermal barriers to prevent cold drafts.

The thermal barrier consist of convectors located under the floor, between the driver's cab and living area, entrance and living area as well as by the rear doors.

The windows in the living area include insulated frames.

Updates! New aluminium rims!

- ▶ New cover for the seat base
- ▶ Two new upholstery collections
- ▶ Double 150 Ah lithium batteries (option)
- ▶ New AC Dometic Fresh Jet FJX4 2200 (option)
- ▶ New fitted carpet (option)



- ▷ Wood laminate: Atlas Zeder
- ▷ Floor covering: Light
- ▷ Upper cabinet doors front/back: Grau
- ▷ Kitchen cabinet doors: Grau
- ▷ Kitchen counter top: Perla laminate
- ▷ Table: Perla laminate
- ▷ Bathroom counter top: Light Concrete laminate
- ▷ Wardrobe doors (bedroom): Atlas Zeder
- ▷ Fabric collections: Charlotte (dark beige) and Riverside (grey)

KABE Van 2023

In 2024, KABE Van features a new interior with Atlas Zeder wood laminate and its inviting warm brown tone. New lighter floor covering, upper cabinet doors and kitchen cabinet doors in Grau, as well as kitchen counter top and table in the new laminate Perla, complete the modern look.

All furnishings are manufactured in our own carpentry shop and are equipped with a range of smart and practical storage solutions.

The two single beds convert easily into a comfortable double bed. Reading lights in chrome and a smart touch-switch are also included. In the bathroom, the swivel sink make room for the shower.

KABE Van is a completely flexible vehicle that you can easily adapt for maximum storage during travel, and the most possible living space and comfort when you make a stop on the journey.

Front seats from Mercedes feature KABE custom upholstery.

The large panoramic skylight provides plenty of light. Blackout shades and a covered light fixture are included.

In 3rd and 4th passenger seat belts, Isofix is standard.

Exterior lighting above the sliding door is included.

With solar panels, you can fit the AC option.

Twin wheels are available as an option.

The wastewater tank is supplemented with another tank and has the same total volume as the freshwater tank, 83 litres.

ALDE Flow in boiler 3030 Plus is available as an option.





Travel Master Crown Van 690 LB

Smart and carefully thought-out design for carefree and flexible mobile living.

TECHNICAL SPECIFICATION	
Interior length, living area	4307 mm
Interior width	1787 mm
Interior height	1960 mm
Overall length	6967 mm
Overall width (not including side mirrors)	2020 mm
Overall height – rear wheel drive (standard)	3050 mm
Overall height – four wheel drive (option)	3170 mm
Width between wheel housing	1350 mm
Sleeps (incl. dinette)	4
Driver + number of passengers	1 + 3
Bed dimensions, rear	1930 x 1610 mm
Bed dimensions, dinette	1600 x 600 mm

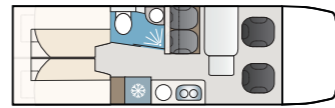

Options for Van

ENGINE / CHASSIS



190 HP engine



Four wheel drive (incl. 190 HP engine)



KABE Van is available in elegant blue-grey metallic exterior, Tenorite-Grey with 3D graphics and decals



Twin wheels 4 x 2 and 4 x 4 5 ton, approx. 850 kg extra load weight, 7 ton train weight

INTERIOR



Floor attachment for child seat



NEW! Fitted carpet

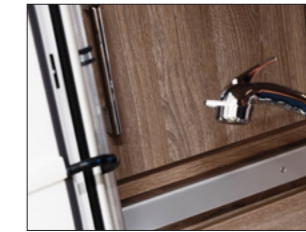

Exterior shower



Exterior gas outlet

EXTERIOR



DISTRONIC / adaptive cruise control 360° rear view camera



Electric awning, Thule 5200 12 V White awning 4,0 m – white van Black awning 4,0 m – blue-grey van



Mercedes tow bar

ALARM / SAFETY



Defa burglar alarm

BATTERY / CHARGER



Gas-switch Duo Control



Extra 130 Ah battery for the living space



NEW! Double 150 Ah lithium batteries



Inverter

CLIMATE / HEATING



ALDE Flow for boiler ALDE 3030 Plus



NEW! Dometic Fresh Jet FJX4 2200 air conditioner for the living area

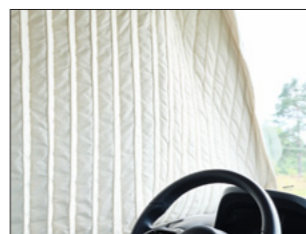

Pleated thermal drape in the front Thermal drape for the rear



Solar panels

SOUND / VISUAL



Smart D Remote

OTHER EQUIPMENT



Water purification system – Alde AquaClear UV-C (Alde Compact 3030 boiler). Efficient water purification that protects the user in a gentle and eco-friendly way. Unwanted viruses and bacteria, pesticides and chemicals are removed. The water is disinfected with UV-C light generated from LEDs. In addition, the water passes through a carbon filter that removes any odour, bad taste and colour.

KABE Novum

We build KABE Novum in Crossover design on a Mercedes-Benz Sprinter base with a chassis from AL-KO in length 750. KABE Novum Light is a light 3.5 ton semi-integrated model that is both affordable and well equipped.

KABE Novum Heavy weighs 4.5 tons and is available as an option. It includes space for a practical drop-down loft bed above the dinette (option for Novum Heavy).

For your interior comfort, we offer three fabric collections to choose from (leather and artificial leather is optional).

CROSSOVER MODEL:



Travel Master Novum 750



Standard equipment in KABE Novum Light:

- ▶ Built on a Mercedes-Benz Sprinter base
- ▶ 3500 kg AL-KO-chassis
- ▶ Mercedes-Benz 170 HP engine
- ▶ Front wheel drive, 9-speed automatic – 9G-tronic
- ▶ Steering wheel and gear shift in leather, controls on the steering wheel
- ▶ Tempmatic in the driver's cab (Thermotronic is available as an option with the Comfort package)
- ▶ Attention assist
- ▶ Automatic brakes
- ▶ Fuel volume 65 litres
- ▶ Electric parking brake
- ▶ Rain sensor
- ▶ Side wind assistant
- ▶ Maximum amount of convectors
- ▶ Drying cabinet with drip tray and ventilation
- ▶ Warm water floor heating with Alde boiler – AGS II Pro
- ▶ Warm water floor heating in the driver's cab with convectors by the step
- ▶ Heated front seats
- ▶ Remote control central lock
- ▶ KABE iWall – solid body built to handle extreme temperatures
- ▶ Mini Heki sunroof with screen and black-out shade
- ▶ Screen door
- ▶ Skyview
- ▶ Insulated double pane windows in the living area – D-Lux
- ▶ 3 fabric collections
- ▶ Aluminium bed frame, spring mattress, 3 cm mattress pad and coordinating bedspread
- ▶ Waste bin with source sorting
- ▶ Ergonomic seat cushions with Premium Foam

- ▶ First-class interior from KABE's own carpentry
- ▶ Hartal Evolution wide entrance door (not in 750 T)
- ▶ Interior adapted for optimal air circulation
- ▶ Faux suede covered headboard
- ▶ Kitchen fan with motor, grease filter and lighting
- ▶ Optimised ventilation system
- ▶ Roller shade and screens in all windows that open
- ▶ Slim fridge with freezer and "soft-close" kitchen drawers
- ▶ Lithium battery 100 Ah and battery sensor
- ▶ Power monitor
- ▶ Award-winning KABE Smart D service centre and control panel
- ▶ Generous amount of LED-lights
- ▶ MBUX including rear view camera
- ▶ Router
- ▶ Smoke detector
- ▶ Ground fault circuit breaker
- ▶ Collision sensor and leak indicator for gas
- ▶ Outside lights with motion sensor
- ▶ Cover for the seat base

The option KABE Novum Heavy also includes:

- ▶ 4500 kg AL-KO-chassis
- ▶ Fuel volume 90 litres
- ▶ Fuel heater engine circuit
- ▶ AGM 130 Ah battery
- ▶ Slide-out passenger sofa with adjustable armrest
- ▶ Built-in oven
- ▶ 6 cm mattress pad
- ▶ Heat exchanger (VVX)
- ▶ Option: electric drop-down loft bed above the dinette

See our options and packages on pages 94-97.

KABE Novum 2024

The interior is characterised by KABE exclusive carpentry made in-house and the new warm brown Atlas Zeder wood laminate. A mild latte coloured laminate in the table and tops, new kitchen counter top in a light concrete shade and light wall and floor coverings complete the look.

Included in KABE Novum, is a well-equipped kitchen with plenty of storage and a practical and well-thought-out design. The Atlas Zeder back wall matches the rest of the interior. Doors and drawers are neatly recessed, and upper cabinet doors in Cashmere provide a nice contrast. Neonflex thin silicone profile with LED lighting on both sides of the refrigerator is an elegant detail.

Rounded kitchen sink with a new sleek surface-mounted faucet set the tone together with the new Light Concrete kitchen counter top. A lid for the sink provides a larger continuous work space and all kitchen drawers are equipped with soft-close.

In Novum's sofa, you will be comfortably seated both on the road and during meals and relaxing time. All of our cushions have Premium Foam inside and anti-slip material on the underside to keep them in place. Slide-out function in the passenger sofa is included in Novum Heavy (not in Novum Light). It's easy to adjust the angle of both the seat and back cushion. Choose between three new fabric collections.



Single or double bed? Choose the floor plan that suits you and your family best. Our Novum models have upholstered headboards with a stylish chrome reading light. You will also find KABE's smart and functional touch-switch, which provides easy control of the indirect lighting, the ceiling light in the bedroom area, as well as the lights in the living area.

For your convenience, a shower is included in all KABE Novum models. The new Light Concrete bathroom counter top has a contemporary look. In our T-models, you will find a matching laminate on the wall behind the mirror and on the shower wall.

ALDE Flow in boiler 3030 Plus is available as an option.

The front seats from Mercedes are finished with KABE custom upholstery. 3rd and 4th passenger seats include seat belts with Isofix and an adjustable headrest provides the absolute best driving comfort.

A forward-facing collapsible 5th passenger seat is available as an option in Novum Heavy LXL-floor plan.

Projected KABE logo in the entry is available as an option with the Design Package.



Updates! New cover for the seat base!

- ▶ New aluminium rims – Design Package option
- ▶ New kitchen faucet
- ▶ Three new fabric collections with new curtains
- ▶ Double 150 Ah lithium batteries (option)
- ▶ New AC Dometic Fresh Jet FJX4 2200 (option)



- ▷ Wood laminate: Atlas Zeder
- ▷ Floor covering: Light
- ▷ Upper cabinet doors front/back: Cashmere
- ▷ Kitchen cabinet doors: Cashmere
- ▷ Driver's cab overhead storage: Atlas Zeder
- ▷ Kitchen counter top and back splash: Light Concrete laminate and Latte with plexiglas on the wall
- ▷ Table and counter top: Latte laminate
- ▷ Entry area counter top: Light Concrete laminate
- ▷ Bathroom counter top: Light Concrete laminate
- ▷ Bathroom cabinet doors: Atlas Zeder
- ▷ Wardrobe doors (bedroom): Atlas Zeder
- ▷ Fabric collections: Ontario (dark brown), Tulsa (beige) and Fremont (black)
- ▷ Leather or artificial leather is available as an option



TECHNICAL SPECIFICATION	
Interior length, living area	4680 mm
Interior width	2238 mm
Interior height	1960 mm
Overall length	7445 mm
Overall width	2390 mm
Overall height	2905 mm
Sleeps (incl. dinette)	2 - 4
Driver + number of passengers	1 + 3
Bed dimensions	1960 x 1320 / 1000 mm

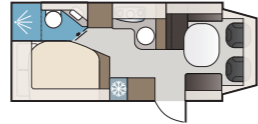

Travel Master Novum 750 LXL Light

KABE Novum 750 LXL is loaded with all the basics for a comfortable holiday. Any time of the year. A double bed and bathroom with a shower are located in the back of the motorhome. In the L-shaped kitchen, you will find many innovative solutions and lots of space to cook!



TECHNICAL SPECIFICATION	
Interior length, living area	4680 mm
Interior width	2238 mm
Interior height	1960 mm
Overall length	7445 mm
Overall width	2390 mm
Overall height	2905 mm
Sleeps (incl. dinette)	2 - 4
Driver + number of passengers	1 + 3
Bed dimensions	1960 x 1320 / 1000 mm
Loft bed dimensions (option)	1908 x 1065 / 830 mm

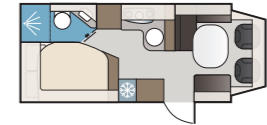

Travel Master Novum 750 LXL Heavy (option)

KABE Novum 750 LXL is loaded with all the basics for a comfortable holiday. Any time of the year. A double bed and bathroom with a shower are located in the back of the motorhome. There is space for a drop-down loft bed above the dining area (available as an option). In the L-shaped kitchen, you will find many innovative solutions and lots of space to cook!



TECHNICAL SPECIFICATION	
Interior length, living area	4680 mm
Interior width	2238 mm
Interior height	1960 mm
Overall length	7445 mm
Overall width	2390 mm
Overall height	2905 mm
Sleeps (incl. dinette)	2 - 4
Driver + number of passengers	1 + 3
Bed dimensions	2 x 1960 x 780 mm

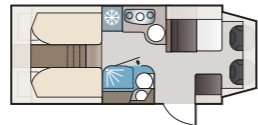

Travel Master Novum 750 LGB Light

KABE Novum 750 LGB can fit lots of luggage in the generous storage space located under the two raised single beds in the back. The area is easy to access from the exterior. A bathroom with a shower is located in the middle and an L-shaped kitchen on the opposite side.



TECHNICAL SPECIFICATION	
Interior length, living area	4680 mm
Interior width	2238 mm
Interior height	1960 mm
Overall length	7445 mm
Overall width	2390 mm
Overall height	2905 mm
Sleeps (incl. dinette)	2 - 4
Driver + number of passengers	1 + 3
Bed dimensions	2 x 1960 x 780 mm
Loft bed dimensions (option)	1908 x 1065 / 830 mm

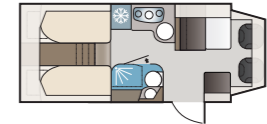

Travel Master Novum 750 LGB Heavy (option)

KABE Novum 750 LGB can fit lots of luggage in the generous storage space located under the two raised single beds in the back. The area is easy to access from the exterior. There is space for a drop-down loft bed above the dining area (available as an option). A bathroom with a shower is located in the middle and an L-shaped kitchen on the opposite side.



TECHNICAL SPECIFICATION	
Interior length, living area	4680 mm
Interior width	2238 mm
Interior height	1960 mm
Overall length	7445 mm
Overall width	2390 mm
Overall height	2905 mm
Sleeps (incl. dinette)	2 - 4
Driver + number of passengers	1 + 3
Bed dimensions	1940 x 780 + 1790 x 780 mm

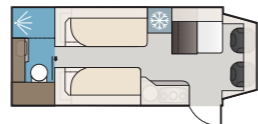

Travel Master Novum 750 T Light

KABE Novum 750 T with two single beds and a large bathroom with a walk-in shower that covers the entire width of the vehicle in the back, creates a motorhome you can enjoy for years! Our comfortable sofa and a well-equipped kitchen completes this floor plan.



TECHNICAL SPECIFICATION	
Interior length, living area	4680 mm
Interior width	2238 mm
Interior height	1960 mm
Overall length	7445 mm
Overall width	2390 mm
Overall height	2905 mm
Sleeps (incl. dinette)	2 - 4
Driver + number of passengers	1 + 3
Bed dimensions	1940 x 780 + 1790 x 780 mm

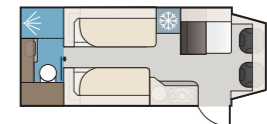

Travel Master Novum 750 T Heavy (option)

KABE Novum 750 T with two single beds and a large bathroom with a walk-in shower that covers the entire width of the vehicle in the back, creates a motorhome you can enjoy for years! Our comfortable sofa and a well-equipped kitchen completes this floor plan.

KABE Royal

In KABE's Royal series, luxury equipment is the standard. A perfect choice for those who want to be at the forefront of technology and are looking for a competent motorhome with lots of user flexibility. Our Royal models with Crossover (includes a drop-down loft bed above the dining area) are available in lengths 780 and 880. The Royal series is built on a Mercedes-Benz Sprinter base and is filled with smart functions that make life easy. The driver and passenger environment is comfortable and well-thought-out, maximised interior space and excellent driving characteristics with an AL-KO tailor-made low frame chassis.

In 2024, the Royal series is updated with new exterior Innovation Design graphics!

CROSSOVER MODELS:



Travel Master Royal x780



Travel Master Royal x880

KABE Royal standard equipment:

(In addition to what's included in KABE Novum on page 65.)

- ▶ 4500 kg AL-KO chassis / 5200 kg AL-KO tandem chassis
- ▶ King Size width
- ▶ Fuel heater engine circuit
- ▶ Electric drop-down loft bed above the dinette
- ▶ Large refrigerator and freezer

See our options and packages on pages 94-97.





Updates! New Innovation design exterior graphics!

- ▶ New aluminium rims – Design Package option
- ▶ New cover for the seat base
- ▶ New kitchen faucet
- ▶ Three new fabric collections with new curtains
- ▶ Double 150 Ah lithium batteries (option)
- ▶ New AC Dometic Fresh Jet FJX4 2200 (option)



- ▷ **Wood laminate:** Atlas Zeder
- ▷ **Floor covering:** Light
- ▷ **Upper cabinet doors front/back:** Cashmere
- ▷ **Kitchen cabinet doors:** Cashmere
- ▷ **Driver's cab overhead storage:** Atlas Zeder
- ▷ **Kitchen counter top and back splash:** Light Concrete laminate and Latte with plexiglas on the wall
- ▷ **Back wall:** Cashmere
- ▷ **Table and counter top:** Latte laminate
- ▷ **Entry area counter top:** Light Concrete laminate
- ▷ **Bathroom counter top:** Light Concrete laminate
- ▷ **Bathroom cabinet doors:** Atlas Zeder
- ▷ **Wardrobe doors (bedroom):** Atlas Zeder
- ▷ **Fabric collections:** Ontario (dark brown), Tulsa (beige) and Fremont (black)
- ▷ Leather or artificial leather is available as an option



KABE Royal 2024

Our motorhomes are designed for practical living that is stylish at the same time. Starting with the new wood laminate Atlas Zeder, and it's inviting warm brown tone, we have adapted the entire interior of our Royal models.

Recessed doors and drawers and the new Light Concrete kitchen counter top with a modern look are included. An interior design that will always feel right. The 3-burner stove has a split cover, which provides valuable extra work space.

Our passenger sofa with an adjustable armrest makes your trip extra enjoyable. For your comfort and safety there is also a slide-out function that makes it easy to adjust the angle of both the seat and backrest. The sofa is designed to prevent you from sliding under the seat belt in the event of a collision.

All our cushions have anti-slip material on the underside to keep them in place.

Choose from three new fabric collections. Leather upholstery or brand new artificial leather is available as an option.

In Royal x780 LXL, you can choose face-to-face sofa (available as an option).

In the entry, a handle to hold onto when you step into the motorhome with built-in lighting is a practical solution.

A wireless charger for your mobile phone is included and placed in the front (not in Royal x780 LB/LGB).

The headboard in soft, padded imitation suede with a printed 3D pattern makes the bedroom extra cosy. The beds

have spring mattresses, thick mattress pads and a base with flexible slats to support you when you lie down. Several models feature an adjustable headboard. Reading lights in chrome and a smart touch-switch are also included.

All Royal models are equipped with extra overnight space in the drop-down loft bed above the dining area (Crossover). Get a good nights sleep and morning time the space is easy to convert to make room around the breakfast table (see page 76-77).

The new Light Concrete bathroom counter top has a contemporary look. In our T-models, you will find a matching laminate on the wall behind the mirror and on the shower wall.

ALDE Flow in boiler 3030 Plus is available as an option.

The front seats from Mercedes are finished with KABE custom design upholstery.

A thermal drape in a stylish grey shade is installed in the lower part of the front cab (standard in all Royal).

3rd and 4th passenger seats feature seat belts with Isofix and an adjustable headrest that provides the absolute best driving comfort for the passengers. Forward-facing collapsible 5th passenger seat is available as an option.

KABE Smart Level is available as an option and includes a gas level sensor, tyre pressure sensor and level indicator that shows the vehicle's inclination when parked.

Distronic is available as an option.



Travel Master Royal x780 LXL

x780 LXL has an inviting and open floor plan with an L-shaped kitchen. Two double beds, one in the rear and a drop-down loft bed in the front, creates efficient space and provides extra space for two overnight guests.

TECHNICAL SPECIFICATION	
Interior length, living area	5190 mm
Interior width	2316 mm
Interior height	1960 mm
Overall length	8060 mm
Overall width	2450 mm
Overall height	2980 mm
Sleeps (incl. dinette)	2 - 6
Driver + number of passengers	1 + 3
Bed dimensions, rear	1960 x 1400 / 1120 mm
Bed dimensions, dinette	2230 x 1030 / 1180 mm
Bed dimensions, loft bed	1980 x 1380 / 1050 mm
Storage opening W/H	690 x 590 mm

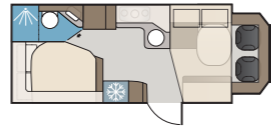

Travel Master Royal x780 LB

With an L-shaped kitchen and spacious seating area, this is a motorhome for two or more, with room for a couple of guests in the drop-down loft bed above the dining area.

TECHNICAL SPECIFICATION	
Interior length, living area	5190 mm
Interior width	2316 mm
Interior height	1960 mm
Overall length	8060 mm
Overall width	2450 mm
Overall height	2980 mm
Sleeps (incl. dinette)	2 - 6
Driver + number of passengers	1 + 3
Bed dimensions, rear	2 x 1940 x 820 mm
Bed dimensions, dinette	2230 x 1380 / 825 mm
Bed dimensions, loft bed	1980 x 1380 / 1050 mm
Storage opening W/H	2 x 690 x 590 mm

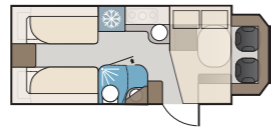

Travel Master Royal x780 LGB

This model can fit everything you need for short and long trips. The floor plan features two single beds with a large storage space located below as well as a functional L-shaped kitchen, dining area for five and a bathroom with waterproof shower walls.

TECHNICAL SPECIFICATION	
Interior length, living area	5190 mm
Interior width	2316 mm
Interior height	1960 mm
Overall length	8060 mm
Overall width	2450 mm
Overall height	2980 mm
Sleeps (incl. dinette)	2 - 6
Driver + number of passengers	1 + 3
Bed dimensions, rear	2 x 1960 x 820 mm
Bed dimensions, dinette	2230 x 1380 / 825 mm
Bed dimensions, loft bed	1980 x 1380 / 1050 mm
Storage opening W/H	690 x 1070 + 690 x 590 mm



Travel Master Royal x780 LT

x780 LT is one of KABE's newer Crossover models. An inviting seating area, comfortable beds and a large bathroom with a walk-in shower are all included.

TECHNICAL SPECIFICATION	
Interior length, living area	5190 mm
Interior width	2316 mm
Interior height	1960 mm
Overall length	8060 mm
Overall width	2450 mm
Overall height	2980 mm
Sleeps (incl. dinette)	2 - 5
Driver + number of passengers	1 + 3
Bed dimensions, rear	1940 x 820 + 1880 x 820 mm
Bed dimensions, dinette	2230 x 1175 / 555 mm
Bed dimensions, loft bed	1980 x 1100 / 845 mm
Storage opening W/H	670 x 1335 mm

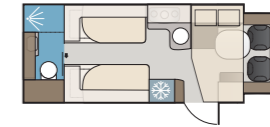

Travel Master Royal x780 LQB

x780 LQB has plenty of space! A large double bed is placed in the back of the motorhome and a drop-down loft bed with room for two is located above the dining area. To make your holiday extra comfortable, this floor plan also features a practical L-shaped kitchen, a dining area for five and a separate toilet and shower.

TECHNICAL SPECIFICATION	
Interior length, living area	5190 mm
Interior width	2316 mm
Interior height	1960 mm
Overall length	8060 mm
Overall width	2450 mm
Overall height	2980 mm
Sleeps (incl. dinette)	2 - 5
Driver + number of passengers	1 + 3
Bed dimensions, rear	1980 x 1520 / 1100 mm
Bed dimensions, dinette	2230 x 1175 / 555 mm
Bed dimensions, loft bed	1980 x 1100 / 845 mm
Storage opening W/H	2 x 690 x 1070 mm

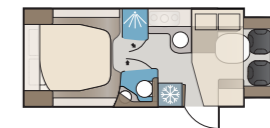

Travel Master Royal x880 LT

x880 LT features a separate bedroom with two single beds and a bathroom that spans the entire width in the rear of the motorhome. Above the dining area, a drop-down loft bed provides additional overnight space for two.

TECHNICAL SPECIFICATION	
Interior length, living area	6215 mm
Interior width	2316 mm
Interior height	1960 mm
Overall length	9060 mm
Overall width	2450 mm
Overall height	2980 mm
Sleeps (incl. dinette)	2 - 6
Driver + number of passengers	1 + 3
Bed dimensions, rear	1940 x 820 + 1900 x 820 mm
Bed dimensions, dinette	2230 x 1380 / 1260 mm
Bed dimensions, loft bed	1980 x 1380 / 1050 mm
Storage opening W/H	670 x 1335 + 660 x 375 mm

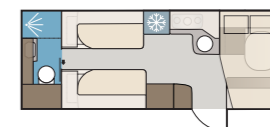



Our Crossover-models feature extra bed space in the electric drop-down loft bed located above the dining area. After a good nights sleep, the area magically converts to a comfortable dining area with lots of space around the breakfast table.



Travel Master Royal x880 LQB

x880 LQB has lots of space for you and your guests. A large double bed is placed in the middle in the back of this model. In addition, an electric drop-down loft bed is located above the dining area with room for two more.

TECHNICAL SPECIFICATION	
Interior length, living area	6215 mm
Interior width	2316 mm
Interior height	1960 mm
Overall length	9060 mm
Overall width	2450 mm
Overall height	2980 mm
Sleeps (incl. dinette)	2 - 6
Driver + number of passengers	1 + 3
Bed dimensions, rear	1980 x 1520 / 1100 mm
Bed dimensions, dinette	2230 x 1380 / 950 mm
Bed dimensions, loft bed	1980 x 1380 / 1050 mm
Storage opening W/H	2 x 690 x 995 mm

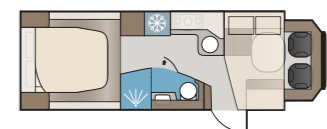

KABE Crown

KABE Crown is built on the exclusive combination of a base from Mercedes-Benz and an AL-KO chassis. It is surprisingly similar to a passenger car, both in terms of comfort and safety. Crown has a design level beyond the ordinary with stylish, exclusive carpentry, a well-equipped and spacious kitchen, extra comfortable beds and plenty of practical storage solutions. With a variety of floor plans you can create the perfect motorhome for you and your family. Crown is loaded with a wide range of smart technology solutions, for your driving comfort and at your destination. In short, KABE Crown is a motorhome that delivers and impresses.

INTEGRATED MODELS:



Travel Master Crown i760



New! Travel Master Crown i790



Travel Master Crown i810



Travel Master Crown i860



Standard equipment in KABE Crown:

(In addition to what's included in KABE Novum and KABE Royal on pages 65 and 70.)

- ▶ 4500 kg AL-KO chassis / 5500 kg AL-KO tandem chassis
- ▶ 16" aluminium rims
- ▶ Fog lights
- ▶ LED high and low beams
- ▶ Double pane glass in the driver's cab
- ▶ Extra heating unit located in the side console and connected to the floor heating system
- ▶ Heated pull-out ski storage with lighting
- ▶ Pull-out storage in the double floor
- ▶ Turntable or a pull-out track for gas tanks
- ▶ Heki II sunroof with screen and black-out shade
- ▶ 20/150 litres freshwater tank
- ▶ Driver and passenger seats with integrated seat belt
- ▶ HartaLux premium entrance door
- ▶ TecTower refrigerator with a freezer and built-in oven
- ▶ Defa burglar alarm with perimeter protection
- ▶ Covered dashboard
- ▶ Spacers – wider track width

See our options on pages 94-97.

Updates! New model: Crown i790 LQB with 790 length!

- ▶ New Innovation Design exterior graphics
- ▶ New aluminium rims
- ▶ New spacers – wider track width
- ▶ New covered dashboard
- ▶ New kitchen faucet
- ▶ Three new fabric collections with new curtains
- ▶ Double 150 Ah lithium batteries (option)
- ▶ New AC Dometic Fresh Jet FJX4 2200 (option)



KABE Crown 2024

KABE Crown is a year-round motorhome with the highest quality technical solutions, comfort and design. Among many other things, the wide HartaLux entrance door is worth mentioning. It provides a convenient entry and lots of light inside. When you unlock the door, the overhead entry light, the handle on the inside of the entry and the lighting along the steps automatically turn on.

Our Crown models feature new Atlas Zeder wood laminate interior and everything else inside is adapted to complement the warm brown shade. All upper cabinet doors are updated with the new shade Cashmere to create a nice contrast, also in the kitchen.

In a KABE Crown, you can be sure to sleep just as well as at home. The headboard is covered in soft, padded imitation suede with a printed 3D pattern. Comfortable mattresses, smart storage, reading lights in chrome and a smart touch-switch are included. All these conveniences allow for many golden hours. The aluminium bed frame is robust and sturdy. As an option, you can add an electrical adjustable headboard.

Smart storage solutions makes it easy to keep your motorhome organised. Cabinets under the loft bed with lighting behind and lighting under the loft bed are some practical details.

Modern reading lights in chrome with smart USB outlets are placed in select areas around the motorhome.

The skylight provides a welcome light that can bring even the most tired person to life.

The L-shaped sofa provides room for many and is included in all our Crown models. Slide-out function with easy to adjust angle in both seat and backrest and an adjustable armrest provides ultimate driving comfort for the passengers. All our cushions have anti-slip material on the underside to keep them in place. Leather upholstery or brand new artificial leather is available as an option.

Our smart sofa construction with a safety frame prevents you from sliding under the belt in the event of a collision – safe and secure!

The front seats from Mercedes are finished with KABE custom upholstery. The option "seat heating and seat cooling" keeps you warm in the winter and cools you in the summer.

In the front window of Crown, an electric privacy shade is included – it couldn't be easier to create that cosy and private motorhome feeling.

In the lower part of the front cab, a stylish grey thermal drape is included in all Crown models.

Seat belts with Isofix standard and adjustable headrest provide comfort and safety for the passengers. Forward-facing collapsible 5th passenger seat is available as an option.

The deep storage space in between the motorhome's double floors are furnished with pull-out bins for even easier packing and storage.

KABE Crown models have a turntable (if there is not a pull-out track) in the gas compartment to facilitates the handling of heavy gas tanks.

150 litre freshwater tank is standard in Crown. ALDE Flow in boiler 3030 Plus is available as an option.

KABE Smart Level is available as an option and includes a gas level sensor, tyre pressure sensor and level indicator that shows the vehicle's inclination when parked.

Distronic is available as an option.



- ▷ **Wood laminate:** Atlas Zeder
- ▷ **Floor covering:** Light
- ▷ **Upper cabinet doors front/back:** Cashmere
- ▷ **Kitchen cabinet doors:** Cashmere
- ▷ **Kitchen counter top and back splash:** Light Concrete laminate and Latte with plexiglas on the wall
- ▷ **Back wall:** Cashmere
- ▷ **Table and counter top:** Latte laminate
- ▷ **Entry area counter top:** Light Concrete laminate
- ▷ **Bathroom counter top:** Light Concrete laminate
- ▷ **Bathroom cabinet doors:** Atlas Zeder
- ▷ **Wardrobe doors (bedroom):** Atlas Zeder
- ▷ **Fabric collections:** Ontario (dark brown), Tulsa (beige) and Fremont (black)
- ▷ Leather or artificial leather is available as an option



Travel Master Crown i760 LXL

This option has lots of space. It can accommodate four people on the road and up to six can stay over! The back of the motorhome features a double bed and a toilet and shower. In addition, a drop-down double loft bed is located in the front and quickly ready at night time.

TECHNICAL SPECIFICATION	
Interior length, living area	5064 mm
Interior width	2180 mm
Interior height	1960 mm
Overall length	7820 mm
Overall width	2329 mm
Overall height	3065 mm
Sleeps (incl. dinette)	2 - 6
Driver + number of passengers	1 + 3
Bed dimensions, rear	1940 x 1280 / 800 mm
Bed dimensions, dinette	2060 x 1175 / 940 mm
Bed dimensions, loft bed	1880 x 1220 mm
Storage opening W/H	700 x 800 mm

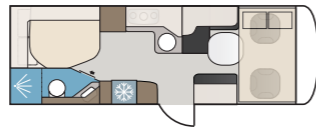

Travel Master Crown i760 LGB

A spacious storage area with easy access through the large exterior door at the rear side of i760 LGB. Inside, the space is located under two raised beds in the back of the motorhome. A perfect choice, when you are travelling with lots of equipment.

TECHNICAL SPECIFICATION	
Interior length, living area	5064 mm
Interior width	2180 mm
Interior height	1960 mm
Overall length	7820 mm
Overall width	2329 mm
Overall height	3065 mm
Sleeps (incl. dinette)	2 - 6
Driver + number of passengers	1 + 3
Bed dimensions, rear	1960 x 780 + 1960 x 700 mm
Bed dimensions, dinette	2060 x 1175 / 555 mm
Bed dimensions, loft bed	1880 x 1220 mm
Storage opening W/H	2 x 760 x 1040 mm

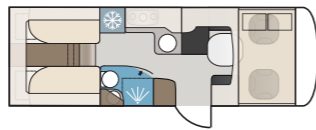

Travel Master Crown i760 T

If a large bathroom is a priority, i760 T is the right model for you! The bathroom spans the entire width of the back of the motorhome and is accessible from the bedroom with two single beds. A drop-down double loft bed, located in the front of the motorhome, is ready to use at night time.

TECHNICAL SPECIFICATION	
Interior length, living area	5064 mm
Interior width	2180 mm
Interior height	1960 mm
Overall length	7820 mm
Overall width	2329 mm
Overall height	3065 mm
Sleeps (incl. dinette)	2 - 4
Driver + number of passengers	1 + 3
Bed dimensions, rear	1940 x 780 + 1840 x 780 mm
Bed dimensions, dinette	-
Bed dimensions, loft bed	1880 x 1220 mm
Storage opening W/H	700 x 800 mm

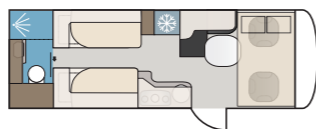

In the front window of Crown, an electric privacy shade is included – it couldn't be easier to create that cosy and private motorhome feeling.



New! Travel Master Crown i790 LQB

A convenient new model with all the extras that make your motorhome-life as smooth and enjoyable as possible. In the back, you will find a large and comfortable queen-size bed. Toilet and shower are located right next to the bedroom, in the middle. A well-equipped L-shaped kitchen and a drop-down double loft bed above the seating area complete this floor plan.

TECHNICAL SPECIFICATION	
Interior length, living area	5164 mm
Interior width	2180 mm
Interior height	1960 mm
Overall length	7920 mm
Overall width	2329 mm
Overall height	3065 mm
Sleeps (incl. dinette)	2 - 5
Driver + number of passengers	1 + 3
Bed dimensions, rear	1995 x 1380 mm
Bed dimensions, dinette	2060 x 1175/584 mm
Bed dimensions, loft bed	1880 x 1220 mm
Storage opening W/H	2 x 760 x 1040 mm

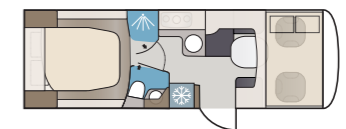



Travel Master Crown i810 LGB

In this motorhome, space is not a problem. A large storage area with plenty of room is easy to access from the exterior. It is located under the raised beds in the back of the motorhome. In addition, the L-shaped kitchen next to the seating area has lots of storage space. This model sleeps a maximum of six.

TECHNICAL SPECIFICATION	
Interior length, living area	5564 mm
Interior width	2180 mm
Interior height	1960 mm
Overall length	8320 mm
Overall width	2329 mm
Overall height	3065 mm
Sleeps (incl. dinette)	2 - 6
Driver + number of passengers	1 + 3
Bed dimensions, rear	2000 x 780 + 2000 x 700 mm
Bed dimensions, dinette	2060 x 1175 / 555 mm
Bed dimensions, loft bed	1880 x 1220 mm
Storage opening W/H	2 x 760 x 1040 mm

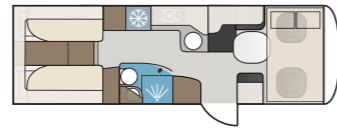

Travel Master Crown i860 LGB

Our largest Crown model has a generous floor plan. This motorhome features an oversized storage area, raised beds, separate toilet and shower, a spacious L-shaped kitchen and room for a total of 7 overnight guests! All built on a base from the premium brand Mercedes-Benz.

TECHNICAL SPECIFICATION	
Interior length, living area	6060 mm
Interior width	2180 mm
Interior height	1960 mm
Overall length	8822 mm
Overall width	2329 mm
Overall height	3065 mm
Sleeps (incl. dinette)	2 - 7
Driver + number of passengers	1 + 3
Bed dimensions, rear	2000 x 780 + 2000 x 700 mm
Bed dimensions, dinette	2060 x 1175 / 835 mm
Bed dimensions, loft bed	1880 x 1220 mm
Storage opening W/H	2 x 760 x 1040 mm

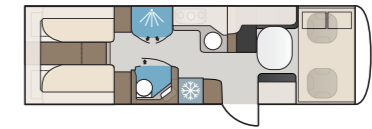

Travel Master Crown i810 LT

A fully integrated model that lives up to your expectations! You will find everything you need for a successful holiday including a practical L-shaped kitchen, a large bathroom in the rear of the motorhome and very comfortable beds.

TECHNICAL SPECIFICATION	
Interior length, living area	5564 mm
Interior width	2180 mm
Interior height	1960 mm
Overall length	8320 mm
Overall width	2329 mm
Overall height	3065 mm
Sleeps (incl. dinette)	2 - 5
Driver + number of passengers	1 + 3
Bed dimensions, rear	2 x 1940 x 780 mm
Bed dimensions, dinette	2060 x 1175 / 555 mm
Bed dimensions, loft bed	1880 x 1220 mm
Storage opening W/H	700 x 800 mm

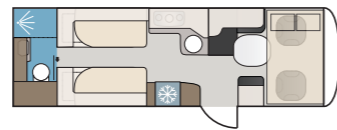

Travel Master Crown i860 LQB

A large and spacious motorhome with many practical storage areas. The dining/living area is located next to the generous L-shaped kitchen, creating a cohesive and functional living space. In the middle of this model, a toilet and shower are located on opposite sides, and in the back you'll find a comfortable queen-size bed.

TECHNICAL SPECIFICATION	
Interior length, living area	6060 mm
Interior width	2180 mm
Interior height	1960 mm
Overall length	8822 mm
Overall width	2329 mm
Overall height	3065 mm
Sleeps (incl. dinette)	2 - 6
Driver + number of passengers	1 + 3
Bed dimensions, rear	1995 x 1380 mm
Bed dimensions, dinette	2060 x 1175 / 835 mm
Bed dimensions, loft bed	1880 x 1220 mm
Storage opening W/H	2 x 760 x 1040 mm

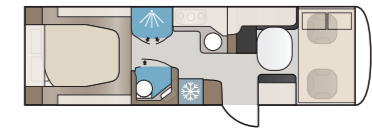

Travel Master Crown i810 LQB

A large queen-size bed is located in the back of this model and a drop-down double loft bed in the front of the motorhome. In total, including the convertible bed space in the dining/living area, i810 LQB features overnight space for five. The L-shaped kitchen with lots of smart storage makes this the motorhome of choice for a comfortable holiday.

TECHNICAL SPECIFICATION	
Interior length, living area	5564 mm
Interior width	2180 mm
Interior height	1960 mm
Overall length	8320 mm
Overall width	2329 mm
Overall height	3065 mm
Sleeps (incl. dinette)	2 - 5
Driver + number of passengers	1 + 3
Bed dimensions, rear	1995 x 1380 mm
Bed dimensions, dinette	2060 x 1175 / 555 mm
Bed dimensions, loft bed	1880 x 1220 mm
Storage opening W/H	2 x 760 x 1040 mm

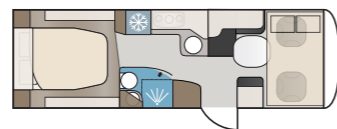

KABE Imperial

Our Imperial series is the definition of the absolute premium segment of motorhomes. With the highest standard in the market, in all aspects. Separate built-in oven, large and spacious bathroom, solar panels, inverter and double batteries, Premium Sound System, exclusive carpentry and luxurious leather upholstery, automatic zone heating, rear view camera and GPS are just a few examples of what is included. Imperial is built on a Mercedes-Benz base with an AL-KO chassis. The tandem axles at the rear provide an unbeatable smooth, safe and comfortable ride. KABE Imperial is for you, who will settle for nothing but the absolute best.

In 2024, we introduce Lancaster artificial leather with a surface of PU and a back made of recycled leather that together create a real leather feel! The material is soft, wear-resistant and easy to keep clean. The launch of Lancaster is a further step in our work with a focus on sustainability.

INTEGRATED MODELS:



New! Travel Master Imperial i790



Travel Master Imperial i810



Travel Master Imperial i860



Travel Master Imperial i910



Our fully equipped KABE Imperial include:

(In addition to what's included in Novum on page 65, Royal on page 70 and Crown on page 79.)

- ▶ AC for the living area – new Dometic Fresh Jet FJX4 2200
- ▶ Alde zone heating
- ▶ Central locks on several outside access doors
- ▶ Shower outlet in the garage
- ▶ Hydraulic support legs
- ▶ Corian Savannah kitchen counter top
- ▶ Electric adjustable headboard
- ▶ Flush toilet with a ceramic bowl
- ▶ A choice of two leather collections and one in artificial leather (3 fabric collections are also available)
- ▶ Solar panels, inverter and double AGM 130 Ah batteries
- ▶ Premium Sound System with DAB
- ▶ Electric locks for the lower kitchen cabinets and drawers
- ▶ KABE Smart Level
- ▶ Distronic (adaptive cruise control – keeps the distance to the vehicle in front)

See our options on pages 94-97.

Updates! New artificial leather collection (35% recyclable material) in brown with new curtains!

- ▶ New Innovation Design exterior graphics
- ▶ New model: Imperial i790 LQB with 790 length!
- ▶ New aluminium rims
- ▶ New spacers – wider track width
- ▶ New covered dashboard
- ▶ Kitchen counter top in a new shade – Corian Savannah
- ▶ New and unique flexible kitchen faucet
- ▶ New curtains for beige leather upholstery
- ▶ Double 150 Ah lithium batteries (option)
- ▶ New AC Dometic Fresh Jet FJX4 2200



KABE Imperial 2024

Travel Master Imperial is a year-round vehicle that includes the absolute best and latest in all areas, even in the base version. Solar panels, inverter, double batteries, luxury kitchen, top-quality queen-size bed and the most sophisticated warm water floor heating system in the market as well as hydraulic support legs are just a few examples.

The exclusive interior, the consistent level of quality and craftsmanship as well as a timeless design set the tone as soon as you step through the entrance door. The entire motorhome has a warm and inviting feel inside with new Atlas Zeder wood laminate, new upper cabinet doors in Cashmere in the front and back, a lighter new floor covering and Latte coloured table and counter tops.

Our exclusive Imperial kitchen, includes brand new upper kitchen cabinet doors in a mild crème shade with a gloss finish, Sabbia High Gloss. Corian Savannah kitchen counter top is also new for this year. A separate built-in oven in TecTower and an adjustable shelf with space for a coffee maker (in i910) are also available.

The exclusive front seats in Imperial, feature KABE custom leather upholstery with an integrated seat belt. In the lower part of the driver's cab, a stylish grey thermal drape is included.

Seat belts with Isofix standard and an adjustable headrest provide the absolute best riding comfort for the passengers. Forward-facing collapsible 5th passenger seat is available as an option.

Leather upholstery is standard in our Imperial models. This year's collection consists of two options and a brand new alternative in artificial leather. You will always be comfortably seated in our L-shaped sofa with an adjustable armrest and slide-out function. It's easy to adjust the angle of both the seat and backrest. The smart sofa construction with a safety frame prevents you from sliding under the seat belt in the event of a collision. We do everything for your safety.



KABE Smart Level. The KABE Smart D panel includes KABE Smart Level with three smart functions. Smart Level keeps track of your gas level, tyre pressure and the inclination of your motorhome when it's parked. With Smart Level your KABE-life is even better!



The bedroom includes a smart touch-switch and reading lights in modern black-chrome. Electrical adjustable headboard is included in KABE Imperial.

Our KABE-bathrooms are carefully planned as well. You can choose between a large bathroom or a separate shower and toilet. In the latter solution, the entire bedroom area is separated from the living area by opening the doors on both sides all the way. Smart and private!

The new Light Concrete bathroom counter top has a contemporary look. In our T-models, matching laminate on the wall behind the mirror and on the walls in the shower are a nice design-touch.

ALDE Flow in boiler 3030 Plus is available as an option.

Imperial includes Alde zone heating. With the system, you can control the heat in two separate zones, the back and front of the motorhome. The bathroom is always comfortably heated on the return loop.

The Imperial series includes the latest generation AC from Dometic – Fresh Jet FJX4 2200 – to ensure that you are as comfortable as possible even during the hottest summer days (read more on page 32).

A wireless router is standard in all Imperial models, as is a wireless charger in the front of the motorhome.

DISTRONIC is included in Imperial.

- ▷ **Wood laminate:** Atlas Zeder
- ▷ **Floor covering:** Light
- ▷ **Upper cabinet doors front/back:** Cashmere
- ▷ **Kitchen cabinet doors:** Sabbia High Gloss
- ▷ **Kitchen counter top and back splash:** Savannah Corian and Latte with plexiglas
- ▷ **Back wall:** Cashmere
- ▷ **Table and counter top:** Latte laminate
- ▷ **Entry area counter top:** Latte laminate
- ▷ **Bathroom counter top:** Light Concrete laminate
- ▷ **Bathroom cabinet doors:** Atlas Zeder
- ▷ **Wardrobe doors (bedroom):** Atlas Zeder
- ▷ **Leather collections:** Hollywood (dark grey) and Baltimore (beige)
- ▷ **Artificial leather:** Lancaster (brown)



TECHNICAL SPECIFICATION	
Interior length, living area	5164 mm
Interior width	2180 mm
Interior height	1960 mm
Overall length	7920 mm
Overall width	2329 mm
Overall height	3065 mm
Sleeps (incl. dinette)	2 - 5
Driver + number of passengers	1 + 3
Bed dimensions, rear	1995 x 1380 mm
Bed dimensions, dinette	2060 x 1175/584 mm
Bed dimensions, loft bed	1880 x 1220 mm
Storage opening W/H	2 x 760 x 1040 mm



New! Travel Master Imperial i790 LQB

The smallest option in our Imperial-series, includes KABE's generous queen-size bed all the way in the back and a drop-down double bed above the dining area. With an additional convertible sofa-bed, overnight space for 5 is possible. Separate toilet and shower as well as a functional L-shaped kitchen creates a comfortable space.



With Isofix seat belt buckles and an adjustable headrest, you will travel more comfortably than ever! Introduced in model year 2023 for 3rd and 4th passenger seats.



TECHNICAL SPECIFICATION	
Interior length, living area	5564 mm
Interior width	2180 mm
Interior height	1960 mm
Overall length	8320 mm
Overall width	2329 mm
Overall height	3065 mm
Sleeps (incl. dinette)	2 - 6
Driver + number of passengers	1 + 3
Bed dimensions, rear	2000 x 780 + 2000 x 700 mm
Bed dimensions, dinette	2060 x 1175 / 555 mm
Bed dimensions, loft bed	1880 x 1220 mm
Storage opening W/H	2 x 760 x 1040 mm

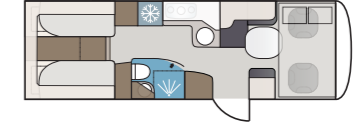

Travel Master Imperial i810 LGB

A motorhome designed for smart travel with lots of storage space and the highest level of comfort. i810 LGB offers an oversized storage area under the raised beds along with a kitchen with generous cabinets and drawers.



TECHNICAL SPECIFICATION	
Interior length, living area	5564 mm
Interior width	2180 mm
Interior height	1960 mm
Overall length	8320 mm
Overall width	2329 mm
Overall height	3065 mm
Sleeps (incl. dinette)	2 - 5
Driver + number of passengers	1 + 3
Bed dimensions, rear	2 x 1940 x 780 mm
Bed dimensions, dinette	2060 x 1175 / 555 mm
Bed dimensions, loft bed	1880 x 1220 mm
Storage opening W/H	700 x 800 mm

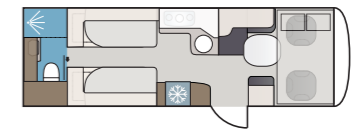

Travel Master Imperial i810 LT

Our fully integrated i810 LT offers every convenience. Comfortable beds, a functional L-shaped kitchen, a generous seating area and a large bathroom. Always premium quality.



TECHNICAL SPECIFICATION	
Interior length, living area	5564 mm
Interior width	2180 mm
Interior height	1960 mm
Overall length	8320 mm
Overall width	2329 mm
Overall height	3065 mm
Sleeps (incl. dinette)	2 - 5
Driver + number of passengers	1 + 3
Bed dimensions, rear	1995 x 1380 mm
Bed dimensions, dinette	2060 x 1175 / 555 mm
Bed dimensions, loft bed	1880 x 1220 mm
Storage opening W/H	2 x 760 x 1040 mm

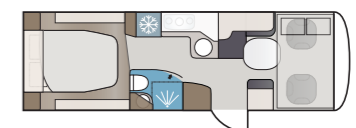

Travel Master Imperial i810 LQB

A motorhome with plenty of space that includes an L-shaped kitchen with lots of storage options. The comfortable queen-size bed placed in the rear of the motorhome together with a drop-down double loft bed located in front of the motorhome provide several bed spaces.



Travel Master Imperial i860 LGB

A unique model built to travel in style! This generous floor plan provides lots of living space. You'll find a large L-shaped kitchen, toilet and shower located on opposite sides of the motorhome and extra storage solutions.

TECHNICAL SPECIFICATION	
Interior length, living area	6060 mm
Interior width	2180 mm
Interior height	1960 mm
Overall length	8822 mm
Overall width	2329 mm
Overall height	3065 mm
Sleeps (incl. dinette)	2 - 7
Driver + number of passengers	1 + 3
Bed dimensions, rear	2000 x 780 + 2000 x 700 mm
Bed dimensions, dinette	2060 x 1175 / 835 mm
Bed dimensions, loft bed	1880 x 1220 mm
Storage opening W/H	2 x 760 x 1040 mm

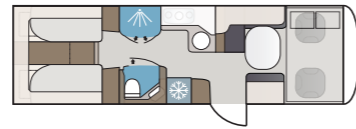

Travel Master Imperial i860 LQB

With an L-shaped kitchen and many practical storage options, this floor plan has lots of room for everyone and everything. A large comfortable queen-size bed is placed in the rear of the motorhome with toilet and shower on opposite sides.

TECHNICAL SPECIFICATION	
Interior length, living area	6060 mm
Interior width	2180 mm
Interior height	1960 mm
Overall length	8822 mm
Overall width	2329 mm
Overall height	3065 mm
Sleeps (incl. dinette)	2 - 6
Driver + number of passengers	1 + 3
Bed dimensions, rear	1995 x 1380 mm
Bed dimensions, dinette	2060 x 1175 / 835 mm
Bed dimensions, loft bed	1880 x 1220 mm
Storage opening W/H	2 x 760 x 1040 mm

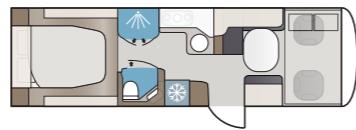

Travel Master Imperial i910 GB

KABE i910 GB is one of our largest fully integrated motorhomes. The spacious storage area, located under the slightly raised beds, is easy to access through the oversized exterior door. An elegant, curved kitchen is a great design touch.

TECHNICAL SPECIFICATION	
Interior length, living area	6564 mm
Interior width	2180 mm
Interior height	1960 mm
Overall length	9320 mm
Overall width	2329 mm
Overall height	3065 mm
Sleeps (incl. dinette)	2 - 7
Driver + number of passengers	1 + 3
Bed dimensions, rear	2000 x 780 + 2000 x 700 mm
Bed dimensions, dinette	2060 x 1175 / 1050 mm
Bed dimensions, loft bed	1880 x 1220 mm
Storage opening W/H	2 x 760 x 1040 mm

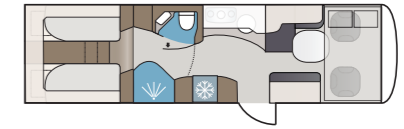

Travel Master Imperial i910 T

i910 T has a large bathroom that spans the entire width in the back of the motorhome. Two single beds, a curved kitchen with lots of special features and a comfortable seating area creates the perfect environment to relax.

TECHNICAL SPECIFICATION	
Interior length, living area	6564 mm
Interior width	2180 mm
Interior height	1960 mm
Overall length	9320 mm
Overall width	2329 mm
Overall height	3065 mm
Sleeps (incl. dinette)	2 - 6
Driver + number of passengers	1 + 3
Bed dimensions, rear	2 x 1940 x 780 mm
Bed dimensions, dinette	2060 x 1175 / 1125
Bed dimensions, loft bed	1880 x 1220 mm
Storage opening W/H	1160 x 700 mm

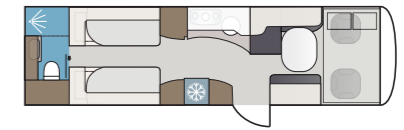

Travel Master Imperial i910 QB

i910 QB features a large, comfortable queen-size bed in the rear of the motorhome. The elegant, curved kitchen together with a well appointed seating area makes this a true luxury motorhome.

TECHNICAL SPECIFICATION	
Interior length, living area	6564 mm
Interior width	2180 mm
Interior height	1960 mm
Overall length	9320 mm
Overall width	2329 mm
Overall height	3065 mm
Sleeps (incl. dinette)	2 - 6
Driver + number of passengers	1 + 3
Bed dimensions, rear	1995 x 1380 mm
Bed dimensions, dinette	2060 x 1175 / 1050 mm
Bed dimensions, loft bed	1880 x 1220 mm
Storage opening W/H	2 x 760 x 1040 mm

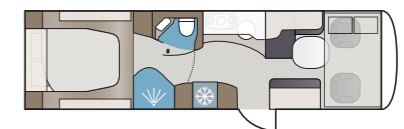

LOTS OF OPTIONS

Novum, Royal, Crown, Imperial

Add that little extra to your KABE. We know what's needed for a comfortable motorhome-life. That's why every KABE includes a generous list of standard equipment. To be honest, we offer many details that other manufacturers charge extra for. But we all have different needs, naturally you may choose the options that are right for you, to create the perfect solution for your family. A wide range of options are available*.

Two powerful packages for Novum and Royal models: The Comfort package and Design package! Both are added in the factory prior to delivery of your motorhome.

COMFORT PACKAGE (Novum, Royal)



Road sign assistance

High beam assistance

Thermotronic vehicle section

DESIGN PACKAGE (Novum)



Chrome radiator grill

Aluminium rims

Projected KABE logo in the entry

LED headlights (high and low beam)

DESIGN PACKAGE (Royal)



Chrome radiator grill

Aluminium rims x780 / x880 (prices may vary)

Skyview decor

LED headlights (high and low beam)

*With the addition of options, the minimum load capacity must be considered so that it is not affected as defined in ECE 1230/2012.

ENGINE / CHASSIS



DISTRONIC / adaptive cruise control. Set the desired distance in the assistant. The active distance assistant DISTRONIC maintains the distance to the vehicle in front, assisting the driver on the highway or in stop-and-go traffic (standard in Imperial).

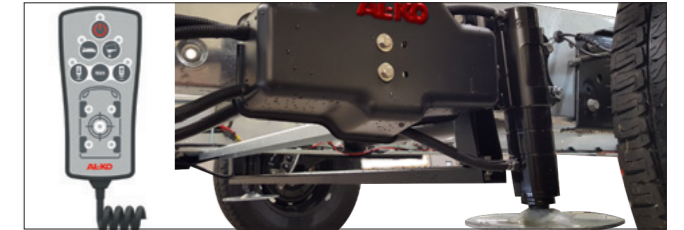

AL-KO HY4 hydraulic support legs. Simply press the button on the controller to level your vehicle. To activate night mode with a slight inclination forward, just press that button. Yet another button will pull in the support legs entirely. You can also manage HY4 manually and control combinations of support leg pairs as you wish. Each leg has its own motor and the entire system is mounted on the chassis. Not inside the vehicle. HY4 is standard in Imperial, available as an option in others.

EXTERIOR



Extendable step at driver's door i760, i790, i810, i860, i910



Rear mud guards: i760, i790, i810, i860, i910



Pull-out storage n750, x780 and x880



Tow bar (maximum towing capacity 2000 kg) MB train weight: 5880 kg

CLIMATE / HEATING



Electric awning
4,5 m awning – x780
5,0 m awning – i760
5,5 m awning – i810, 860, x880
6,0 m awning – i910



Awning lighting



NEW! Dometic Fresh Jet FJX4 2200 air conditioner for the living area (standard in Imperial)



Alde Flow for boiler 3030 Plus. Alde Flow provides continuous warm water allowing you to shower as long as you'd like!



Solar panel. Produce your own electricity! Eco-friendly, easy and practical. GoCamp's superior solar panel package provides 140 W. The panels frame is made in durable aluminium, with aerodynamic spoilers to reduce wind noise on the road (standard in Imperial).



Water purification system – Alde AquaClear UV-C (Alde Compact 3030 boiler). Efficient water purification that protects the user in a gentle and eco-friendly way. Unwanted viruses and bacteria, pesticides and chemicals are removed. The water is disinfected with UV-C light generated from LED's. In addition, the water passes through a carbon filter that removes any odour, bad taste and colour.



Heated seats / seat cooling (Crown, Imperial)



Pleated thermal drape

INTERIOR



Electric adjustable headboard (standard in Imperial)

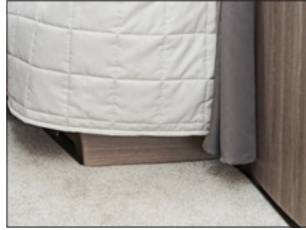

Fitted carpet



800 W, 230 V microwave



Compressor refrigerator (only for Novum and Royal)

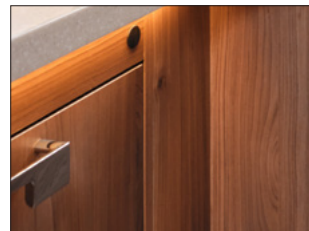

Electric lock for lower kitchen cabinets and drawers (standard in Imperial)



Theford ceramic toilet (standard in Imperial)



Cinderella combustion toilet (not available for Novum, Royal x780LB and LGB)



Shower floor wood insert

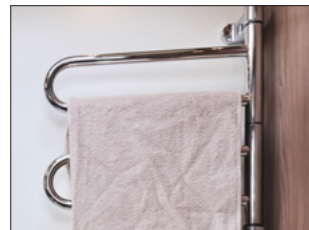

Electric heated towel rack with timer (i760 LXL/LGB, x780 LXL, i810 LGB/LQB, i860 LGB/LQB, i910 GB/QB)



Electric heated towel holder 170 cm length (i760 T, x780 LT/LQB, i810 LT, x880 LT/LQB, i910 T)



Shower fan (available in several models)



Loft bed drapery

5th passenger seat. Do you want to invite an extra friend or family member on your trip? Choose the extra, fifth passenger seat for your vehicle.

Collapsible 5th passenger seat with forward facing seat.



Backward facing passenger seat for one, inside the door, for models: i760LGB, i810LGB, i810QB, i810LT (not for x780LT, x780LQB, i760T)



Collapsible 5th passenger seat. Forward facing passenger seat for two, inside the door, for models: x780LB, x780LGB, x780LXL, x880LT, x880LQB, i760LXL, i860LQB, i860LGB, i910GB, i910T, i910QB

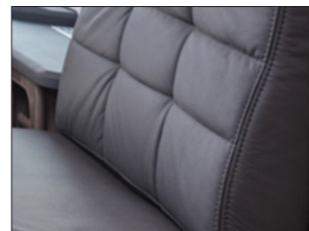

Face-to-face sofa (only for Royal x780LXL)

INTERIOR



Hollywood leather upholstery (standard in Imperial)



Baltimore leather upholstery (standard in Imperial)



NEW! Lancaster artificial leather (standard in Imperial)



Duo Control gas switch



Shower outlet (standard in Imperial)

BATTERY / CHARGER



Extra AGM 130 Ah battery, for the living section (standard in Imperial)



1800 W inverter (standard in Imperial)

ALARM / SAFETY



Burglar alarm including perimeter protection and internal motion detector (standard in Crown, Imperial)

CONNECTIONS



Exterior gas outlet



Central locks exterior doors and access doors (standard in Imperial)

SOUND / VISUAL



External router antenna

OTHER EQUIPMENT



KABE Smart D Remote* enables you to manage the control panel remotely, from anywhere. KABE Smart D Remote is built with a 4G router with an internal antenna and a mobile modem (external antenna is available as an option). See page 24.



KABE Smart Level. The KABE Smart D panel includes KABE Smart Level with three useful functions. Smart Level tracks your gas level (with use of one gas bottle, not for composite bottles), tyre air pressure and the inclination of the motorhome.



NEWS! With KABE's new bike rack, travelling and storing your bikes is easier than ever.

The bike rack has a pull-out function and with a special module that allows you to turn the handlebars, you can maximise the space in the garage.

* With your purchase of KABE Smart D Remote, a 36 month subscription is included. After 36 months, you will pay a yearly fee for the use of the app.



Plenty of room for all your extras



Plenty of room for all your equipment! Choose a KABE model with a large storage space. Our garage- and QB-models can fit bicycles, tables and chairs – everything you need for a successful holiday! A new bike rack is available as an option! See page 97.



Pull-out plastic storage bins are included in our fully integrated motorhomes. The bins are easy to remove and pack elsewhere. Smart and simple!



Practical tie-down anchors in the garage space help to keep everything in place.



Our large pull-out storage is perfect for all kinds of things. Available as an option in Novum and Royal.



In KABE's fully integrated models, the space between the double floors is utilised in a smart way. In Travel Master i810 LQB, you can access the storage space from the garage area.



The solid access doors in the double floor of our fully integrated models, makes it easy to access your luggage.



YOUR KABE DEALER