



KABE MADE IN SWEDEN

KABE 2024

Caravan



KABE



Always a step ahead...

At home – anywhere in the world!

Our goal is to be one step ahead and surprise you with technology and amenities beyond the ordinary. With functions that enhance your environment and improve your quality of life, wherever you are. It can be adventurous and strenuous, or calm and peaceful. The focus is always on design, comfort, quality and safety, seasoned with smart solutions for a greater experience and smoother holiday on wheels. In any season.

At home, anywhere you go!

KABE caravans are among the most well-equipped in the market, in every price segment. Find your favourite today.

KABE will not be held liable for printing errors and typos.
KABE reserves the right to change design and data without prior notice.
The images in this catalogue may contain some optional equipment.



Contents

04	SCANDINAVIAN DESIGN
14	COMFORT
26	QUALITY
36	SAFETY
44	2024 MODEL PROGRAM
45	KABE FLEXLINE
46	2024 STANDARD EQUIPMENT
50	KABE ESTATE
60	KABE GEMSTONE
68	KABE ROYAL
84	KABE IMPERIAL



SCANDINAVIAN DESIGN

With style and function

Scandinavian design and Swedish quality have always been the hallmark in the development of every KABE model. Style and function go hand in hand. The result is luxurious and comfortable caravans, with a timeless feel and many innovative solutions to provide you with a mobile holiday home beyond the ordinary.

KABE – an investment in quality of life

A caravan from KABE is an investment in quality of life. We leave nothing to chance. For more than 65 years, we have developed and manufactured leisure vehicles that allow you to travel safely, securely and environmentally friendly on the road, while enjoying the greatest possible comfort at your destination.

Behind every detail there is a thought, to provide you with the very best. We go all the way – and then some – in our quest to fill our caravans with smart solutions and functions to provide you with a life-style that is as smooth as possible.

With KABE quality built into our unique construction, from carpentry produced in-house, to practical interior details and technical solutions that are always at the absolute forefront of the industry.

All the things you may not notice right away, when you compare a KABE with other brands, are there to make your caravan life easier every single day.

All the "extras", are simply included from KABE.

Some examples are:

- Insulated energy efficient windows.
- Sound-insulating ceiling.
- Smoke detector in the bedroom area.
- Pull-out heated ski storage with lighting.
- Drying cabinet with a custom design drip pan for drying shoes and heated shoe compartment inside the door.
- Many of our models feature a walk-in wardrobe with space for jackets and coats.
- Air vent in the bedroom.
- Built-in kitchen fan with lighting and two speeds.
- The best refrigerator ventilation in the market is included in many models.

Do you want to know more? See pages 28-35.



Luxury inside and out

Design, comfort, quality and safety – that's what KABE stands for. Our classic features are clearly recognizable on the road. And when you get to know your KABE, with all its well thought-out conveniences, you realize the true value of our design. It's all in the details.

KABE's characteristic exterior is a stylish statement and the elegant, smooth sheet metal exterior is standard in all our caravans. The exclusive Imperial caravans are designed with extra bold graphics and our unique Innovation Design décor, printed directly on the exterior with a high UV resistance. The colour will last for many years without fading.

Our modern Estate models, feature black window frames and unique decal graphics with a 3D-feel.

Every model includes large windows that provide a bright and open indoor environment.

The brake lights are custom designed with a KABE logo and our aerodynamic body and rear wing have been developed to reduce wind resistance.

At KABE, we put a lot of work into the constant development of our caravans. We strive to be at the forefront or even a step ahead of the competition. To be able to provide you, the KABE-owner, with the very best – a safe caravan that maintains the highest standard and an exclusive feeling inside and out.

NEWS! In 2024, Gemstone and Royal are updated with a distinctive red decor that highlights the caravan's window sections and reinforces the body's elegant and aerodynamic shape.

All Imperial caravans are equipped with KABE's printed Innovation Design exterior, which makes it possible to create unique design elements that follow the shape of the caravan's body and complement the placement of windows and doors. In 2024, Imperial is updated with a new expressive design that reinforces the elegant look.

New design for the air vent in black in the bedroom area.



Updated interior in every caravan model as of 2024!



Modern, stylish and elegant

In a KABE caravan, you'll experience comfort and quality in every detail, every day. We select all materials with the utmost care, to meet your expectations in terms of both aesthetics as well as durability. The look is timeless. Rest assured that your KABE will always feel modern, stylish and elegant.

Updated interior in every caravan model as of 2024!

Our Gemstone, Royal and Imperial series feature the brand-new wood laminate Atlas Zeder, in a warm brown tone. The exclusive feeling of our interior is enhanced with a lighter new floor covering, new upper cabinets and upper cabinet doors in Cashmere (Royal and Imperial) and Grau doors in the Gemstone series.

Estate is also equipped with Grau upper cabinet doors in a newly developed design with a black stripe and wood edging that nicely accentuates the caravan's dark floor and other interior details.

The updated interior shades create an inviting living space that is followed up with a counter top in the modern laminate Light Concrete (Royal, Imperial) and bright Perla (Gemstone). In Estate we've kept the kitchen counter in the laminate Elero.

Every caravan has a sound-insulating fitted ceiling that effectively prevents interference from both inside and outside noise.

The lighting in your home is an important factor and it is equally valuable in your caravan. In every KABE, you will find light fixtures with built-in spotlights, night lights with a switch by the bed, an internal switch for the exterior lighting in gas compartment and ski storage, as well as lighting in wardrobes and under bed storage.

NEWS! The new Royal and Imperial 740 CTDL elevate the feeling of home. With a large luxurious bathroom and a separate shower, KABE's new L-shaped kitchen and an extra spacious seating area where the TV can be stored in a smart compartment in the back rest of the sofa when it's not in use.

Design and upholstery

It is the details and many comfort values, that create the pleasant overall feeling in a KABE. In addition to sitting and sleeping comfortably, we think it is important to offer textiles and upholstery that meet the design, care and durability requirements of modern caravan families.

This year's collection includes three options in fabric, two in leather and one in artificial leather. Estate includes two fabric collections

Design, function or environmentally friendly? Why choose?

In 2024, we introduce brand new Lancaster! This collection in artificial leather has a surface made of PU and the back is made from recycled leather that creates an overall real leather feel! The material is soft, resistant to wear and very easy to keep clean. Use lukewarm PH-neutral soapy water and dry with a damp cloth. The launch of this new material is a step further in our work with a focus on sustainability. Lancaster upholstery is stylish and environmentally conscious at the same time!

Height and side-to-side adjustable headrest is yet another smart detail (option for Estate and Gemstone, Comfort Package).

Our new Fontana, Ontario, Tulsa, Fremont, Baltimore and Lancaster collections are complemented by fresh new curtains.

FABRIC

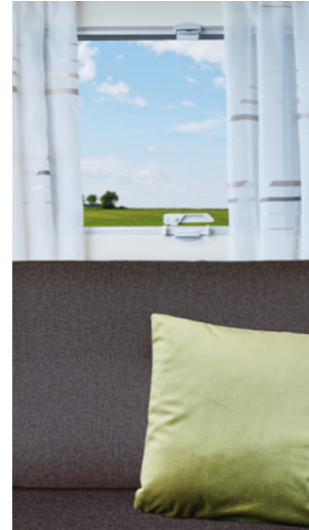

AMARILLO (dark brown)
Estate – panel curtain only



FONTANA (beige)
Estate – panel curtain only

FABRIC



ONTARIO (dark brown)
Gemstone
Royal
Imperial
Panel curtain option available
(Royal, Imperial)



TULSA (beige)
Gemstone
Royal
Imperial
Panel curtain option available
(Royal, Imperial)



FREMONT (black)
Gemstone
Royal
Imperial
Panel curtain option available
(Royal, Imperial)

LEATHER



HOLLYWOOD (dark grey)
Royal (surcharge)
Imperial (standard)
Panel curtain option available
(Royal, Imperial)



BALTIMORE (beige)
Royal (surcharge)
Imperial (standard)
Panel curtain option available
(Royal, Imperial)

ARTIFICIAL LEATHER 35% recycled material



LANCASTER (brown)
Royal (surcharge)
Imperial (standard)
Panel curtain option available
(Royal, Imperial)

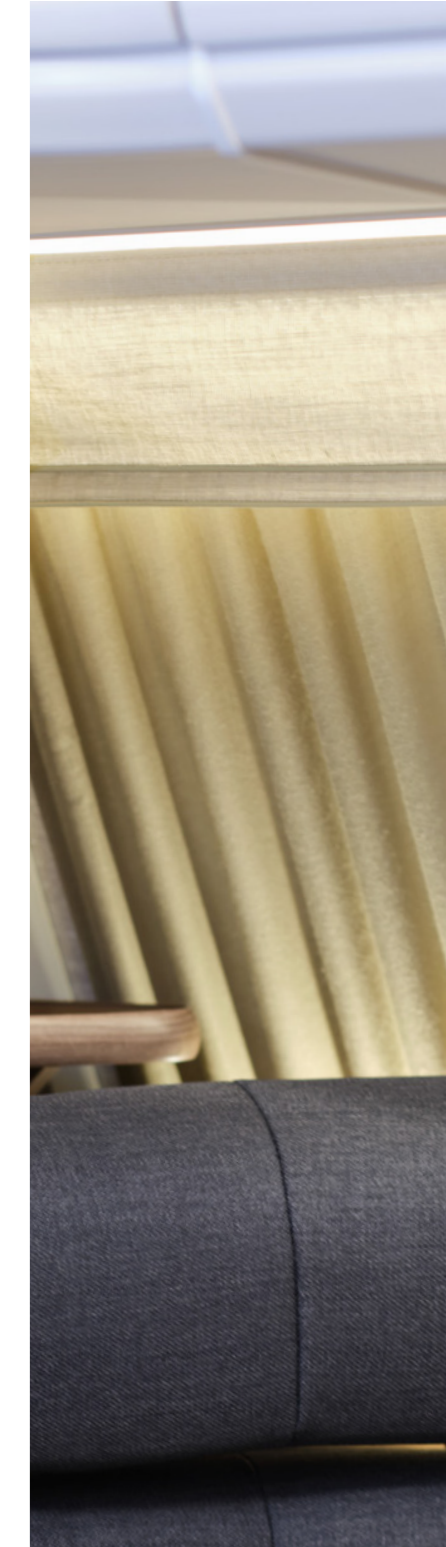

COMFORT

Year round, in any road conditions and directions

The comfortable KABE-life is characterized by convenient travel and maximum relaxation when you arrive with your caravan. We include every detail in the design of our vehicles. Whether the goal is the journey itself or the destination, the comforts are there and create safety and a sense of home year round. On any road, anytime.



Full-scale culinary delight

Just like at home, the kitchen is an important part of your caravan and the heart of family life. All KABE kitchens are well-equipped with plenty of storage and a well-thought-out design. We know that fine cooking requires its own space. Smart solutions provide extra work space when you need it most.

The drawers are equipped with soft-close and central locking. There are many exclusive details here, such as a rounded sink with a surface-mounted faucet, pull-out cutting board in carefully selected beech wood and a functional cutlery drawer. Naturally, you can sort your waste with separate bins, just like at home.

It's a kitchen that attracts full-scale dining pleasure, regardless of how many people gather at the table.

Gemstone, Royal and Imperial include recessed cabinet doors and drawers. Royal and Imperial are updated with a new modern kitchen counter top, Light Concrete. Gemstone features the new counter top Perla. Both are made of a durable material that is easy to keep clean.

The microwave is placed under the fridge, to maximize the space in the kitchen cabinets and at the same time, keep the clean look of the upper part of the kitchen. Microwave is standard in Imperial and an option for Estate, Gemstone and Royal.

Dometic's innovative refrigerator, with double-hinged doors for both the refrigerator and freezer compartment, can be opened with the aluminium moulding on either side of the door. A flexible function that makes everyday life easier for everyone in the compact caravan environment. Neonflex thin silicone profile with LED lighting frames the refrigerator on both sides. Compressor fridge from Dometic is available as an option for all our model series.

In Gemstone, the split cover for the three-burner stove provides a smart, extra work surface.

Royal includes a Thetford stove with three gas burners, one electric burner and a convection oven (except for 540 GLE and 560 GLE). The convection oven function requires 230 V, otherwise the oven works just like a regular gas oven.



NEWS! New kitchen faucet in all models (except for Estate).

The Light Concrete kitchen counter top in our Royal and Imperial models and Perla in Gemstone are part of a major update of KABE's interior design.

The laminate continues to the back splash, which gives an expanded feeling behind stove and sink. At the same time, it's easy to clean.



Royal features Cashmere upper cabinets throughout, also in the kitchen (left), while the kitchen cabinets in Gemstone match the rest of the interior with new Atlas Zeder.

The Imperial kitchen is not your ordinary caravan kitchen! The concept of premium taken one step further to create a kitchen for the true connoisseur. KABE Imperial is equipped with a luxurious induction stove top, set into the kitchen counter, with two separate gas burners and an exclusive built-in oven. Soft, crème-coloured kitchen cabinets in new Sabbia High Gloss with gloss finish doors are brand new this year.

KABE's Estate kitchen includes new kitchen cabinets in the same light colour as the model's new upper cabinets. They complement the light Elero kitchen counter top and blend in nicely with the rest of the interior and design throughout the caravan. The drawers in the kitchen counter have a darker wood laminate in the colour Nussbaum Ombre. The black kitchen faucet and the matte black handles are the finishing touches.



Room for everyone

The living room is the place to relax and socialise. In order to enjoy each other's company, comfortable space is needed for everyone. Or maybe you want to work from home sometimes?

That's why our sofas are generously proportioned and equipped with comfortable, ergonomically shaped cushions. The headrest in the corner sofa can be adjusted up and down and from side-to-side (option for Estate and Gemstone, Comfort Package). You'll always be comfortably seated and the smart storage space under the seat makes it easy to keep things organized. You can also expand the table surface with an extension (Gemstone, Royal and Imperial).

Choose the upholstery collection that best suits your taste, from our unique and carefully tested options. Curtain sets are available in two different seams (not for Estate). See pages 12 and 13.

Cushions with high-quality Premium Foam inside are included in Gemstone, Royal and Imperial. And all our cushions are equipped with anti-slip material on the underside, so that they stay firmly in place.

In Imperial, leather upholstery or artificial leather is standard and the sofas include a slide-out function, with easy adjustment of the angle in both seat and back cushions.

Another smart solution, is the sofa that can easily convert into a large extra place to sleep if you have temporary overnight guests, perhaps grandchildren or the teenager's friend who come to visit.

Details such as rounded corners in the sofa and indirect lighting along the underside of the cabinets give a luxurious feel. Speakers are installed in the front corners, to further enhance your comfort and the cosiness factor.

A radio is included in Estate and Gemstone. In our Royal-caravans you will find a multimedia player with DAB. Imperial is equipped with KABE's exclusive Premium Sound System with DAB.

To make your connected life easier, a wireless network router is included in all KABE models. An external antenna for the router is available as an option. In the front of Royal and Imperial, we've installed an easily to access wireless charger for your mobile phone.

Gemstone, Royal and Imperial have an elegant and discreet bar cabinet in the entry, with bottles stored lying down.

Our model series Gemstone, Royal and Imperial include a front window that can be opened since 2022.



Wake up rested and refreshed

A good night's sleep is important in your caravan to wake up rested and refreshed, ready for travels and new experiences. We include very comfortable beds and mattresses, often an additional charge from other manufacturers.

You deserve the best!

In KABE, you can choose the bedroom layout that works best for your family's needs. Whether you choose single or double beds, the beds are of the highest quality with spring mattresses, thick mattress pads and a base with flexible slats (not for bunk beds). To accommodate the whole family, we also build bunk beds with up to three levels. Efficient "compact living" and a cosy place for the little ones. There are USB outlets by the bunk beds, which facilitate the children's game or movie time if the holiday weather is not exactly as everyone wished.

Coordinating bedspreads are always included in your KABE.

A practical storage area is located under the adjustable bed. Several models have an access door that allows you to reach the space under the bed from the outside.

The bed is not just a place to sleep. You may want to curl up with a book or newspaper for a moment to relax. For additional comfort, the headboard is covered in soft padded imitation suede, with a 3D printed look that contributes to the stylish and cosy feeling of your KABE-bedroom.

In addition, you will find details such as soft lighting above the bed and an adjustable headboard is standard in Gemstone and Royal. In Imperial, electrical adjustable headboard is standard (except for E9 bed).

Night light or not? When you want to turn the night light on or off, the switch is exactly where it should be – by the bed. With an XL bed, DuoSpot reading lamp with three buttons is included.

Model year 2023, we introduced a smart switch with touch-function in Royal and Imperial.

In addition, our bedrooms are furnished with spacious wardrobes and upper cabinets so that you can fit everything your family needs on the trip.

NEWS! The wardrobe doors in the Gemstone, Royal and Imperial match the interior with new Atlas Zeder laminate, and its warm brown tone. Estate features wardrobe doors in Grau with a beautiful wood edge.





Bathroom comfort just like home

A shower and toilet is at the top of the list for many people in order to make everyday life in the caravan as comfortable as possible. Would you like a caravan with a large and spacious bathroom and walk-in shower? Or would you rather use the space for other things and place the bathroom as a divider between the different areas of the caravan? We offer many flexible solutions to choose the floor plan and bathroom comfort that best suits you and your family.

Everything to make you feel at home.

The well-thought-out details and the stylish design that characterizes your entire KABE caravan, continue into the bathroom. In Gemstone, Royal and Imperial, the colour theme from the rest of the interior is completed with details in Atlas Zeder.

The bathroom in the Estate has cabinets in Nussbaum Ombre dark wood laminate.

Exclusive handles and hangers, as well as a lock for the bathroom door add additional design details to your KABE bathroom. Bathroom counter top in the durable laminate Urban Style with a modern concrete look is a nice touch in Estate and Gemstone. The laminate also appears on wall surfaces and in design details in Gemstone's TDL models.

Royal and Imperial are updated with the contemporary new bathroom counter top Light Concrete.

In our TDL models, the bathroom is located in the back of the caravan and spans the entire width. A walk-in shower is included. You will also find a matching laminate on the wall behind the mirror and shower wall as well as the elegant silicone profile Neonflex with LED lighting (not for Estate).

A shower is included in several other KABE models.

In the Imperial series, a swivel flush toilet with a ceramic bowl is standard. Heated towel rack is included in Royal and Imperial.

Exterior shower outlet with cold and warm water is available in Royal and Imperial. It makes it easy to rinse off your boots or a muddy dog after hike in the woods.





On the home page, you can see all the controls for lighting and digital dimmer sliders. It also displays the temperature, both outside and inside, and the time.



All information and controls for heating is displayed on a separate page. It's easy to raise and lower the heat with the touch of a button.



With Smart D you don't have to deal with different panels, you can control the refrigerator, AC, AirVent and more, everything in one display.



Current status information about freshwater level, wastewater level and battery voltage are clearly shown. With the Smart Level function, you can also see the gas level, tyre pressure and the caravan's inclination when parked (standard Imperial, optional Royal).



Smart technology for an even better KABE-life

With the KABE Smart D control panel – **winner of the European Innovation Award** – you can control many of the caravan's functions. The panel is designed with a focus on user-friendliness and has an easy-to-understand touch-screen display. You can monitor freshwater level, wastewater level and battery voltage. You can control lighting, AC, boiler and temperature. The system also has several alarm functions that remind you when it's time for service or if a fuse has blown. Everything conveniently featured in one screen. Standard in Royal and Imperial.

Which language do you want to navigate your KABE Smart D-panel with? You can easily select the language of choice, just like your smart phone.

KABE Smart D Remote makes it possible to remotely manage the caravan's control panel via an app, wherever you are. For example, you can start the AC on the way home from the beach or turn up the heat and fix a welcoming light before the last ride on the ski slope! KABE Smart D Remote is built with a 4G router with internal antenna and a mobile modem (external antenna is available as an option). In addition to controlling heating, lighting and keep track of the caravan's functions and alarms via the phone, you also have access to a wireless internet connection on your trip. KABE Smart D Remote* is available as an option for Royal and Imperial.

KABE Smart Level – Winner of the European Innovation Award (EIA) in the Vehicle Equipment category 2023.

KABE Smart Level keeps track of your gas level (with use of one gas bottle, not for composite bottles), tyre pressure and the vehicle's inclination when parked. The panel shows the gas level, you don't have to worry about unexpectedly running out during your trip. Tyre pressure sensor helps you with the right air pressure in the tyres, so that your trip is extra safe and fuel efficient. KABE Smart Level also includes a level indicator that shows the inclination of the vehicle when you park. Important for both your well-being and the functionality of your caravan. Standard in Imperial and available as an option for Royal.

The large AGM 130 Ah battery will not freeze, it allows for higher currents and has lower self-discharge. The battery sensor allows you to monitor your battery and how long the battery charge will last for different uses in the Smart D panel (included in the SmartVent and Eco-package options).

* With your purchase of KABE Smart D Remote, a 36 month subscription is included. After 36 months, you will pay a yearly fee for the use of the app. A separate mobile data subscription is needed as well.

QUALITY

More than 65 years of know-how and experience

KABE caravans are designed for the Scandinavian climate as well as the roads in southern Europe. All models are manufactured in our own factory in Tenhult, Småland, which today is one of Europe's most modern. We have a passionate team of developers, designers and installers who manage more than 65 years of know-how and experience. Our promise is to always offer the market's highest quality within each price segment.



How we build

Your KABE is easily recognizable with its exterior design and colour scheme. Behind the elegant exterior you will find a long list of unique construction and systems that have been developed to effectively interact with each other.

It is the whole that creates KABE's high quality and standard. With some essential parts in the form of an adapted chassis for safe driving, a sturdy and waterproof body and an elaborate system for heating, insulation and ventilation.

It's all about the details and in KABE, you will find lots of smart and sustainable solutions that contribute to the quality of the final caravan. Many of these details and solutions are things you won't find from other manufacturers.

We simply build caravans that we ourselves want to live in. Comfortable, functional and well-equipped, with the best year-round features on the market. To provide you with a relaxing holiday experience on wheels and always feel satisfied and safe in your KABE, wherever you go.



KABE-quality from start to finish

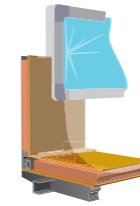

iWall construction

iWall construction deliver maximum stability and an absolutely waterproof body!

- The body is built with the Sandwich principle: outer sheet metal, 36 mm Ecoprim insulation, inner sheet metal and a wall covering that absorbs any condensation.
- Ecoprim is a waterproof material that is manufactured with closed cells, which means that it cannot absorb any moisture.
- Aluminium sheets on both sides of the Ecoprim insulation significantly reduce the impact from temperature differences.



Sealed roof joints

The transition from roof to walls is sealed in several stages.

- First, the joint between roof and wall is carefully sealed with elastic butyl compound.
- In the next step, we overlap the roof sheet with the wall sheet to completely avoid leaks.
- KABE's unique iWall construction provides an unlimited number of attachment points – important for mounting optional equipment.

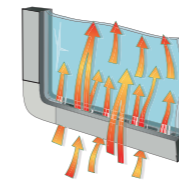

Sealed windows

Double-glazed energy efficient windows ensure that your caravan does not release more heated air than necessary during the cold season and vice versa when it is hot.

- Energy efficient windows with polyurethane frame that creates a seal against the double pane glass provides maximum insulation.
- The window frame is insulated with built-in ventilation, which prevents condensation on the inside of the window when the curtain is drawn at night.

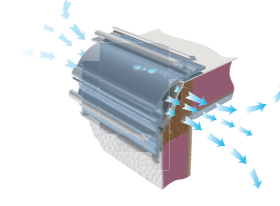

Aluminium profile

The profile is screwed both from the side and from above for maximum strength.

- Custom designed, extra wide profile in the joint between ceiling and wall.
- The profile has an air gap that ventilates the joint between wall and ceiling.
- The profile is mounted with double sealing strips and screwed together from two sides.
- Built-in awning rail on both sides of the caravan.

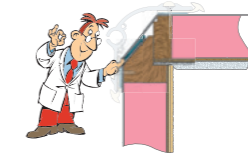

Butyl seals

Butyl tape retains its elasticity throughout the life of the caravan.

- Butyl tape is used throughout for all sheet metal joints, overlaps and screw bushings.
- Approx. 20 kg of sealing compound is used in each caravan.

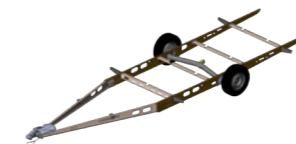

KABE Safety Driving System

KABE's axles provide comfortable and stable driving, and are adapted to the caravan's maximum load.

- Chassis with warm galvanized steel profiles.
- Electronically controlled anti-skid system provides extra safety on the road (not in Estate, optional in Gemstone).
- Axles that deliver comfortable and secure driving.
- Longer and stabilising tow bars.
- All models are equipped with a friction clutch.
- Our single axle caravans include premium tyres.



Plastic beams

KABE's unique construction provides a safe caravan with a long lifespan and documented good resale value.

- KABE uses plastic beams with integrated air ducts in all moisture-exposed parts of the body.
- Patent is pending for the KABE designed plastic beams.
- Our plastic beams have superior insulation properties.
- The plastic beams also provide better connections between the different parts of the body.

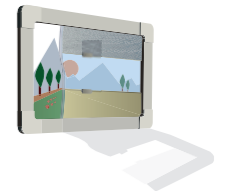

Unique windows with smart details

KABE's windows include all the features required for comfortable caravan living.

- The smooth and medium tinted exterior of the window panes protect against heat.
- Integrated screens and blackout curtains are included.
- All windows (except the kitchen window and Estate models) are continuously open-able. Front window that can be opened is standard (not for Estate).



Connecting beams in floor

The body can withstand very high loads, for example large amounts of snow on the roof.

- Extra beams between lengthwise chassis joists provide a more stable floor and an extra torsionally rigid chassis.
- Connecting beams for best possible stability.
- The chassis has outriggers from the lengthwise side beams, to relieve the weight where the floors and walls are joined.

The details make all the difference

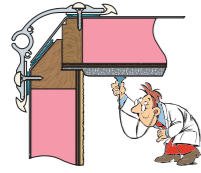

Soft, light reflecting and sound insulating ceiling

The soft inner ceiling creates a cosy indoor environment and reduces the sound from rain and wind.

- KABE is the only manufacturer to feature an exclusive 'soft ceiling' design, with better acoustics inside the caravan.
- Our 'soft ceiling' absorbs sound and improves the ceiling's insulation properties.

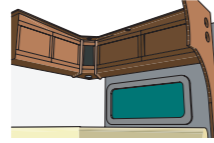

KABE-quality in every interior and all carpentry

Furniture construction and interior are always produced in KABE's own facilities.

- Scandinavian design throughout the interior.
- Upper cabinet doors open with a light touch.
- Kitchen drawers are equipped with soft-close and central locking.
- Robust and durable interior optimized for lighter weight.

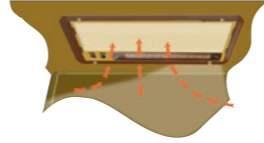

A well-equipped kitchen

In the KABE kitchen you will find equipment and details just like your kitchen at home.

- Built-in, two-speed kitchen fan with lighting.
- Removable grease filter for easy cleaning.
- Stove with electric ignition.
- The market's best refrigerator ventilation system with roof vents.

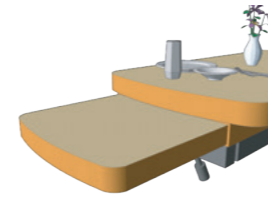

...more details in the kitchen

With many smart solutions the compact caravan kitchen appears bigger than you think!!

- Kitchen table with an integrated extension provides additional space (not for Estate or pedestal tables).
- Practical pull-out wire shelf in the kitchen in several models.
- Kitchen counter with plenty of space.
- Large fridge with freezer compartment, 177 litres (standard in Royal and Imperial).



Best seating comfort in the market, premium upholstery and textiles

With friends around the table or in front of the TV, you are always comfortably seated.

- Ergonomically designed sofas with durable, recycled Premium Foam cushions.
- Highest quality, wear-resistant upholstery.
- Several collections to choose from and the possibility to combine curtain sets with upholstery options (modern panel curtains or classic curtains with a valance).



Adjustable sofas and more

Adjustable sofas provide more efficient cleaning.

- Headrest and accent pillows standard in Royal and Imperial.
- Slide-out function with adjustable seat and back cushion is standard in Imperial.
- Adjustable headrest, height and side to side, in the corner sofa (option in Estate and Gemstone Comfort Package).
- Anti-slip fabric on the under side of all cushions keep them firmly in place.
- Leather upholstery or artificial leather is standard in Imperial.

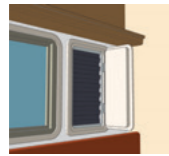

Practical, safe and secure in the bedroom

The bedroom is designed as a comfortable place to rest and relax.

- An air vent located in the bedroom area quickly provides fresh air in the caravan.
- A movable Velcro magazine pocket is provided bed side.
- Under bed storage compartment with lighting.
- Smoke detector and ground fault circuit breaker.



Very comfortable beds

Guaranteed good night's sleep and extra comfortable reading in bed.

- Spring mattresses and thick mattress pads guarantee a good night's sleep (not in bunk beds).
- Our adjustable headboards provide extra comfortable reading in bed (not Estate).
- Electric headboard (standard Imperial, option with Gemstone Comfort Package and for Royal).
- Several models can be equipped with a combined loft bed / upper cabinet.

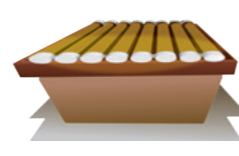

...more comfort details

Adjustable beds with soft-close for extra easy and efficient cleaning.

- Fitted bed slats support your body when resting.
- Beds with fold-up function and soft-close.
- Under bed storage space with our custom designed convectors at the access provides better heat in the bedroom area.
- Headboard with cosy lighting.

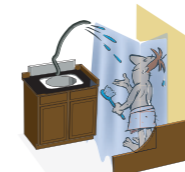

A bathroom with a shower

A shower gives you an increased feeling of freedom.

- Shower insert, water-proof wall covering, practical extendible hand shower and shower curtains are available in our various models.
- Several layouts have a walk-in shower.
- Bathroom door lock.
- Outside shower outlet with both warm and cold water (standard in Royal and Imperial).



Drying cabinet

Drying option after an active day outdoors is a practical feature in many of our models.

- Drying cabinet with custom design drip tray to dry your shoes.
- The drying cabinet has a special convector and an adjustable roof valve for maximum heat circulation.
- Heated shoe compartment inside the door.
- Walk-in wardrobe with room for jackets and coats.



Lots of lighting throughout

Night light provides a guiding light in the caravan at night.

- Light fixtures with built-in spotlights.
- Our Royal and Imperial models feature lighting in the windows in the seating area in front.
- Night light with the switch located by the bed.
- Interior light switch for exterior lights, the lighting in the gas compartment and ski box.
- Lighting in wardrobes and under bed storage.
- Modern switch with a touch-function.



KABE Smart D

With KABE Smart D control unit, you can manage many of the caravan's functions.

- Easy-to-operate electrical panel with touch-screen display.
- The electrical system detects the battery strength and automatically charges when necessary.
- The system keeps track of water level, temperature and battery voltage (standard Royal and Imperial).
- KABE Smart D Remote is available as an option for Royal and Imperial.



KABE Smart Level

Complete control with Smart Level! The KABE Smart D panel includes KABE Smart Level, with three practical functions.

- The panel shows the current gas level (for the use of one gas bottle, not for composite bottles). No need to worry about the gas running out unexpectedly.
- The tire pressure sensor helps you maintain the right air pressure in the tyres.
- A level indicator shows the inclination of the caravan when it's parked.

Your comfortable KABE life made even a bit simpler with full control of the situation.

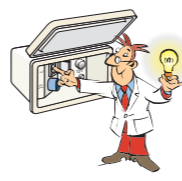

Electrical box

A modern caravan has a large consumption of power, therefore the charger must have a high capacity so that the battery is always in the best condition.

- Electrical box with 230 V input and 16 A automatic fuse with earth fault switch, control lights for electricity, 230 V / 12 V outlet, TV outlet for cable TV and outside TV (not for Estate).
- Controls that indicate the power supply.
- Electrical box with lighting (standard in Royal and Imperial).
- Battery charger for 25 / 30 A.

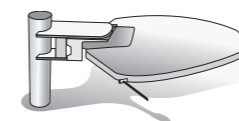

Ready for TV reception

Your KABE is equipped for the best reception.

- Electronic TV antenna for both analogue and digital reception.
- Exterior connection for the TV, cable TV and 12 / 230 V.
- Equipped with TV antenna outlet in three places: in the seating area, bedroom area and the electrical box.



Sound and visual

A KABE life as connected as you want!

- Multimedia player with DAB included in Royal. KABE premium sound system with DAB is standard in Imperial. Radio is standard in Estate and Gemstone.
- Built-in speakers in the front of the caravan.
- A wireless router is standard in all models.
- External antenna for the router is available as an option.
- Adjustable TV mount in several models.
- Wireless charger for mobile phones located in the front of the caravan (standard in Royal and Imperial).



Gas control

Convenient and safe gas handling.

- The gas compartment is integrated in the front of the caravan.
- Room for two gas tanks as well as luggage.
- The gas compartment has a frame on the bottom to keep everything in place when you open the access door.
- The gas compartment includes lighting, an exterior gas outlet for a grill and a leak indicator for manual control of the gas system.
- Removable fitted protective mat.

Unique comfort every day of the year

Manufacturing caravans for Scandinavia and the rest of Europe is a challenge of great proportions. The climate is extreme and can vary between hot and dry summer, humid and windy autumn to cold winter with lots of snow. This demands the very best in heating, insulation and ventilation, so that your caravan is both safe on the road and comfortable to live in year round. With more than 65 years of experience and our constant development, we can proudly say that every KABE caravan meets the tough requirements, and more.

All our caravans are built for maximum ventilation. The placement of the furniture and the well-thought-out design result in optimal air circulation. Our floor heating system provides even heat across the entire floor and KABE's patented wall construction provides the best possible indoor climate.

The technical solutions in our construction and our unique heating and ventilation solution Smart Climate System, make your KABE one of the best year-round caravans in the market. When you and your family are ready to leave, you can trust that all systems and equipment are carefully developed to withstand various types of challenges from the outside elements.

In Imperial, Alde zone heating system is included, which lets you control the heat in two separate zones – the back and the front of the caravan. The bathroom is always comfortably heated on the return loop.

NEWS! Dometic FreshJet FJX4 2200. In 2024, we upgrade the interior climate with the latest generation AC from Dometic. The new and efficient FreshJet FJX4 2200 is a ceiling-mounted air conditioning system with quiet and energy-efficient operation and an aerodynamic exterior design. The system can be controlled by remote control, the Dometic Climate app, the touch-panel on the inside of the AC or via the KABE Smart D panel. It also has a night mode with reduced fan speed and Clean Air technology that reduces bacteria and bad odours. Standard in Imperial, optional in other models.

Our goal is to make your winter vacation as comfortable as your summer vacation.

Find out more on the next page!



KABE Caravan heating systems

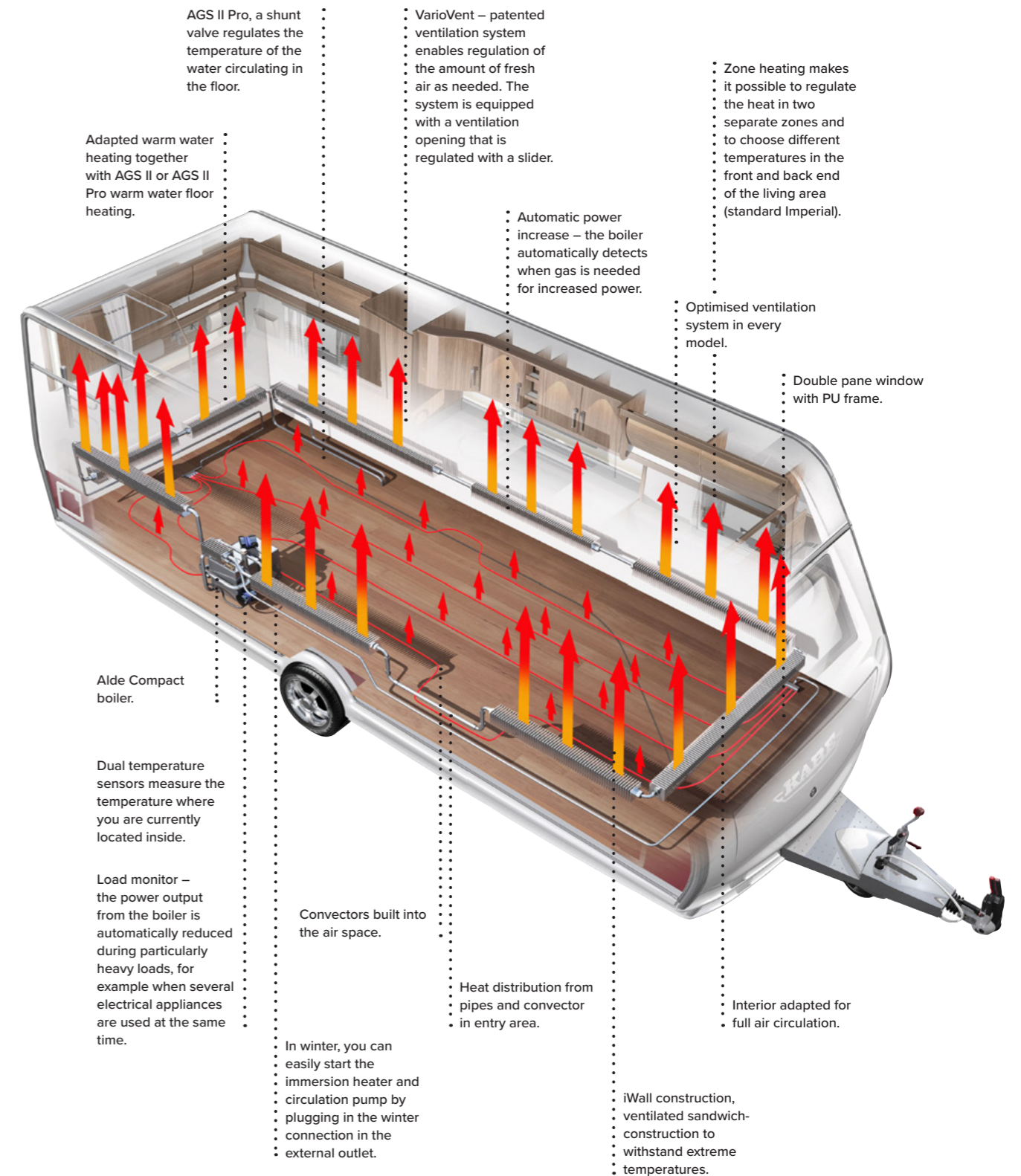

Warm in winter and cool in summer

SMART -CLIMATE+ SYSTEM

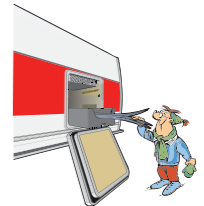
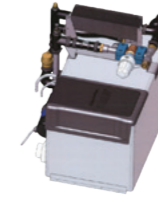
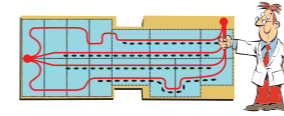
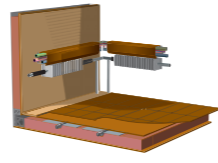

Intelligent heating system

Everything for your comfort! The following is always included in all KABE caravans:

- AGS II or AGS II Pro warm water floor heating.
- Maximized convector length and densely packed convectors.
- Optimized ventilation system.
- Interior adapted for full air circulation.
- iWall construction.
- ALDE Compact boiler.



Balanced heat distribution

KABE caravans are designed for the best possible heat distribution.

- KABE design allows the warm air to pass freely from the floor, under beds and sofas, and up to the ceiling through our ventilated upper cabinets.
- KABE has the market's best and most even heat distribution in the living area and in other spaces (wardrobes, bathrooms and upper cabinets).

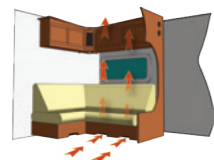

Ventilated sofas and beds

Sofas and beds are carefully spaced out. This creates an air space which enables full air circulation under all beds and bases.

- Sofa back rest and cable trays are angled to accelerate the airflow past the windows.
- The sofa back rest and the space by the bed are heated when warm air is distributed along the wall.

Central heating

The powerful heating system can withstand large temperature differences between outside and inside temperatures.

- Heating boiler ALDE Compact 3030 with a touchscreen display and an electric cartridge of 3 kW, and Propane gas operation with 5,5 kW (5500 W), for a total effect of 8,5 kW.
- The heating system has a 12 V circulation pump, integrated water heater and separate expansion tank.
- A cover is placed around the gas unit for the most efficient hot water effect.
- Roof vent in several models for maximum operational reliability.



Inner sheet metal in walls

The sheet behind the wall covering is heated by the indoor temperature and helps prevent condensation.

- KABE sandwich construction consists of outer sheet, ecoprime insulation, inner sheet and inside wall covering.
- The heat from the radiators advances up along the walls.
- The inner sheet in the wall distributes the heat evenly across the entire wall, whereas plywood walls, for example, do not conduct any heat at all.

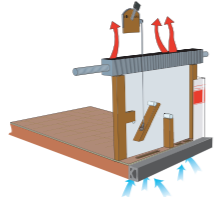

Optimised ventilation system – patented KABE VarioVent

With KABE VarioVent, you can easily regulate the air intake in the caravan.

- Our patented ventilation system enables regulation of the amount of fresh air as needed.
- The system is equipped with an air vent which is operated with a slider.

Integrated heating system

KABE's warm water system heats from the outside and in, so that walls, furniture and interior are heated as well.

- The floor heating system is connected to the convector system, which means that the air circulates throughout the entire caravan when the heat is turned on.
- The system is powered by both gas and electric.
- KABE is constructed with extra wide convectors under all windows to maintain maximum heat in the air so that any condensation is vented away from the windows.

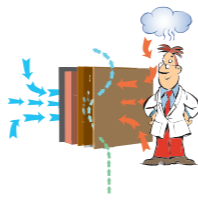

Ventilation in walls and floors

KABE's unique construction easily prevents moisture in the walls (especially winter time) and eliminates the risk of moisture damage.

- KABE is the only manufacturer to include a ventilating inside wall covering that allows the warm air circulating up the walls to pass through.
- Condensation on the floor is caught by the ventilating floor covering along the outer edge and is dried out when you turn on the heat.
- KABE's inside wall covering has a sound insulating effect.



Additional heating features

KABE's insulation in walls and windows keep you warm in winter and cool in summer.

- To avoid cold drafts, we take extra care with the insulation around fresh air intakes and heating convectors.
- The insulation contributes to optimal heat exchange.
- With double temperature sensors, one in the sleeping area and one in the front seating area, the heat can be adapted to where you are in the caravan.

Superior floor heating comfort

Comfortable and warm floors throughout the entire caravan!

- Our custom designed patent-pending automatic warm water floor heating system – AGS II – with four loops provides more even heat.
- The heat circulates in aluminium ducts that reach all the way to the front door, kitchen cabinets and bathroom.
- Heating plates distribute the heat evenly over the entire floor.

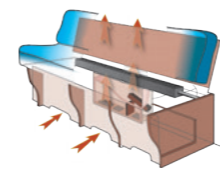

Optimal air flow

Ventilation and air flow are key to maximum living comfort in your caravan both in winter and summer.

- Our interior is adapted to provide optimal air flow throughout the caravan, even behind cabinets and sofas.
- The distance between sofas and beds and the angle of the sofa back rest are carefully calculated.



Automatic power increase

KABE's winter connection is very practical for parked caravans. Your caravan is heated on arrival and ready for the weekend's skiing adventure.

- The boiler automatically detects when gas is needed for increased power.
- In winter, simply start the electric cartridge and the circulation pump by switching on the winter connection. When you connect to electricity (230 V) via the exterior electrical outlet, the winter connection is activated at the preselected temperature.

AGS II Pro

Adjusts the heat according to your personal needs.

- With AGS II Pro (standard in Gemstone, Royal and Imperial), the floor heating can be operated separately.
- A shunt valve regulates the temperature of the water circulating in the floor.
- To reduce energy consumption, the system is interval controlled. The water circulates in the system during certain pre-set time periods, which reduces the energy consumption in the boiler and protects the battery at the same time.



Angled cable ducts

Efficient and energy-smart details.

- Maximum heat is absorbed from the convector and accelerates the airflow past the windows.
- Our unique cable ducts are angled to allow the air to flow freely past the windows.
- Electrical wiring, water and waste water pipes are hidden in the cable ducts.
- In winter, the construction quickly thaws residual water in the pipes.

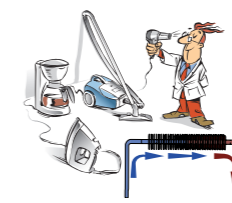

Load monitor

Helps you conserve electricity.

- The boiler's power consumption of electricity is automatically reduced during particularly heavy loads, for example when several electrical appliances are used at the same time.

SAFETY

All the time and in any situation

We want you to feel secure in your investment, so that you can fully enjoy your days off. Our caravans are built to the highest safety standard and thoroughly tested to optimise use and experience in every location and in all situations.



With safety in mind

We have great respect for the challenges you face on the road. Slippery, wet and rapid temperature changes are just a few examples. That's why we put a lot of resources into your safety. When you buy a KABE, we deliver a caravan built in one of Europe's most modern caravan factories, developed to make your drive as safe and comfortable as possible.

All KABE caravans are equipped with our proprietary KABE Safety Driving System. Our system makes it safer than ever to tow the caravan on the roads. KABE Safety Driving System includes, among other things, a chassis with a longer tow bar and an anti-roll axle. The Royal and Imperial models also include an electronically controlled anti-skid system. If the trailer starts to roll, the system detects it in a few thousandths of a second and stabilizes the car and caravan with immediate and gentle braking. A friction clutch has been the standard in all KABE caravans for a long time, together with premium tyres the caravan can withstand challenges on the road even a little better.

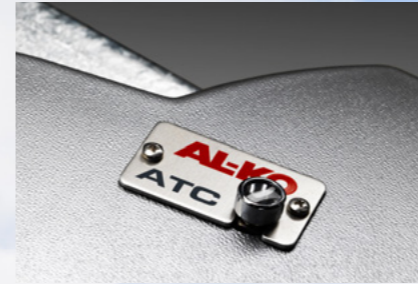

KABE Safety Driving System. Chassis with warm galvanized steel profile. Electronically controlled anti-skid system (not in Estate, available as an option for Gemstone) provides extra road safety. Axles that provide a comfortable and smooth drive. Longer, stabilizing tow bars.

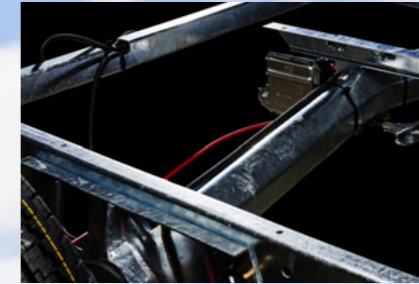

Extra rigid chassis. Extra beams between lengthwise chassis joists result in a more stable floor and an extra torsionally rigid chassis. Connecting beams provide the best stability possible. The chassis has outriggers from the lengthwise side beam, to relieve the weight pressure where the floor and walls are joined. The body can withstand very high loads, for example, large amounts of snow on the roof.



Tyres and clutch. Our single axle caravans feature premium tyres. 14" steel rims are standard in Estate and 15" aluminium rims are available as an option with the Design Package. 15" aluminium rims are standard in Gemstone and Royal and 17" Diamond Cut aluminium rims in Imperial (available as an option for Royal). All models include friction clutch.



CLIMATE CHAMBER

In the climate chamber, careful tests are carried out on the caravans.



-35 TO +55 DEGREES

Our caravans are tested in temperatures from -35 up to +55 degrees.

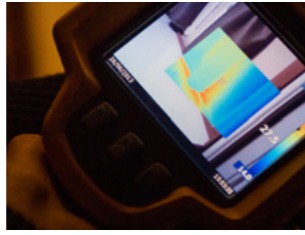

QUALITY

With the help of thermal cameras, we ensure that the construction delivers the quality we strive for.



COMPLETELY WATER PROOF

Advanced technology is used to check that the caravans are absolutely waterproof.



OPTIMISED WEIGHT DISTRIBUTION

Scales are used to balance and optimise the weight distribution between axles.



TOWING CAPACITY

Measuring equipment is used to check towing capacity.



DURABILITY

Pressure is used to test the strength of the caravans.



AIRFLOW

Airflows are carefully checked with smoke.



VENTILATION

Correct ventilation is vital and carefully tested.



GAS SYSTEM

The gas system is pressure tested.



ELECTRICAL SYSTEM

Electrical systems and other important functions are carefully checked before our caravans are allowed to leave the factory.



DURABILITY TEST

Durability tests are performed and simulated with equipment corresponding to 10,000 km of normal driving.



RAIN CHAMBER

In the rain chamber, the caravans are challenged with a high pressure sprayer.

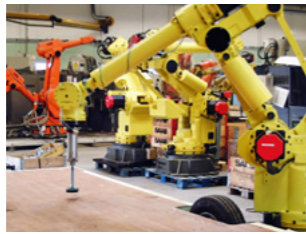

BODY ENDURANCE TEST

Endurance tests are performed on every part of the body.



MANUFACTURING

We use state-of-the-art technology to manufacture every caravan.

Built for the toughest tests

Nothing in a KABE is a coincidence. Everywhere you will find well-thought-out design combined with the highest quality in construction and materials.

To get there, we carry out extensive tests down to the smallest detail and function. Among other things, we have a climate chamber where the caravan is tested to withstand temperature differences of as much as 90 degrees. With our advanced technology, we check that the caravan is absolutely waterproof.

We also check endurance, durability, airflow, electrical systems and much more. It is a matter of KABE quality and safety that stand up to the tough tests.



10 strong reasons to choose KABE

YEAR-ROUND COMFORT

KABE caravans are designed for many different climates, to function as well during cold winters as hot summers. There are no shortcuts when it comes to insulation, ventilation and heating. For maximum stability and complete moisture control, the body is built with KABE's own iWall system. All models are equipped with the Alde 3030 boiler and warm water heating is standard. Many of the important year-round features are built into the design and may not be visible when you step into the caravan for the first time. But you will definitely notice the difference when get to know your KABE.

QUALITY

A caravan from KABE maintains the highest quality down to the smallest detail, and the models are developed from scratch in KABE's own development centre in Tenhult, Småland. KABE works continuously with product development and each new model year is characterized by several interesting innovations. We constantly design and test new solutions in our own development centre and every single caravan is built in our own factory, which is one of Europe's most modern. We have skilled employees, our own electricians, a carpentry shop and a modern machine department. And our subcontractors are among Europe's leaders in their various fields.

RESALE VALUE

No matter which model you choose, you can be sure your KABE represents the best quality in the market and every price segment. Much of what is standard in a KABE, you have to pay extra for from other manufacturers. It is a matter of quality and function that lasts. You can feel confident that the value of your KABE will hold up well in the future.



TECHNOLOGY

Your new KABE always includes cutting edge technology and it is one of the most well-equipped caravans in the market. At KABE, we think ahead and put lots of time and effort into preparing for future challenges with new solutions and technology development. In recent years, we have received several prestigious awards for our innovations, including ventilation and heat recovery. We do everything possible for the most comfortable experience on the road. So, before you start comparing prices – find out what is actually included in your KABE.

DESIGN

Our modern and spacious interior in light colours and materials, is truly Scandinavian design at it's best. You will find well-thought-out details such as recessed cabinet doors, rounded corners and ergonomically designed seat cushions. All materials are made with high quality and the result is that special KABE feeling, where superior design and function always go hand in hand. The exterior is characterized by timeless, elegant lines and graphics that give each KABE its distinctive character.

FUNCTIONALITY

With more than 65 years of experience, KABE develops and builds caravans for active, year-round use. Your KABE includes many smart solutions for a KABE lifestyle that is as convenient and relaxing as you like. Some examples are the practical ski storage with lighting, central locks for kitchen drawers or a USB outlet that is placed exactly where you need it.

CLIMATE AND ENVIRONMENT

At KABE, environmental issues are top priority and we are committed all the way – from material selection and production technology to energy values and emission levels. We want to lead the development towards an even more climate- and environmentally adapted caravan industry. Naturally, we stand behind UN's global goals for sustainable development, good working conditions, increased diversity and equality, and to maintain a high standard in business ethics.

SAFETY

When you buy a KABE you invest in safety. We want you to feel secure in your investment and fully enjoy the days in your caravan. Our dealers include a 7-year warranty on water infiltration with all new models. Your safety on the road is extremely important to us. Our caravans are equipped with several active safety systems. And in case of an accident, your KABE has well-developed passive safety systems that protect you in a collision.

AUTHORISED DEALERS

KABE has a wide network of authorised dealers and service stations, not only throughout Scandinavia, but in several European countries as well. They provide expert advice and help you with financing and insurance for your KABE. And once you are on the road, we have more than 100 authorised service stations in northern Europe. You will always find professional help, should you need it. Many have worked with us for decades. You are in safe hands!

OPTIONS

There is a KABE for everyone. It's just a matter of figuring out which size, model, equipment and price range is right for you and your family. When you find your favourite model, you can select your optimal floor plan with KABE's Flexline System. There are many options and great flexibility. With our online product configuration system, building your KABE is easy. Choose "Build your KABE" on our home page www.kabe.se/en, or visit one of our dealers.

2024 MODEL PROGRAM

Find your favourite!

We have developed four model series, each with its unique features, to fit the different needs of our KABE-owners. There is always a perfect KABE. Whether you choose a slightly smaller caravan or a larger model, you can be sure it includes year-round-comfort, excellent quality, safety and lots of smart solutions.

KABE series and models:



ESTATE

Our entry-level model with KABE quality all the way.



GEMSTONE

Built for those with high demands on equipment and comfort.



ROYAL / ROYAL HACIENDA

Our Royal models are at the forefront of technology with superior equipment.



IMPERIAL

A series of caravans in the absolute premium segment.

ESTATE	GEMSTONE	ROYAL / ROYAL HACIENDA	IMPERIAL
Estate 470 XL	Brijant 470 XL		
Estate 470 GLE			
Estate 520 XL	Smaragd 520 XL	Royal 520 XL	
	Smaragd 540 GLE	Royal 540 GLE	
	Ametist 560 XL	Royal 560 XL	Imperial 560 XL
Estate 560 GLE	Ametist 560 GLE	Royal 560 GLE	
		Royal 600 XL	Imperial 600 XL
		Royal 600 CXL	Imperial 600 CXL
Estate 600 TDL	Safir 600 TDL	Royal 600 TDL	
Estate 600 GLE	Safir 600 GLE	Royal 600 GLE	
Estate 600 GDL	Onyx 630 TDL	Royal 630 TDL	Imperial 630 TDL
		Royal 630 TDL FK	Imperial 630 TDL FK
	Onyx 630 GLE	Royal 630 GLE	
Estate 660 DGDL			
		Royal 740 TDL	Imperial 740 TDL
		Royal 740 CTDL	Imperial 740 CTDL
Estate 780 DGDL		Royal 780 TDL	Imperial 780 TDL
		Royal 780 TDL FK	Imperial 780 TDL FK
Estate 780 BGXL		Royal 780 BGXL	Imperial 780 DGLE
		Royal Hacienda 880 TDL	Imperial 880 TDL
		Royal Hacienda 880 TDL FK	Imperial 880 TDL FK
		Royal Hacienda 880 BTDL	Imperial 880 BTDL
		Royal Hacienda 880 DTDL	Imperial 880 DTDL
		Royal Hacienda 880 GLE	Imperial 880 GLE
		Royal Hacienda 1000 TDL	Imperial 1000 TDL

KABE FLEXLINE

Your personal floor plan

With KABE Flexline, you can choose a caravan and floor plan that suits your personal requirements. Create your dream-KABE in peace and quiet at your computer. You can easily view all available options and possibilities with KABE's flexible configuration tool at www.kabe.se/en. A summary of your caravan will be presented, including price and contact information for the nearest dealer.

Choose floor plan in 4 easy steps:

1. SELECT MODEL AND LENGTH

Our caravans are available in 4 model series.

Model	Interior length
Estate	473-720 cm
Gemstone	473-630 cm
Royal / Hacienda	522-940 cm
Imperial	550-940 cm

2. SELECT WIDTH

Our caravans are manufactured in two widths.

Model	Interior width
Standard	215 cm
King size	235 cm

3. CHOOSE BETWEEN 3 FLOOR PLANS

GLE: Bathroom and shower are placed along the side in the middle of the caravan.

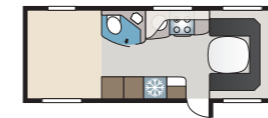

XL: Bathroom and shower (walk-in shower in DXL) are placed in the rear corner.

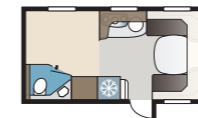

TDL: Bathroom with a separate walk-in shower spans the entire width of the rear of the caravan.

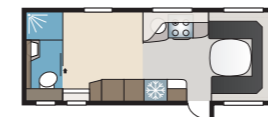

4. CHOOSE BETWEEN 12 FLEXLINE OPTIONS

GLE

Select a floor plan...

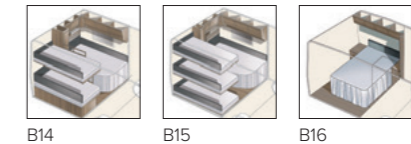
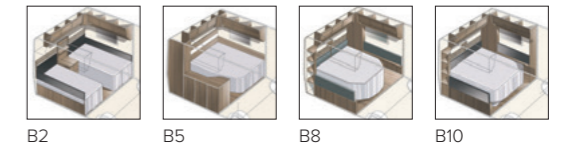

XL

Select floor plan...

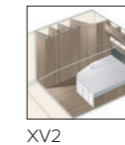

TDL

Select a floor plan...

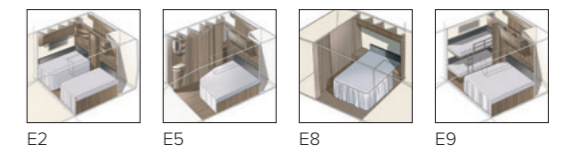

In addition, there are many additional models and options for your family with bunk beds!

2024 standard equipment	Estate	Gemstone	Royal Royal Hacienda	Imperial
BODY				
14" steel rims	✓			
15" grey aluminium rims		✓	✓	
17" Diamond Cut aluminium rims				✓
AL-KO fully galvanised steel profile chassis with self adjusting brakes		✓	✓	✓
Storage access door (not in B8, B10)			✓	✓
Decals in the lower front air intakes			✓	✓
Continental tyres (not in Estate except 2000 kg chassis)		✓	✓	✓
36 mm Ecoprim-insulation (floors, ceilings and walls)	✓	✓	✓	✓
Electronic stabilisation system, ATC (anti-skid system)			✓	✓
Exclusive body with all-round integrated profile		✓	✓	✓
Fitted protective mat in the gas compartment		✓	✓	✓
Window in front door			✓	✓
Extended tow bar	✓	✓	✓	✓
Knott chassis with self adjusting brakes	✓			
Anti-lurch friction clutch	✓	✓	✓	✓
Kitchen window	✓	✓	✓	✓
Lighting along the entire exterior entry side			✓	
Medium-tinted windows with screens and black-out shades	✓	✓	✓	✓
Unique "soft" ceiling design	✓	✓	✓	✓
Screen door	✓	✓	✓	✓
Plastic beams	✓	✓	✓	✓
Inertia brake with automatic reverse	✓	✓	✓	✓
Sandwich-construction	✓	✓	✓	✓
Pull-out ski storage with exterior lock and lighting	✓	✓	✓	✓
Smooth exterior panels with decal graphics	✓			
Smooth exterior panels with printed graphics		✓	✓	
Innovation Design smooth exterior panels with graphics				✓
Sturdy and waterproof body	✓	✓	✓	✓
Mud guards behind wheels	✓	✓	✓	✓
Skylight 40x40	✓	✓	✓	✓
Heki II skylight			✓	
Heki De Lux skylight				✓
Total weight 2000 kg / 2650 kg				✓
Tow-bar cover		✓	✓	✓
Integrated, full width gas compartment with lighting	✓	✓	✓	✓
Mini Heki roof vent with screen and black-out shade	✓	✓	✓	✓
Ventilating inside wall covering	✓	✓	✓	✓
Front door (Seitz) with integrated screen and threshold heat	✓	✓		
Front door (Seitz) with a window, integrated screen and threshold heat			✓	✓
Front window that opens		✓	✓	✓

KABE will not be held liable for printing errors and typos. KABE reserves the right to design and data updates without prior notice.

2024 standard equipment	Estate	Gemstone	Royal Royal Hacienda	Imperial
CLIMATE / HEATING				
12 V circulation pump / 230 V, 3 kW, 3-step electric cartridge	✓	✓	✓	✓
Air conditioner FreshJet FJX4 2200				✓
Alde Compact 3030 central heating with touchscreen for clock, indoor and outdoor temperatures	✓	✓	✓	✓
Automatic warm water floor heating system – 4 loops (AGS II)	✓			
Automatic warm water floor heating system – 4 loops and shunt system (AGS II Pro)		✓	✓	✓
Load monitor that automatically reduces or disconnects the boiler's power consumption		✓	✓	✓
Dual temperature sensors		✓	✓	✓
Optimised ventilation system	✓	✓	✓	✓
Drying cabinet with drip tray and ventilation that can be closed (available in several models)	✓	✓	✓	✓
Heated shoe compartment		✓	✓	✓
VarioVent – unique ventilation system		✓	✓	✓
Air vent	✓	✓	✓	✓
Alde zone heating				✓
KITCHEN				
Nussbaum Ombre kitchen counter with a 3-burner gas stove	✓			
Atlas Zeder kitchen counter with a 3-burner gas stove and a split glass cover		✓		
Atlas Zeder kitchen counter with 3-burner gas stove, an electric burner and built-in oven (not in 540 / 560 GLE)			✓	
Atlas Zeder kitchen counter with an induction stove top with 2 gas burners and a built-in oven				✓
Chrome handles with a gloss finish		✓	✓	✓
Single handle kitchen and bathroom faucet	✓	✓	✓	✓
Recessed drawers		✓	✓	✓
Interior wastewater tank	✓	✓	✓	✓
KABE AutoDrain (automatic emptying of the water system)				✓
230 V / 12 V / gas refrigerator: 122 litre volume, 12 litre freezer (133 litre in Estate 470 GLE with freezer)	✓	✓		
230 V / 12 V / gas refrigerator: 177 litre volume, 35 litre freezer			✓	✓
Black high gloss refrigerator front	✓			
Atlas Zeder refrigerator front (small refrigerator in black)		✓		
Bronze coloured refrigerator front			✓	✓
Motorised kitchen fan with grease filter and lighting	✓	✓	✓	✓
Kitchen sink lid	✓	✓	✓	✓
Microwave below the fridge				✓
Optimised refrigerator ventilation	✓	✓	✓	✓
Plexiglas with lighting by the kitchen backsplash		✓	✓	✓
Soft-close kitchen drawers	✓	✓	✓	✓
32 litre wastewater tank (built-in with external wastewater bag)	✓	✓	✓	✓
Stove with electric ignition	✓	✓	✓	✓
Black handles	✓			
Moulding with two hooks above the kitchen counter		✓	✓	✓
40 litre water tank with external filling	✓	✓	✓	✓
BATHROOM				
Connection for outdoor shower / hot and cold water			✓	✓
Automatic water system / water heater	✓	✓	✓	✓
Walk-in shower / Shower stall with a hand shower / Shower curtain and bar	✓	✓	✓	✓
Heated towel rack (with a timer in some models)			✓	✓
Urban Style bathroom countertop (faux stone look)	✓	✓		
Light Concrete bathroom countertop (light concrete look)			✓	✓
Fixed swivel flush toilet with external emptying	✓	✓	✓	
Fixed swivel flush toilet with ceramic bowl and external emptying				✓

2024 standard equipment	Estate	Gemstone	Royal Royal Hacienda	Imperial
LIVING ROOM				
2 fabric collections (Amarillo, Fontana)	✓			
3 fabric collections (Fremont, Ontario, Tulsa)		✓	✓	✓
2 leather collections (Baltimore, Hollywood) and one in artificial leather (Lancaster) – surcharge			✓	
2 leather collections (Baltimore, Hollywood) and one in artificial leather (Lancaster)				✓
Anti-slip fabric on underside of cushions	✓	✓	✓	✓
Bar cabinet with tinted plexiglas and bottle storage from the side		✓	✓	✓
Ergonomic seat cushions	✓	✓	✓	✓
Exclusive upper cabinet doors		✓	✓	✓
Curtain set with a lighting	✓			
Curtain set with a valance		✓	✓	✓
Soft-close upper cabinet doors	✓	✓	✓	✓
Superior quality carpentry	✓	✓	✓	✓
Shelves in the front corners		✓	✓	✓
Indirect lighting underside of upper cabinets		✓	✓	✓
Nussbaum Ombre interior	✓			
Atlas Zeder interior		✓	✓	✓
Coordinating floor covering	✓	✓	✓	✓
Head rest with adjustable height and side-to-side (option for Estate and Gemstone Comfort Package)			✓	✓
Upper kitchen cabinet doors in Grau with wood trim and a black accent stripe	✓			
Upper kitchen cabinet doors in Atlas Zeder		✓		
Upper kitchen cabinet doors in Cashmere			✓	
Upper kitchen cabinet doors in Sabbia High Gloss				✓
Premium Foam cushions		✓	✓	✓
Accent pillows (Estate in the front seating area)	✓	✓	✓	✓
Slide-out sofa				✓
Grau ceiling light with wood trim	✓			
Ceiling light covered in faux suede (as well as light fixture in the front of FK-models)		✓	✓	✓
Adjustable sofa	✓	✓	✓	✓
Pull-out table extension (not for wall mounted table)		✓	✓	✓
Upper cabinet doors in the front and rear – Grau (Estate has Grau doors with wood trim and a black accent stripe)	✓	✓		
Upper cabinet doors in the front and rear – Cashmere			✓	✓
BEDROOM				
Bed frame in wood with edge profile	✓			
Aluminium bed frame		✓	✓	✓
Draperies	✓			
Extra base in under bed storage compartment	✓	✓	✓	✓
12 cm spring mattress + 3 cm top pad (not in bunk beds / loft beds)	✓			
12 cm spring mattress + 6 cm top pad (not in bunk beds / loft beds)		✓	✓	✓
Headboard – upholstered in faux suede	✓	✓	✓	✓
Wire shelves in wardrobe		✓	✓	✓
Adjustable headboard		✓	✓	
Electric adjustable headboard (not in E9 bed)				✓

2024 standard equipment	Estate	Gemstone	Royal Royal Hacienda	Imperial
ELECTRICITY / TECHNOLOGY				
12 V connection with 13-pin connector, system Jäger	✓	✓	✓	✓
230 V outlet windowsill	✓	✓	✓	✓
80 Ah battery	✓	✓	✓	✓
35 A battery charger	✓	✓		
25 A battery charger			✓	✓
Gas compartment lighting	✓	✓	✓	✓
Ski storage lighting	✓	✓	✓	✓
Smoke detector	✓	✓	✓	✓
Dimmer front ceiling light	✓	✓	✓	✓
Dimmer light fixture by front seating area		✓	✓	✓
Dimmer kitchen mood lighting		✓	✓	✓
Electrical box: 230 V / 12 V exterior outlet, central antenna connection, 230 V indicator		✓		
Electrical box: 230 V / 12 V exterior outlet, central antenna connection, 230 V indicator and light switch			✓	✓
Switchboard: 230 V, 16 A with circuit breakers	✓	✓	✓	✓
Prepared for rear speakers	✓	✓		
Awning lighting (LED) in aluminium profile		✓	✓	
Wardrobe lights and lights in under bed storage compartment		✓	✓	✓
Front speakers	✓	✓		
Front and rear speakers (and subwoofer in Royal)			✓	✓
Indirect lighting rear upper cabinets (no dimmer in Estate)	✓	✓	✓	✓
Ground fault circuit breaker	✓	✓	✓	✓
KABE Premium Sound System with DAB				✓
KABE VarioVent		✓	✓	✓
LED in all lights	✓	✓	✓	✓
Neonflex LED lighting on both sides of the refrigerator		✓	✓	✓
Lighting in windows	✓	✓	✓	✓
Gas leak indicator	✓	✓	✓	✓
Reading lights – Estate matte black, Gemstone and Royal chrome, Imperial black-chrome	✓	✓	✓	✓
Multimedia player with DAB			✓	
Night lights		✓	✓	✓
Radio	✓	✓		
Router	✓	✓	✓	✓
Service centre with a control panel	✓	✓	✓	✓
Smart D electrical system			✓	✓
Smart Level (gas level and tyre pressure sensor, level indicator)				✓
Wireless charger for mobile phones			✓	✓
TV antenna with booster	✓	✓	✓	✓
TV mount	✓	✓	✓	✓
USB in bunk beds	✓	✓	✓	✓
Exterior 230 V / 12 V outlet	✓	✓	✓	✓
ADDITIONAL EQUIPMENT				
Waste bin with source sorting	✓	✓	✓	✓
Central vacuum cleaner			✓	✓
Uniform locking system, one key for all locks	✓	✓	✓	✓
Entry area wardrobe (in certain models)	✓	✓	✓	✓
Water tank cover with locking	✓	✓	✓	✓
Exterior gas connection for grill located in the gas compartment		✓	✓	✓

KABE Estate

KABE Estate is our well-equipped starter series, perfect for the first-time buyer who is looking for a convenient travel caravan, or for the family with small children. Estate is available in a number of sizes with all of KABE's built-in values such as top quality and reliable year-round features. It's an affordable alternative in contemporary design.

10 models – 17 floor plans



Estate 470 XL



Estate 470 GLE



Estate 520 XL



Estate 560 GLE



Estate 600 GLE



Estate 600 GDL



Estate 600 TDL



Estate 660 DGDL



Estate 780 DGDL



Estate 780 BGXL



Standard equipment in all KABE caravans:

- ▶ KABE iWall, solid body equipped to manage extreme temperatures
- ▶ Knott chassis with self adjusting brakes (Estate only)
- ▶ Smooth exterior panels and decal set with a 3D look (Estate only)
- ▶ Screen door
- ▶ Skylight 40x40
- ▶ Pull-out ski storage with lock and lighting
- ▶ Mud guards
- ▶ Insulated double pane windows
- ▶ Interior designed for optimal air circulation
- ▶ Maximum amount of heating convectors for warm water heating system
- ▶ Optimised ventilation system – equally efficient airflow on cold and warm days
- ▶ Drying cabinet with drip tray and ventilation
- ▶ AGS II – warm water floor heating with Alde Compact boiler
- ▶ Air vent
- ▶ 3-burner gas stove with electric ignition
- ▶ Motorised kitchen fan with grease filter and lighting
- ▶ Soft-close kitchen drawers
- ▶ Sink cover
- ▶ Two fabric collections to choose from with anti-slip on the underside
- ▶ Ergonomic seat cushions
- ▶ Interior with superior materials from our own carpentry
- ▶ Bedside magazine pocket
- ▶ Faux suede headboard, spring mattress with top pad and bedspread
- ▶ Smoke detector and ground fault circuit breaker
- ▶ DAB radio
- ▶ Gas leak indicator
- ▶ Lots of LED-lighting, dimmer for the front ceiling light
- ▶ Router
- ▶ USB in bunk beds
- ▶ Waste bin with source sorting
- ▶ Water tank cover with lock

...and much, much more! See our Estate options on page 58.

Updates! New design for the upper cabinets and new doors in Grau with wood trim and a modern black stripe!

- ▶ Two new fabric collections with new curtains
- ▶ New design interior roof vent



- ▷ **Wood laminate:** Nussbaum Ombre
- ▷ **Floor covering:** Dark
- ▷ **Upper cabinet doors front/back:** Grau with wood trim and a black accent stripe
- ▷ **Kitchen cabinet doors:** Grau with wood trim and a black accent stripe
- ▷ **Kitchen counter top and back splash:** Elero laminate, Perla on the wall
- ▷ **Table and entry area counter top:** Perla laminate with a wood edge
- ▷ **Counter top:** Perla laminate
- ▷ **Bathroom counter top:** Urban Style laminate
- ▷ **Bathroom cabinet doors:** Nussbaum Ombre
- ▷ **Wardrobe doors (bedroom):** Grau with wood trim
- ▷ **Fabric collections:** Amarillo (dark brown) and Fontana (beige)

KABE Estate 2024

Many families have found their favourite caravan in the modern Estate series, which was introduced in model year 2022. KABE Estate is available with a range of children's bedroom solutions in several different lengths. Each family can find a size and floor plan that is right for their specific requirements. In addition, Estate is available as a slightly smaller caravan, for those who want to travel light but with access to KABE's unique advantages.

KABE Estate has a bright and modern design throughout with large windows in the kitchen and living room. New upper cabinets and doors with wood trim in the new light shade Grau, are accented with the darker wood laminate Nussbaum Ombre. The counter top in the kitchen area has straight corners and you will find exciting details such as handles, switches and faucets in matt black.

As in all KABE caravans, the kitchen is well equipped with lots of storage options. With a cover for the sink, you get a larger continuous surface. The Elero counter top has a stylish stone imitation. Back splash and tables feature the new shade Perla.

The lighting in Estate is designed to create a cosy and inviting feeling, with indirect mood lighting along the ceiling and under the cabinets. The ceiling light is finished in Grau with contrasting wood trim.

The bed is covered in imitation suede and includes a very comfortable mattress for a good night's sleep as well as invites you to relaxing reading or listening moments. Cosy and stylish at the same time.

The design naturally follows through to the bathroom. The Urban Style counter top has a modern faux stone look and details such as the faucet and towel rack are matte black, just like in the kitchen. Shower curtain and rod are included.

Choose from two new fabric collections – dark brown Amarillo and Fontana in beige.

Model year 2023, we updated all Estate models with a new practical electrical system with a touch-panel.

On the outside, Estate has a stylish smooth exterior and decal graphics with a 3D-look. The window frames are black as is the air vent. KABE Estate is built on a Knott chassis with self-adjusting brakes.



Estate 470 XL

The smallest of KABE's Estate models. KABE Estate 470 is the perfect choice for one or two!

TECHNICAL SPECIFICATION	
Overall length	687 cm
Overall height	278 cm
Overall width Std.	230 cm
Overall width KS	250 cm
Body length	558 cm
Interior body length	473 cm
Interior height	196 cm
Interior width Std.	215 cm
Interior width KS	235 cm
Living area Std.	10,2 m ²
Living area KS	11,1 m ²
Bed space Std. – Front	205 x 156/124 cm
Rear XV2	196 x 129/102 cm
Bed space KS – Front	225 x 156/124 cm
Rear XV2	196 x 140/118 cm

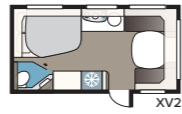

Estate 470 GLE

Since 2023, KABE Estate 470 GLE-solution is available with two single beds. Our Estate caravan with B2-floor plan and standard width (no loft bed cabinet). Grand Lit is available as an option. In the kitchen area an elegant slim refrigerator is included and in the bathroom you will find our sideways installed toilet. Compressor refrigerator is available as an option.

TECHNICAL SPECIFICATION	
Overall length	687 cm
Overall height	278 cm
Overall width Std.	230 cm
Body length	558 cm
Interior body length	473 cm
Interior height	196 cm
Interior width Std.	215 cm
Living area Std.	10,2 m ²
Bed space Std. – Front	205 x 115/103 cm
Rear B2	196 x 78 + 186 x 78 cm

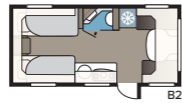

Estate 520 XL

KABE Estate 520 is loaded with all the basics for a comfortable and functional vacation. Any time of the year.

TECHNICAL SPECIFICATION	
Overall length	736 cm
Overall height	278 cm
Overall width Std.	230 cm
Overall width KS	250 cm
Body length	606 cm
Interior body length	522 cm
Interior height	196 cm
Interior width Std.	215 cm
Interior width KS	235 cm
Living area Std.	11,2 m ²
Living area KS	12,3 m ²
Bed space Std. – Front	205 x 166/127 cm
Rear XV2	196 x 129/102 cm
Bed space KS – Front	225 x 166/127 cm
Rear XV2	196 x 140/118 cm

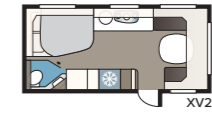

Estate 560 GLE

KABE Estate 560 GLE is available in a number of layouts, with single beds or bunk beds. Your family's size and needs determine which one is best for you.

TECHNICAL SPECIFICATION	
Overall length	774 cm
Overall height	278 cm
Overall width Std.	230 cm
Overall width KS	250 cm
Body length	644 cm
Interior body length	560 cm
Interior height	196 cm
Interior width Std.	215 cm
Interior width KS	235 cm
Living area Std.	12,0m ²
Living area KS	13,2 m ²
Bed space Std. – Front	205 x 146/137 cm
Rear B2	2 x 196 x 78 cm
B14	196 x 129/102 + 2 x 196 x 68 cm
B15	196 x 129/102 + 188 x 63 + 2 x 196 x 68 cm
Bed space KS – Front	225 x 146/137 cm
Rear B2	2 x 196 x 88 cm
B14	196 x 129/102 + 2 x 196 x 68 cm
B15	196 x 129/102 + 188 x 63 + 2 x 196 x 68 cm

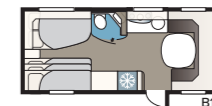
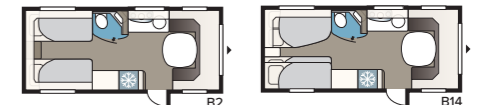



Estate 600 GLE

A smart solution for your family, featuring a double bed and a bunk bed for two or three. From 2021, we also offer floor plan B2 with two single beds.

TECHNICAL SPECIFICATION	
Overall length	814 cm
Overall height	278 cm
Overall width KS	250 cm
Body length	684 cm
Interior body length	600 cm
Interior height	196 cm
Interior width KS	235 cm
Living area KS	14,1 m ²
Bed space KS – Front	225 x 169/148 cm
Rear B2	2 x 196 x 88 cm
B14	196 x 129/102 + 2 x 196 x 68 cm
B15	196 x 129/102 + 188 x 63 + 2 x 196 x 68 cm

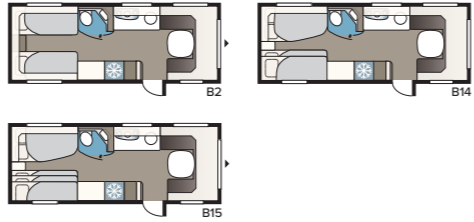

Estate 600 GDL

KABE Estate 600 GDL is designed with your children in mind. This model features a bunk bed for two or three. A smart entry model for your family.

TECHNICAL SPECIFICATION	
Overall length	814 cm
Overall height	278 cm
Overall width KS	250 cm
Body length	684 cm
Interior body length	600 cm
Interior height	196 cm
Interior width KS	235 cm
Living area KS	14,1 m ²
Bed space KS – Front	196 x 140/118 cm
Rear double bunkbed	2 x 196 x 77 cm
Triple bunkbed (option)	2 x 196 x 77 + 188 x 71 cm



Estate 600 TDL

Our Estate 600 TDL floor plan offers a large bathroom with a walk-in shower, spanning the entire width of the rear of the caravan and two single beds in the bedroom area.

TECHNICAL SPECIFICATION	
Overall length	814 cm
Overall height	278 cm
Overall width KS	250 cm
Body length	684 cm
Interior body length	600 cm
Interior height	196 cm
Interior width KS	235 cm
Living area KS	14,1 m ²
Bed space KS – Front	225 x 166/136 cm
Rear E2	196 x 88 + 186 x 88 cm

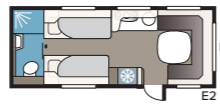

Estate 660 DGDL

KABE Estate 660 DGDL was developed with the young family's needs in mind. A children's bedroom area in the back of the caravan can be separated from the living area with drapery. A bathroom with a shower is located in the rear as well.

TECHNICAL SPECIFICATION	
Overall length	874 cm
Overall height	278 cm
Overall width KS	250 cm
Body length	744 cm
Interior body length	660 cm
Interior height	196 cm
Interior width KS	235 cm
Living area KS	15,5 m ²
Bed space KS – Front	225 x 143/159 cm
Rear double bed	196 x 140/118 cm
Rear double bunkbed	2 x 179 x 68 cm
Triple bunkbed (option)	2 x 179 x 68 + 173 x 65 cm
Dinette	173 x 50 cm

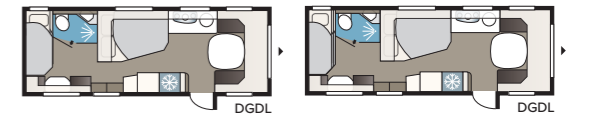

Estate 780 DGDL

A true family model with a large children's bedroom area in the back of the caravan that features an L-shaped sofa for the little ones. This caravan offers plenty of wardrobes and storage space and a bathroom with a shower.

TECHNICAL SPECIFICATION	
Overall length	935 cm
Overall height	278 cm
Overall width KS	250 cm
Body length	805 cm
Interior body length	720 cm
Interior height	196 cm
Interior width KS	235 cm
Living area KS	16,9 m ²
Bed space KS – Front	227 x 147/138 cm
Rear double bed	196 x 140/118 cm
Rear double bunkbed	2 x 196 x 68 cm
Triple bunkbed (option)	2 x 196 x 68 + 196 x 62 cm



Estate 780 BGXL

Estate 780 BGXL is the perfect choice for the large family with small children and this model offers lots of comfortable features. No surprise this model quickly has become popular in the Royal-series! As of 2023, it is also available in our Estate-series.

TECHNICAL SPECIFICATION	
Overall length	935 cm
Overall height	278 cm
Overall width KS	250 cm
Body length	805 cm
Interior body length	720 cm
Interior height	196 cm
Interior width KS	235 cm
Living area KS	16,9 m ²
Bed space KS – Front	225 x 165/136 cm
Dinette	191 x 88 cm
Rear XV2	196 x 140/118 + 2 x 196 x 68 cm

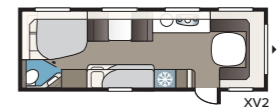

Options for Estate

Customise your KABE to your personal style. KABE Estate is the perfect beginner caravan. A smart and economical lifestyle with KABE quality and good basic equipment. If you wish for that little extra, to make life even more convenient, we offer a range of in-demand options. These are added in the factory prior to delivery of your caravan. Your dealer can always add more options at a later time.

COMFORT PACKAGE



Large refrigerator (not for 470 GLE) Compressor refrigerator Head rest Storage access (not in 660, 780 D GDL) Heated towel rack

DESIGN PACKAGE



15" aluminium rims Entrance door window Tow bar cover Heki II skylight

ADDITIONAL OPTIONS



Microwave under the fridge (470 GLE in lower kitchen cabinets) Oven Large refrigerator and freezer (not for 470 GLE) Compressor refrigerator

ADDITIONAL OPTIONS

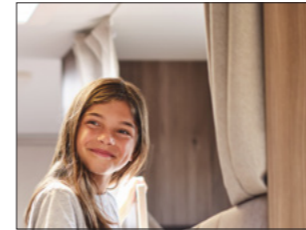

Bunk bed drapery (specific models)



Shelves in upper cabinets, side and rear (standard in front cabinets)



Grand Lit B2 (only for GLE models)

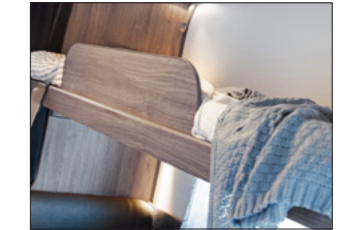

Loft bed cabinet (only certain bedroom solutions and middle dinette)



NEW! Dometic Fresh Jet FJX4 2200 air conditioner



External antenna for router



Storage access



Electric step



Duocontrol. Duocontrol has a built-in automatic gas switch, reduction valve and collision sensor which is triggered on impact with a G-force of 3.5 G. The supply of gas is shut off immediately to avoid a gas leak. Duo Control is approved in all of Europe and allows for the gas to be on while driving.



Direct drain – wastewater bypass tank



City water

- Total weight:
- 1700 kg – Std. (standard with 470 XL KS)
 - 2000 kg – Std. (not for 470)
 - 2000 kg – KS (standard for 600, 660)
 - 2650 kg (only for 780)

KABE Gemstone

The Gemstone series is one of our best selling caravan series. It's designed for everyone with high demands on basic equipment and comfort. Spacious or compact caravan? Flexible interior design or extra light construction? Regardless of your family's needs and taste, there is a Gemstone that can be adapted to suit you.

9 models – 22 floor plans



Brillant 470 XL



Smaragd 520 XL



Smaragd 540 GLE



Ametist 560 XL



Ametist 560 GLE



Safir 600 TDL



Safir 600 GLE



Onyx 630 GLE



Onyx 630 TDL



Standard equipment

In addition to the standard equipment included in Estate on page 51, KABE Gemstone also includes the following:

- ▶ AL-KO fully galvanized steel profile chassis with self-adjusting brakes
- ▶ 15" aluminium rims
- ▶ Continental tyres
- ▶ Body with all-round integrated profile
- ▶ Fitted protective mat in the gas compartment
- ▶ Smooth exterior panels with printed graphics
- ▶ Tow bar cover
- ▶ Front window that opens
- ▶ Load monitor automatically reduces the boiler's electric consumption
- ▶ Dual temperature sensors
- ▶ Warm water floor heating with a shunt system – AGS II Pro
- ▶ Heated shoe compartment
- ▶ Recessed drawers
- ▶ Plexiglas with lighting by the kitchen counter
- ▶ Moulding with two practical hooks above the kitchen counter
- ▶ Three fabric collections to choose from with Premium Foam cushions
- ▶ Curtains set with a valance
- ▶ Corner shelf in the front
- ▶ Indirect lighting under upper cabinets
- ▶ Accent pillows
- ▶ Faux suede covered ceiling light
- ▶ Dining table with an extension
- ▶ Aluminium bed frame and adjustable bed
- ▶ Dimmer for the light fixture in front and kitchen mood lighting
- ▶ KABE VarioVent – unique ventilation system
- ▶ LED-lighting by the refrigerator – Neonflex
- ▶ Night lights
- ▶ Outside gas connection for a grill in the gas compartment

See our options on page 67.



Updates! New chassis with a total weight of 2300 kg for single axle models with 600-630 length!

- ▶ New design exterior graphics
- ▶ B8 floor plans in the following GLE-models: Ametist 560, Safir 600 and Onyx 630
- ▶ New design for the upper cabinets with new lighting
- ▶ New kitchen faucet with a metal handle
- ▶ New black air vent in the bedroom
- ▶ Three new fabric collections with new curtains
- ▶ New design for interior roof vent
- ▶ 12 V main switch moved for access from the ski storage
- ▶ New AC – Dometic Fresh Jet FJX4 2200 (option)
- ▶ Mirror-image bathroom and shower available as an option for Safir 600 TDL and Onyx 630 TDL, E2 or E8 floor plan

- ▷ Wood laminate: Atlas Zeder
- ▷ Floor covering: Light
- ▷ Upper cabinet doors front/back: Grau
- ▷ Kitchen cabinet doors: Atlas Zeder
- ▷ Kitchen counter top and back splash: Perla laminate
- ▷ Table and counter top: Perla laminate
- ▷ Entry area counter top: Perla laminate
- ▷ Bathroom counter top: Urban Style laminate
- ▷ Bathroom cabinet doors: Atlas Zeder
- ▷ Wardrobe doors (bedroom): Atlas Zeder
- ▷ Fabric collections: Ontario (dark brown), Tulsa (beige) and Fremont (black)

KABE Gemstone 2024

In KABE Gemstone, you will find a long list of new interior details. The Atlas Zeder wood laminate with its attractive warm brown tone works perfectly with the new lighter floor covering and the upper cabinets in Grau. The kitchen cabinets have doors in Atlas Zeder. The kitchen counter top and all table and counter surfaces feature the modern laminate Perla. Wood laminate light fixtures and a stylish ceiling light in faux suede are also included.

You can choose between three new fabric collections.

The kitchen is equipped with a rounded sink and a new surface-mounted faucet, separate cutlery drawer, and cutting board in carefully selected beech wood. The counter top's new Perla laminate continues to the back splash and is met by backlit plexiglas. The split cover for the 3-burner stove provides a smart, extra space.

For a more cohesive feeling, the back wall in the kitchen is finished with the new Atlas Zeder laminate as well.

Microwave installed under the fridge is an option.

Our ergonomic cushions with Premium Foam inside provide superior comfort and make the living room the obvious place to relax and socialise. An adjustable headrest, adds extra comfort and is available as an option with the Comfort package. All our cushions have anti-slip material on the underside to keep them in place.

To make life in the caravan as smooth as possible, our models include more USB outlets than ever, for example by the bunk bed.

In the entry, you will find a bar cabinet with horizontal bottle storage, and a slim wardrobe.

All Gemstone bathrooms feature the counter top Urban Style. If you choose a TDL solution, matching stylish concrete look on the wall in the shower and on the wall behind the mirror is a nice touch.

In model year 2023, we updated to a new electrical system with a touch-panel.

With AGS II Pro, the floor heating can be turned on separately. A shunt valve regulates the temperature of the water circulating under the floor. To reduce the energy consumption in the boiler and battery, the system is operated in intervals.

Other practical details are the lock for the water tank cover and opening front window is standard.

On the outside, 15" rims in custom design enhance the Gemstones feeling.

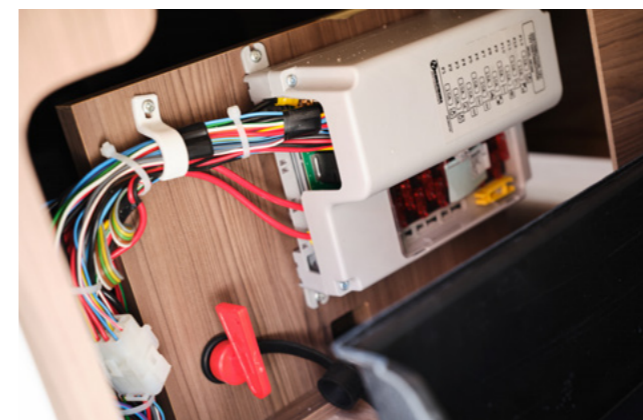



Briljant 470 XL

The smallest of KABE's Gemstone models. A compact and light caravan, favoured by those who travel lots of miles.

TECHNICAL SPECIFICATION	
Overall length	693 cm
Overall height	278 cm
Overall width Std.	230 cm
Overall width KS	250 cm
Body length	568 cm
Interior body length	473 cm
Interior height	196 cm
Interior width Std.	215 cm
Interior width KS	235 cm
Living area Std.	10,2 m ²
Living area KS	11,1 m ²
Bed space Std. – Front	205 x 156/124 cm
Rear XV2	196 x 129/102 cm
Bed space KS – Front	225 x 156/124 cm
Rear XV2	196 x 140/118 cm

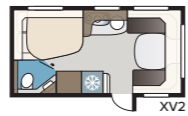

Smaragd 520 XL

The Smaragd model was launched in 1967 and since then it's been one of our most popular caravans. We've kept its foundation, providing both space and comfort.

TECHNICAL SPECIFICATION	
Overall length	742 cm
Overall height	278 cm
Overall width Std.	230 cm
Overall width KS	250 cm
Body length	617 cm
Interior body length	522 cm
Interior height	196 cm
Interior width Std.	215 cm
Interior width KS	235 cm
Living area Std.	11,2 m ²
Living area KS	12,3 m ²
Bed space Std. – Front	205 x 166/127 cm
Rear XV2	196 x 129/102 cm
Bed space KS – Front	225 x 166/127 cm
Rear XV2	196 x 140/118 cm

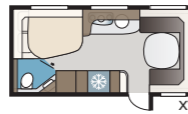

Smaragd 540 GLE

If you love to travel, Smaragd GLE is the perfect model for you! It features practical single beds and a very comfortable seating area.

TECHNICAL SPECIFICATION	
Overall length	760 cm
Overall height	278 cm
Overall width Std.	230 cm
Overall width KS	250 cm
Body length	635 cm
Interior body length	540 cm
Interior height	196 cm
Interior width Std.	215 cm
Interior width KS	235 cm
Living area Std.	11,6 m ²
Living area KS	12,7 m ²
Bed space Std. – Front	205 x 141/127 cm
Rear B2	196 x 78 + 186 x 78 cm
Bed space KS – Front	225 x 141/127 cm
Rear B2	196 x 88 + 186 x 88 cm

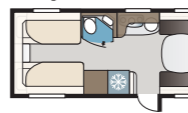

Ametist 560 XL

Ametist XL is by far our greatest success and the most sold caravan model in all of Sweden. A truly excellent choice, when you are looking for a practical and comfortable solution.

TECHNICAL SPECIFICATION	
Overall length	770 cm
Overall height	278 cm
Overall width Std.	230 cm
Overall width KS	250 cm
Body length	645 cm
Interior body length	550 cm
Interior height	196 cm
Interior width Std.	215 cm
Interior width KS	235 cm
Living area Std.	11,8 m ²
Living area KS	12,9 m ²
Bed space Std. – Front	205 x 179/150 cm
Rear XV2	196 x 129/102 cm
Bed space KS – Front	225 x 179/150 cm
Rear XV2	196 x 140/118 cm

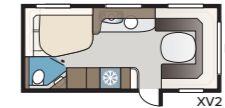

Ametist 560 GLE

A flexible caravan that can be tailored to your needs with a double bed, single bed or bunk beds for two or three. Ametist 560 GLE offers lots of options!

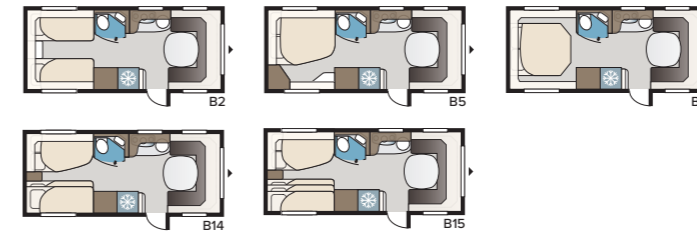

TECHNICAL SPECIFICATION	
Overall length	780 cm
Overall height	278 cm
Overall width Std.	230 cm
Overall width KS	250 cm
Body length	655 cm
Interior body length	560 cm
Interior height	196 cm
Interior width Std.	215 cm
Interior width KS	235 cm
Living area Std.	12,0 m ²
Living area KS	13,2 m ²
Bed space Std. – Front	205 x 146/137 cm
Rear B2	2 x 196 x 78 cm
B5	196 x 140/118 cm
B14	196 x 129/102 + 2 x 196 x 68 cm
Bed space KS – Front	225 x 146/137 cm
Rear B2	2 x 196 x 88 cm
B5	196 x 160/138 cm
B8	190 x 150/60 cm
B14	196 x 129/102 + 2 x 196 x 68 cm
B15	196 x 129/102 + 188 x 63 + 2 x 196 x 68 cm



Safir 600 TDL

Safir TDL features a generous bathroom with a separate walk-in shower.

TECHNICAL SPECIFICATION	
Overall length	820 cm
Overall height	278 cm
Overall width Std.	230 cm
Overall width KS	250 cm
Body length	695 cm
Interior body length	600 cm
Interior height	196 cm
Interior width Std.	215 cm
Interior width KS	235 cm
Living area Std.	12,9 m ²
Living area KS	14,1 m ²
Bed space Std. – Front	205 x 166/137 cm
Rear E2	196 x 78 + 186 x 78 cm
Bed space KS – Front	225 x 166/137 cm
Rear E2	196 x 88 + 186 x 88 cm

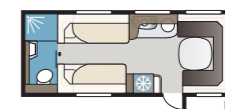



Safir 600 GLE

Our most flexible Safir model with lots of options to choose the floor plan that is right for you. This caravan features up to five bed spaces.

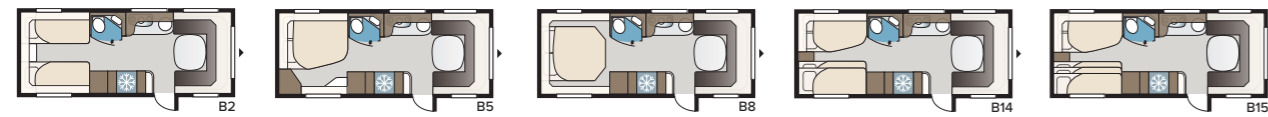

TECHNICAL SPECIFICATION	
Overall length	820 cm
Overall height	278 cm
Overall width KS	250 cm
Body length	695 cm
Interior body length	600 cm
Interior height	196 cm
Interior width KS	235 cm
Living area KS	14,1 m ²
Bed space KS – Front	225 x 169/147 cm
Rear B2	2 x 196 x 88 cm
B5	196 x 160/138 cm
B8	190 x 150/60 cm
B14	196 x 129/102 + 2 x 196 x 68 cm
B15	196 x 129/102 + 188 x 63 + 2 x 196 x 68 cm



Onyx 630 GLE

Onyx 630 with GLE floor plan! Choose between five bedroom solutions and create the perfect caravan for your family.

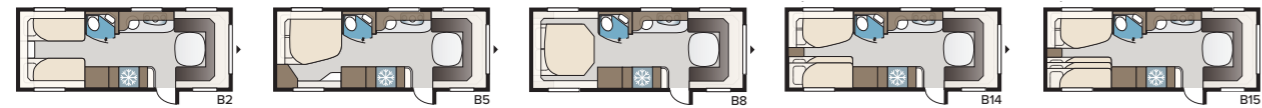

TECHNICAL SPECIFICATION	
Overall length	850 cm
Overall height	278 cm
Overall width KS	250 cm
Body length	725 cm
Interior body length	630 cm
Interior height	196 cm
Interior width KS	235 cm
Living area KS	14,8 m ²
Bed space KS – Front	225 x 179/168 cm
Rear B2	2 x 196 x 88 cm
B5	196 x 160/138 cm
B8	190 x 150/60 cm
B14	196 x 129/102 + 2 x 196 x 68 cm
B15	196 x 129/102 + 188 x 63 + 2 x 196 x 68 cm



Onyx 630 TDL

Onyx 630 TDL features a separate bedroom area with two floor plans. Choose between two single beds or a transverse double bed! The bathroom spans the entire width of the back of the caravan and includes a walk-in shower.

TECHNICAL SPECIFICATION	
Overall length	850 cm
Overall height	278 cm
Overall width KS	250 cm
Body length	725 cm
Interior body length	630 cm
Interior height	196 cm
Interior width KS	235 cm
Living area KS	14,8 m ²
Bed space KS – Front	225 x 166/145 cm
Rear E2	2 x 196 x 88 cm
E8	199 x 156/118 cm

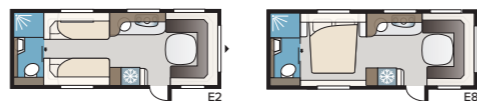

Options for Gemstone

COMFORT PACKAGE



Large refrigerator / Compressor refrigerator Head rest Storage access Heated towel rack Electric adjustable headboard

DESIGN PACKAGE



Window for the front door Heki II skylight Fitted carpet Compressor refrigerator

ADDITIONAL OPTIONS



Compressor refrigerator



Microwave under the refrigerator



Oven



Large refrigerator and freezer



Grand Lit B2 (only for GLE models)

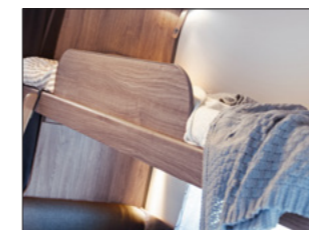

Loft bed cabinet (only certain bedroom solutions and middle dinette)



External antenna for router



NEW! Dometic Fresh Jet FJX4 2200 air conditioner

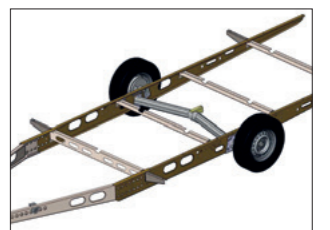

Total weight:
 • 2000 kg – Std. (standard with Safir, not available for Brilljant)
 • 2000 kg – KS (standard with Safir and Onyx, not available for Brilljant)
 • **NEW!** 2300 kg (single axle models 600-630)



ATC



Storage access



Electric step



Duocontrol. Duo Control is approved in all of Europe and allows for the gas to be on while driving.



Direct drain – wastewater bypass tank



City water

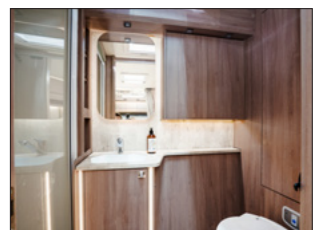

Mirror image TDL-bathroom available for Safir 600 TDL or Onyx 630 TDL, E2 or E8 floor plan.

Mirror image bedroom and bathroom with Onyx 630 TDL, E8-solution.

KABE Royal

Our Royal-series is loaded with luxury equipment and features that are at the forefront of technology. Everything from Gemstone is included, and much more. As an example, KABE Smart D electrical system is standard in all Royal models. In our Royal Hacienda caravans, we have combined a long list of smart solutions with lots of space. Easy-to-move and comfortable accommodation for those who are looking for something special.

Three new fabric collections are included for Royal. Two in leather and one in brand new artificial leather are available as an option. Each collection is made with quality materials and provides you with a maximum number of combination possibilities. Choose the upholstery, curtains and bedspreads that suit your personality, and you can be sure that you are buying a caravan which you will enjoy for many years.

All Royal models can be found on page 72.



Standard equipment

When you choose KABE Royal or Royal Hacienda, the following is included in addition to what's already included in Estate (p. 51) and Gemstone (p. 61):

- ▶ Storage access
- ▶ Decals in the front air intakes
- ▶ ATC (Anti-Skid System) electronic stabilisation system
- ▶ Window in entrance door
- ▶ Heki II skylight
- ▶ Exterior lighting along the entire entry side (Royal only)
- ▶ 3-burner stove with one electric burner and built-in oven (not for 540 GLE and 560 GLE)
- ▶ Sofa headrest
- ▶ Exterior shower connection
- ▶ Heated towel rack
- ▶ Electrical box with exterior 230 V / 12 V outlet, lighting and switch
- ▶ Speakers in the front and back
- ▶ Lighting in windows
- ▶ Multimedia player with DAB
- ▶ Smart D electrical system
- ▶ Wireless charger
- ▶ Central vacuum cleaner

See our options on pages 96-99.

KABE Royal 2024

When you step into the caravan, the new wood laminate Atlas Zeder is warm and inviting with its brown shade. The balance of the interior is adapted to the modern decor. New lighter floor covering and upper cabinets in the front and back, and in the kitchen as well, feature the new light colour Cashmere throughout.

The new living environment is completed with a kitchen counter top, back splash and entry counter top in the new contemporary laminate Light Concrete.

In the Royal kitchen, there is no room for compromise. In addition to all the features from our well-equipped Gemstone kitchens, a Thetford stove with three burners, an electric burner and a convection oven is included. In order for the fan for the hot air function to work, the caravan must be connected to 230 V, otherwise the oven works just like a normal oven.

In our unique front kitchen models, the kitchen is located in the front of the caravan with generous counter space and wonderful light from the large panorama front window. The light fixture and ceiling light are covered in faux suede. Opening front window is standard.

Dometic's innovative refrigerator, with double-hinged doors for both the refrigerator and freezer compartment, can be opened with the aluminium moulding on either side of the door. Neonflex slim silicone profile with LED lighting frames the refrigerator on both sides. Compressor fridge from Dometic is available as an option.

An adjustable headrest that can be raised and lowered and moved from side-to-side is included in the sofa.

For ultimate comfort, the headboard is covered in soft padded imitation suede with a printed 3D-look. A luxurious spring mattress with a thick mattress top is also included.

In the bedroom, a smart switch with touch-function was introduced last year. Our XL bed features the reading light Duospot with three switches.

All Royal bathrooms are updated with a new Light Concrete counter top. In our TDL-models, you will find a matching laminate on the wall in the walk-in shower and behind the mirror as well. Neonflex silicone profile with LED lighting was introduced in 2023 for our TDL-bathrooms.



In the entry, you will find a bar cabinet with horizontal bottle storage and a slim wardrobe with two spacious drawers at the bottom.

A wireless charger for mobile phones is included in our Royal models. It is located in the front of the caravan.

Digital Audio Broadcasting (DAB) is standard with the multimedia player in Royal.

Lock for the practical water tank cover is standard.

KABE Smart Level is available as an option.

All Royal models feature specially designed 15" rims and 17" rims are available as an option.



Updates! New chassis with a total weight of 2300 kg for single axle models with 600-630 length!

- ▶ New design exterior graphics
- ▶ New model: Royal 740 CTDL with a separate shower, KABEs new L-shaped kitchen and an extra spacious seating area where the TV fits neatly into the smart sofa back rest compartment when it's not in use
- ▶ New design for the upper cabinets with new lighting
- ▶ New kitchen faucet with a metal handle
- ▶ New black air vent in the bedroom
- ▶ Three new fabric collections with new curtains
- ▶ New design for interior roof vent
- ▶ 12 V main switch moved for acces from the ski storage
- ▶ New AC – Dometic Fresh Jet FJX4 2200 (option)
- ▶ New 150 Ah lithium battery (option and eco-package)
- ▶ Mirror image bathroom and shower available as an option for TDL E8 floor plans

- ▷ Wood laminate: Atlas Zeder
- ▷ Floor covering: Light
- ▷ Upper cabinet doors front/back: Cashmere
- ▷ Kitchen cabinet doors: Cashmere
- ▷ Kitchen counter top and back splash: Light Concrete laminate
- ▷ Back wall: Cashmere
- ▷ Table and counter top: Latte laminate
- ▷ Entry area counter top: Light Concrete laminate
- ▷ Bathroom counter top: Light Concrete laminate
- ▷ Bathroom cabinet doors: Atlas Zeder
- ▷ Wardrobe doors (bedroom): Atlas Zeder
- ▷ Fabric collections: Ontario (dark brown), Tulsa (beige) and Fremont (black)
- ▷ Leather or artificial leather is available as an option

25 models – 78 floor plans



Royal 520 XL



Royal 540 GLE



Royal 560 XL



Royal 560 GLE



Royal 600 XL



Royal 600 CXL



Royal 600 GLE



Royal 600 TDL



Royal 630 TDL



Royal 630 TDL



Royal 630 TDL FK



Royal 630 TDL FK



Royal 630 GLE



Royal 630 GLE



Royal 740 TDL



NEW! Royal 740 CTDL



Royal 780 TDL



Royal 780 TDL FK



Royal 780 BGXL



Royal Hacienda 880 TDL



Royal Hacienda 880 TDL FK



Royal Hacienda 880 BTDL



Royal Hacienda 880 DTDL



Royal Hacienda 880 GLE



Royal Hacienda 1000 TDL



Royal 520 XL

This is our Royal series version of Smaragd XL, one of the most popular caravans in the market. It has a similar floor plan, with all of Smaragd's features and more.

TECHNICAL SPECIFICATION	
Overall length	742 cm
Overall height	278 cm
Overall width Std.	230 cm
Overall width KS	250 cm
Body length	617 cm
Interior body length	522 cm
Interior height	196 cm
Interior width Std.	215 cm
Interior width KS	235 cm
Living area Std.	11,2 m ²
Living area KS	12,3 m ²
Bed space Std. – Front	205 x 159/127 cm
Rear XV2	196 x 129/102 cm
Bed space KS – Front	225 x 159/127 cm
Rear XV2	196 x 140/118 cm

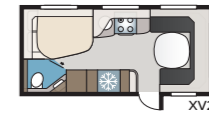

Royal 540 GLE

Royal 540 GLE features a bedroom with two separate single beds. The compact and clever kitchen is equipped with a built-in oven.

TECHNICAL SPECIFICATION	
Overall length	760 cm
Overall height	278 cm
Overall width Std.	230 cm
Overall width KS	250 cm
Body length	635 cm
Interior body length	540 cm
Interior height	196 cm
Interior width Std.	215 cm
Interior width KS	235 cm
Living area Std.	11,6 m ²
Living area KS	12,7 m ²
Bed space Std. – Front	205 x 141/127 cm
Rear B2	196 x 78 + 186 x 78 cm
Bed space KS – Front	225 x 141/127 cm
Rear B2	196 x 88 + 186 x 88 cm

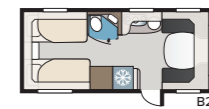

Royal 560 XL

This smaller Royal model is a favourite of many. The Royal 560 XL has all the special features of our larger Royal caravans, in a slightly more compact layout.

TECHNICAL SPECIFICATION	
Overall length	770 cm
Overall height	278 cm
Overall width Std.	230 cm
Overall width KS	250 cm
Body length	645 cm
Interior body length	550 cm
Interior height	196 cm
Interior width Std.	215 cm
Interior width KS	235 cm
Living area Std.	11,8 m ²
Living area KS	12,9 m ²
Bed space Std. – Front	205 x 179/150 cm
Rear E2	196 x 129/102 cm
Bed space KS – Front	225 x 179/150 cm
Rear E2	196 x 140/118 cm





Royal 560 GLE

A small and practical model that offers six different Flexline solutions. Options include separate single beds, a double bed and bunk beds for two or three.

TECHNICAL SPECIFICATION	
Overall length	780 cm
Overall height	278 cm
Overall width Std.	230 cm
Overall width KS	250 cm
Body length	655 cm
Interior body length	560 cm
Interior height	196 cm
Interior width Std.	215 cm
Interior width KS	235 cm
Living area Std.	12,0 m ²
Living area KS	13,2 m ²
Bed space Std. – Front	205 x 146/137 cm
Rear B2	2 x 196 x 78 cm
B5	196 x 140/118 cm
B14	196 x 129/102 + 2 x 196 x 68 cm
Bed space KS – Front	225 x 146/137 cm
Rear B2	2 x 196 x 88 cm
B5	196 x 160/138 cm
B8	190 x 150/60 cm
B14	196 x 129/102 + 2 x 196 x 68 cm
B15	196 x 129/102 + 188 x 63 + 2 x 196 x 68 cm
B16	199 x 156/118 cm

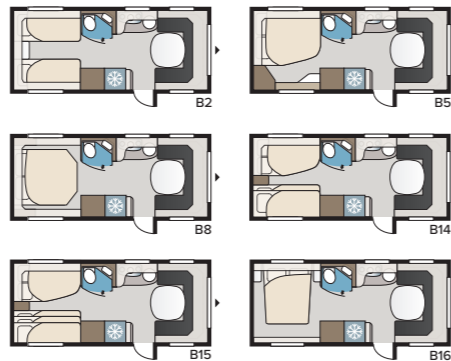

TECHNICAL SPECIFICATION	
Overall length	820 cm
Overall height	278 cm
Overall width Std.	230 cm
Overall width KS	250 cm
Body length	695 cm
Interior body length	600 cm
Interior height	196 cm
Interior width Std.	215 cm
Interior width KS	235 cm
Living area Std.	12,9 m ²
Living area KS	14,1 m ²
Bed space Std. – Front	205 x 177/150 cm
Rear XV2	196 x 129/102 cm
DXL	196 x 129/102 cm
Bed space KS – Front	225 x 177/150 cm
Rear XV2	196 x 140/118 cm
DXL	196 x 140/118 cm



Royal 600 XL

Royal 600 XL is compact luxury. This model offers more space than the smaller 560 XL and the same quality equipment. Our DXL solution features a walk-in shower.



Royal 600 CXL

Royal 600 CXL features an L-shaped kitchen and a large and comfortable sofa. Bathroom with a separate shower (DXL) is available as an option. When the TV is not in use, it fits neatly into a smart compartment in the sofa's back rest. TV is not included.

TECHNICAL SPECIFICATION	
Overall length	820 cm
Overall height	278 cm
Overall width KS	250 cm
Body length	695 cm
Interior body length	600 cm
Interior height	196 cm
Interior width KS	235 cm
Living area KS	14,1 m ²
Bed space KS – Front	225 x 205/150 cm
Rear XV2	196 x 140/118 cm
DXL	196 x 140/118 cm
TV max size	775 x 434 x 70 mm

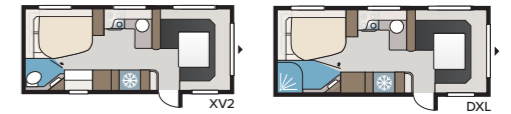

Royal 600 GLE

Royal 600 GLE has lots of options! Our generous floor plan offers many alternatives to create the caravan that will suit your family best.

TECHNICAL SPECIFICATION	
Overall length	820 cm
Overall height	278 cm
Overall width Std.	230 cm
Overall width KS	250 cm
Body length	695 cm
Interior body length	600 cm
Interior height	196 cm
Interior width Std.	215 cm
Interior width KS	235 cm
Living area Std.	12,9 m ²
Living area KS	14,1 m ²
Bed space Std. – Front	205 x 169/148 cm
Rear B2	2 x 196 x 78 cm
B5	196 x 140/118 cm
B14	196 x 129/102 + 2 x 196 x 68 cm
Bed space KS – Front	225 x 169/148 cm
Rear B2	2 x 196 x 88 cm
B5	196 x 160/138 cm
B8	190 x 150/60 cm
B14	196 x 129/102 + 2 x 196 x 68 cm
B15	196 x 129/102 + 188 x 63 + 2 x 196 x 68 cm
B16	199 x 156/118 cm

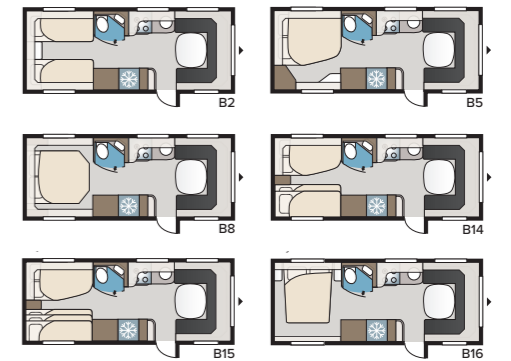



Royal 600 TDL

Our smallest model with TDL floor plan. Choose between two single beds, a double bed or bunk beds. This model features a large bathroom with a walk-in shower that spans the entire width in the back of the caravan.

TECHNICAL SPECIFICATION	
Overall length	820 cm
Overall height	278 cm
Overall width Std.	230 cm
Overall width KS	250 cm
Body length	695 cm
Interior body length	600 cm
Interior height	196 cm
Interior width Std.	215 cm
Interior width KS	235 cm
Living area Std.	12,9 m ²
Living area KS	14,1 m ²
Bed space Std. – Front	205 x 166/136 cm
Rear E2	196 x 78 + 186 x 78 cm
E9	196 x 120 + 2 x 186 x 60 cm
Bed space KS – Front	225 x 166/136 cm
Rear E2	196 x 88 + 186 x 88 cm
E5	196 x 140/118 cm
E9	196 x 140 + 2 x 186 x 60 cm

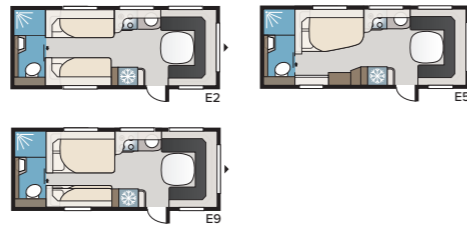

Royal 630 GLE

KABE Royal 630 is now available in every GLE floor plan! You can choose from six bedroom options and create the optimal caravan for your family.

TECHNICAL SPECIFICATION	
Overall length	850 cm
Overall height	278 cm
Overall width KS	250 cm
Body length	725 cm
Interior body length	630 cm
Interior height	196 cm
Interior width KS	235 cm
Living area KS	14,8 m ²
Bed space KS – Front	225 x 179/168 cm
Rear B2	2 x 196 x 88 cm
B5	196 x 160/138 cm
B8	190 x 150/60 cm
B14	196 x 129/102 + 2 x 196 x 68 cm
B15	196 x 129/102 + 188 x 63 + 2 x 196 x 68 cm
B16	199 x 156/118 cm

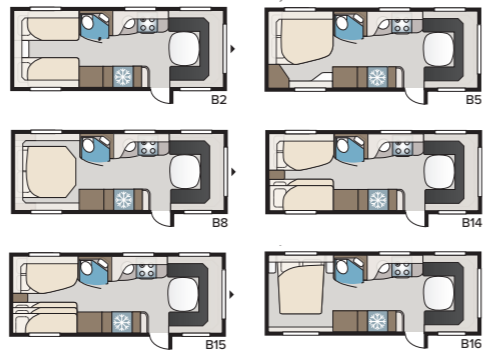

Royal 630 TDL

Royal 630 TDL has a separate bedroom with either two single beds, a double bed or bunk beds. A large bathroom with a walk-in shower spans the entire width in the back of the caravan.

TECHNICAL SPECIFICATION	
Overall length	850 cm
Overall height	278 cm
Overall width KS	250 cm
Body length	725 cm
Interior body length	630 cm
Interior height	196 cm
Interior width KS	235 cm
Living area KS	14,8 m ²
Bed space KS – Front	225 x 166/145 cm
Rear E2	2 x 196 x 88 cm
E5	196 x 140/118 cm
E8	199 x 156/118 cm
E9	196 x 140 + 2 x 196 x 60 cm

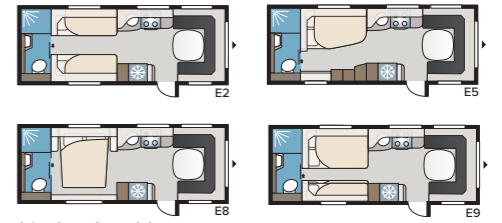

(single axle only)



Royal 630 TDL FK

This model features a unique floor plan. The kitchen is placed in the front of the caravan and the seating area in the middle. In the rear of 630 TDL FK, the layout is the same E2-solution as our 630 TDL.

TECHNICAL SPECIFICATION	
Overall length	850 cm
Overall height	278 cm
Overall width KS	250 cm
Body length	725 cm
Interior body length	630 cm
Interior height	196 cm
Interior width KS	235 cm
Living area KS	14,8 m ²
Bed space KS – Middle	211 x 117 cm
Rear E2	2 x 196 x 78 cm

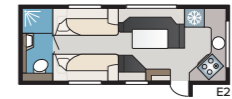



Royal 740 TDL

The luxurious bathroom in this caravan features a walk-in shower as well as a large wardrobe. With KABE's unique Flexline system, this model can be equipped with bed spaces that accommodate up to six people.

TECHNICAL SPECIFICATION	
Overall length	880 cm
Overall height	278 cm
Overall width KS	250 cm
Body length	755 cm
Interior body length	660 cm
Interior height	196 cm
Interior width KS	235 cm
Living area KS	15,2 m ²
Bed space KS – Front	225 x 182/147 cm
Rear E2	2 x 196 x 88 cm
E5	196 x 140/118 cm
E8	199 x 156/118 cm
E9	196 x 140 + 2 x 196 x 60 cm

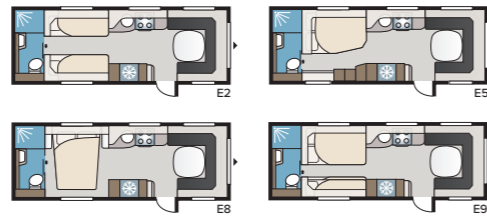

New! Royal 740 CTDL

Royal 740 CTDL takes KABE-living and a feeling of home to the next level. You will find a large and luxurious bathroom with a separate walk-in shower, KABE's new well-equipped L-shaped kitchen and an extra spacious seating area with TV storage built into the sofa back rest when it's not in use. TV is not included.

TECHNICAL SPECIFICATION	
Overall length	880 cm
Overall height	278 cm
Overall width KS	250 cm
Body length	755 cm
Interior body length	660 cm
Interior height	196 cm
Interior width KS	235 cm
Living area KS	15,2 m ²
Bed space KS – Front	225 x 220/140 cm
Rear E2	2 x 196 x 88 cm
E5	196 x 140/118 cm
E8	199 x 156/118 cm
E9	196 x 140 + 2 x 196 x 60 cm
TV max size	775 x 434 x 70 mm

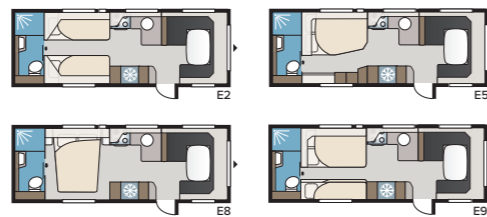

Royal 780 BGXL

Royal 780 BGXL is the perfect choice with lots of space for a large family. This model has quickly become a huge success!

Floor plan with a separate shower (DXL) is available as of model year 2024!

TECHNICAL SPECIFICATION	
Overall length	940 cm
Overall height	278 cm
Overall width KS	250 cm
Body length	815 cm
Interior body length	720 cm
Interior height	196 cm
Interior width KS	235 cm
Living area KS	16,9 m ²
Bed space KS – Front	225 x 165/136 cm
Dinette	191 x 88 cm
Rear XV2	196 x 140/118 + 2 x 196 x 68 cm
Rear DXL	196 x 140/118 + 2 x 196 x 68 cm



Royal 780 TDL

Royal 780 TDL is the best seller in KABE Royal 780-series. Choose between four bed options: a double bed, transverse double bed, two single beds or bunk beds.

TECHNICAL SPECIFICATION	
Overall length	940 cm
Overall height	278 cm
Overall width KS	250 cm
Body length	815 cm
Interior body length	720 cm
Interior height	196 cm
Interior width KS	235 cm
Living area KS	16,9 m ²
Bed space KS – Front	225 x 184/169 cm
Rear E2	2 x 196 x 88 cm
E5	196 x 140/118 cm
E8	199 x 156/118 cm
E9	196 x 140 + 2 x 196 x 60 cm

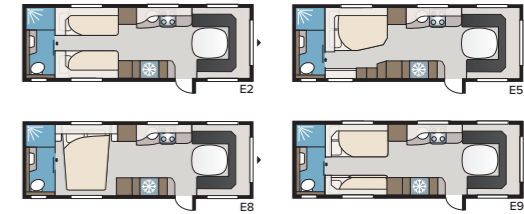

Royal 780 TDL FK

This model features a 235 cm wide kitchen with a panorama window in the front of the caravan. In the kitchen, you will find a large three burner gas stove with an electric burner and a built-in oven. With a generous and flexible bedroom area, a large bathroom and lots of storage, your family will enjoy the living space in this model.

TECHNICAL SPECIFICATION	
Overall length	940 cm
Overall height	278 cm
Overall width KS	250 cm
Body length	815 cm
Interior body length	720 cm
Interior height	196 cm
Interior width KS	235 cm
Living area KS	16,9 m ²
Bed space KS – Middle	211 x 117 cm
Rear E2	2 x 196 x 88 cm
E5	196 x 140/118 cm
E8	199 x 156/118 cm
E9	196 x 140 + 2 x 196 x 60 cm

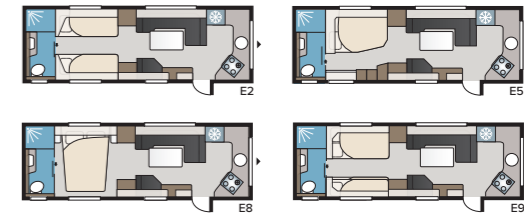



Royal Hacienda 880 TDL

The standard version of Royal Hacienda 880 TDL features four to five bed spaces. Choose between a double bed, transverse double bed, two single beds or bunk beds.

TECHNICAL SPECIFICATION	
Overall length	1040 cm
Overall height	278 cm
Overall width KS	250 cm
Body length	915 cm
Interior body length	820 cm
Interior height	196 cm
Interior width KS	235 cm
Living area KS	19,3 m ²
Bed space KS – Front	225 x 184/169 cm
Rear E2	2 x 196 x 88 cm
E5	196 x 140/118 cm
E8	199 x 156/118 cm
E9	196 x 140 + 2 x 196 x 60 cm
Dinette	191 x 88 cm

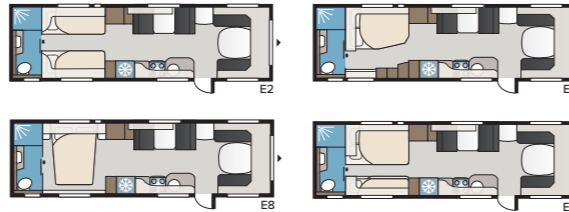

Royal Hacienda 880 TDL FK

This is the perfect choice if you love to cook! 880 TDL FK features a spacious kitchen located in the front of the caravan with a panorama window that lets in lots of light. This model has a very generous floor plan!

TECHNICAL SPECIFICATION	
Overall length	1040 cm
Overall height	278 cm
Overall width KS	250 cm
Body length	915 cm
Interior body length	820 cm
Interior height	196 cm
Interior width KS	235 cm
Living area KS	19,3 m ²
Bed space KS – Middle	211 x 117 cm
Rear E2	2 x 196 x 88 cm
E5	196 x 140/118 cm
E8	199 x 156/118 cm
E9	196 x 140 + 2 x 196 x 60 cm

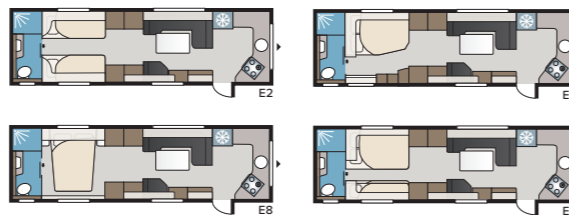

Royal Hacienda 880 BTDL

The standard version of this model features four to five bed spaces. The seating area in the front as well as the dinette area converts to extra beds and along with an overhead cabinet loft bed, you can quickly fit up to nine people!

TECHNICAL SPECIFICATION	
Overall length	1040 cm
Overall height	278 cm
Overall width KS	250 cm
Body length	915 cm
Interior body length	820 cm
Interior height	196 cm
Interior width KS	235 cm
Living area KS	19,3 m ²
Bed space KS – Front	225 x 161/136 cm
Rear	196 x 140 cm
Dinette	191 x 88 cm
Double bunkbed	2 x 196 x 68 cm

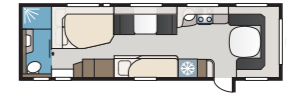

Royal Hacienda 880 DTDL

880 DTDL has lots of space! This model features a transverse, extra large double bed and a bathroom that spans the entire width in the rear of the caravan. You will feel right at home.

TECHNICAL SPECIFICATION	
Overall length	1040 cm
Overall height	278 cm
Overall width KS	250 cm
Body length	915 cm
Interior body length	820 cm
Interior height	196 cm
Interior width KS	235 cm
Living area KS	19,3 m ²
Bed space KS – Front	225 x 198/169 cm
Rear	188 x 156 cm





Royal Hacienda 880 GLE

Royal Hacienda 880 GLE is available in seven floor plans! You will definitely find an option that suits you and your family.

TECHNICAL SPECIFICATION	
Overall length	1040 cm
Overall height	278 cm
Overall width KS	250 cm
Body length	915 cm
Interior body length	820 cm
Interior height	196 cm
Interior width KS	235 cm
Living area KS	19,3 m ²
Bed space KS – Front	225 x 211/169 cm
Rear B2	2 x 196 x 88 cm
B5	196 x 160/138 cm
B8	190 x 150/60 cm
B10	196 x 156 cm
B14	196 x 129/102 + 2 x 196 x 68 cm
B15	196 x 129/102 + 188 x 63 + 2 x 196 x 68 cm
B16	199 x 156/118 cm
Dinette	191 x 88 cm

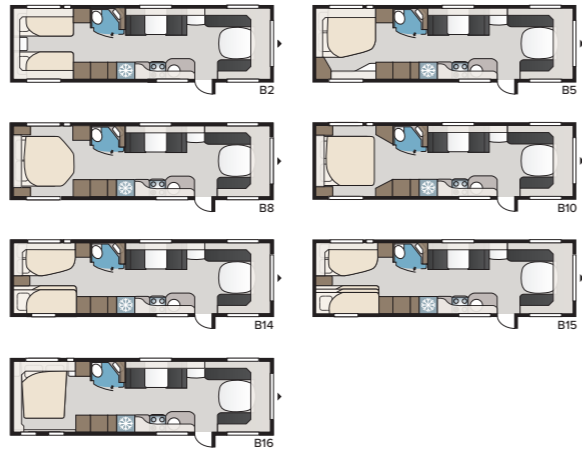

Royal Hacienda 1000 TDL

Royal Hacienda 1000 TDL measures an amazing 22 m². And with our Flexline system, there are almost no limits to how you can tailor the interior for your personal needs.

TECHNICAL SPECIFICATION	
Overall length	1160 cm
Overall height	278 cm
Overall width KS	250 cm
Body length	1035 cm
Interior body length	940 cm
Interior height	196 cm
Interior width KS	235 cm
Living area KS	22,0 m ²
Bed space KS – Front	225 x 198/169 cm
Rear E2	2 x 196 x 88 cm
E3	2 x 196 x 77 + 196 x 96 cm
E5	196 x 140 cm
E8	199 x 156/118 cm
E9	196 x 140 + 2 x 196 x 60 cm
DU	196 x 140 cm

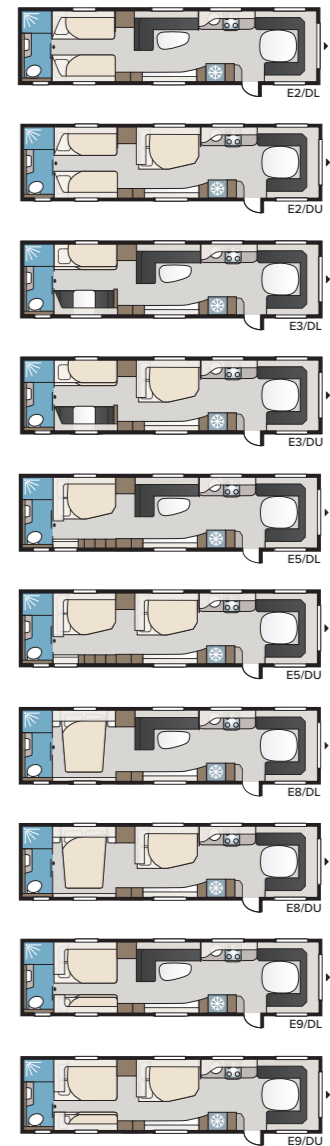

KABE Imperial

Our Imperial series is the definition of the absolute premium segment of caravans. You will recognize the exclusive and eye-catching exterior with smooth, high gloss panels and unique new 3D graphics.

Luxury in every aspect throughout the interior. Induction stove top, modern cabinet doors, rich leather upholstery, microwave, flush toilet with a ceramic bowl, AC, specially designed premium sound system and KABE Smart D electrical system are just a few examples of what is included. If you want the very best, KABE Imperial is the right choice for you. With our unique leather or artificial leather collections – you can add your own personal touch!

KABE Smart Level with three useful functions is included in the Smart D panel. Smart Level tracks your gas level (with use of one gas- bottle, not for composite bottles), tyre air pressure and the inclination of the caravan. The panel displays your gas level. No need to worry about unexpectedly running out of gas during your trip. The tyre air pressure sensor helps to ensure that your tyres have the right amount of air pressure for a safe and fuel-efficient drive. Additionally, a level indicator is included with KABE Smart Level. When your caravan is parked, the display shows your caravan's inclination. An important factor for a pleasant and functional stay. Standard in Imperial.

17 models – 60 floor plans



Imperial 560 XL



Imperial 600 XL



Imperial 600 CXL



Imperial 630 TDL



Imperial 630 TDL



Imperial 630 TDL FK



Imperial 740 TDL



NEW! Imperial 740 CTDL



Imperial 780 TDL



Imperial 780 TDL FK



Imperial 780 DGLE



Imperial 880 TDL



Imperial 880 TDL FK



Imperial 880 BTDL



Imperial 880 DTDL



Imperial 880 GLE



Imperial 1000 TDL

Standard equipment

In addition to what's included in Estate (p. 51), Gemstone (p. 61) and Royal (p. 69) – our top-of-the-line KABE Imperial series also includes:

- ▶ 17" Diamond Cut aluminium rims
- ▶ Smooth exterior panels with Innovation Design graphics
- ▶ Heki De Luxe skylight
- ▶ Total weight 2000 / 2650 kg
- ▶ New Dometic Fresh Jet FJX4 2200 air conditioner
- ▶ Alde zone heating
- ▶ Kitchen counter with an induction stove top, gas burners and a built-in oven
- ▶ KABE AutoDrain (automatic emptying of the water system)
- ▶ Microwave
- ▶ Leather or artificial leather upholstery
- ▶ Slide-out sofa
- ▶ Swivel flush toilet with ceramic bowl
- ▶ KABE Premium Sound System with DAB
- ▶ KABE Smart Level

See our options on pages 96-99.



KABE Imperial 2024

In Imperial, you will find our most luxurious interior. The entire look is updated in 2024, with wood laminate Atlas Zeder in a modern and warm brown tone. The wardrobe doors in the bedroom match the new shade. New floor covering in a lighter tone and new upper cabinet doors in Cashmere, both in the front and back, create a nice contrast. The upper kitchen cabinets are finished with new high-gloss doors in a mild crème colour, Sabbia High Gloss.

In addition to all the equipment from our other kitchens, Imperial features an induction stove top which is recessed into the new Light Concrete counter top. Two separate gas burners are included. The microwave is installed under the refrigerator to provide more space in the kitchen cabinets, and at the same time preserve the clean design of the upper part of the kitchen.

The living area is furnished with carefully selected, exclusive materials and a timeless design. Relax in the large sofa, leather or artificial leather upholstery is included. Adjustable headrest is an added bonus, move it up and down or from side-to-side for even more comfort.

The light fixture in our front kitchen (FK) and the ceiling light are covered in faux suede. Heki II skylight is framed with laminate lighting.

In the entry, you will find a bar cabinet with horizontal bottle storage and a slim wardrobe with two spacious drawers at the bottom.

In the bedroom, a smart switch with touch-function was introduced last year. XL bed features the reading light Duospot.

The new Light Concrete bathroom counter top has a contemporary look. In our T-models, you will find a matching laminate on the wall behind the mirror and on the wall in the shower as well.

With KABE Smart D Remote app, you can manage the caravan's control panel remotely, wherever you are. Available as an option in Imperial.

To maximize your media options, a wireless router is included. Imperial is equipped with a multimedia player with DAB and Premium Sound System is standard. Relax and enjoy your favourites!

The Imperial series includes the latest generation AC from Dometic – Fresh Jet FJX4 2200 – to ensure that you are as comfortable as possible even during the hottest summer days (read more on page 32).

Lock for the water tank cover is standard.

The Imperial series is equipped with exclusive 17" rims in Diamond Cut-design – completely unique to KABE.



- ▷ Wood laminate: Atlas Zeder
- ▷ Floor covering: Light
- ▷ Upper cabinet doors front/back: Cashmere
- ▷ Kitchen cabinet doors: Sabbia High Gloss
- ▷ Kitchen counter top and back splash: Light Concrete laminate
- ▷ Back wall: Cashmere
- ▷ Table and counter top: Latte laminate
- ▷ Entry area counter top: Light Concrete laminate
- ▷ Bathroom counter top: Light Concrete laminate
- ▷ Bathroom cabinet doors: Atlas Zeder
- ▷ Wardrobe doors (bedroom): Atlas Zeder
- ▷ Leather collections: Hollywood (dark grey) and Baltimore (beige)
- ▷ Artificial leather: Lancaster (brown)

Updates! New chassis with a total weight of 2300 kg for single axle models with 600-630 length!

- ▶ New exterior Innovation Design graphics
- ▶ New model: Imperial 740 CTDL with a separate shower, KABEs new L-shaped kitchen and an extra spacious seating area where the TV fits neatly into the smart sofa back rest compartment when it's not in use
- ▶ New design for the upper cabinets with new lighting
- ▶ New kitchen faucet with a metal handle
- ▶ New black air vent in the bedroom
- ▶ New curtains for beige leather collection
- ▶ New collection in brown artificial leather with new curtains
- ▶ New design for interior roof vent
- ▶ 12 V main switch moved for access from the ski storage
- ▶ New AC – Dometic Fresh Jet FJX4 2200
- ▶ New 150 Ah lithium battery (option and eco-package)
- ▶ Mirror-image bathroom and shower available as an option for TDL E8 floor plans



Imperial 560 XL

KABE Imperial features our exclusive exterior Innovation Design. Imperial 560 XL is a compact model, but with all the special features of the larger Imperial models.

TECHNICAL SPECIFICATION	
Overall length	770 cm
Overall height	278 cm
Overall width Std.	230 cm
Overall width KS	250 cm
Body length	645 cm
Interior body length	550 cm
Interior height	196 cm
Interior width Std.	215 cm
Interior width KS	235 cm
Living area Std.	11,8 m ²
Living area KS	12,9 m ²
Bed space Std. – Front	205 x 179/150 cm
Rear XV2	196 x 129/102 cm
Bed space KS – Front	225 x 179/150 cm
Rear XV2	196 x 140/118 cm

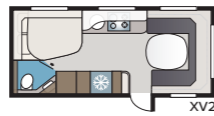

Imperial 600 XL

In Imperial 600 XL you can choose between additional storage space or the DXL option with a separate shower.

TECHNICAL SPECIFICATION	
Overall length	820 cm
Overall height	278 cm
Overall width KS	250 cm
Body length	695 cm
Interior body length	600 cm
Interior height	196 cm
Interior width KS	235 cm
Living area KS	14,1 m ²
Bed space KS – Front	225 x 177/150 cm
Rear XV2	196 x 140/118 cm
DXL	196 x 140/118 cm



Imperial 600 CXL

Imperial 600 CXL features an L-shaped kitchen and a large and comfortable sofa. Bathroom with a separate shower (DXL) is available as an option. When the TV is not in use, it fits neatly into a smart compartment in the sofa's back rest. TV is not included.

TECHNICAL SPECIFICATION	
Overall length	820 cm
Overall height	278 cm
Overall width KS	250 cm
Body length	695 cm
Interior body length	600 cm
Interior height	196 cm
Interior width KS	235 cm
Living area KS	14,1 m ²
Bed space KS – Front	225 x 205/150 cm
Rear XV2	196 x 140/118 cm
DXL	196 x 140/118 cm
TV max size	775 x 434 x 70 mm



Imperial 630 TDL

Our TDL floor plan is one of KABE's best sellers. This model offers a large kitchen, spacious seating area, either two comfortable single beds, a double bed or bunk bed solution and a bathroom that spans the entire width of the back of the caravan.

TECHNICAL SPECIFICATION	
Overall length	850 cm
Overall height	278 cm
Overall width KS	250 cm
Body length	725 cm
Interior body length	630 cm
Interior height	196 cm
Interior width KS	235 cm
Living area KS	14,8 m ²
Bed space KS – Front	225 x 166/145 cm
Rear E2	2 x 196 x 88 cm
E5	196 x 140/118 cm
E8	199 x 156/118 cm
E9	196 x 140 + 2 x 196 x 60 cm

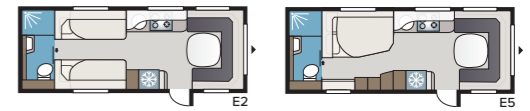

(single axle only)



Imperial 630 TDL FK

This model features a unique floor plan. The kitchen is placed in the front of the caravan and the seating area in the middle. In the rear of 630 TDL FK, the layout is the same E2-solution as our 630 TDL.

TECHNICAL SPECIFICATION	
Overall length	850 cm
Overall height	278 cm
Overall width KS	250 cm
Body length	725 cm
Interior body length	630 cm
Interior height	196 cm
Interior width KS	235 cm
Living area KS	14,8 m ²
Bed space KS – Middle	211 x 117 cm
Rear E2	2 x 196 x 78 cm

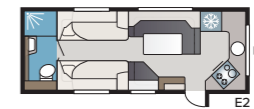

Imperial 740 TDL

This model has more space than the smaller 630 TDL, and the same quality equipment. Choose between four bed options: a double bed, transverse double bed, two single beds or bunk beds.

TECHNICAL SPECIFICATION	
Overall length	880 cm
Overall height	278 cm
Overall width KS	250 cm
Body length	755 cm
Interior body length	660 cm
Interior height	196 cm
Interior width KS	235 cm
Living area KS	15,2 m ²
Bed space KS – Front	225 x 182/147 cm
Rear E2	2 x 196 x 88 cm
E5	196 x 140/118 cm
E8	199 x 156/118 cm
E9	196 x 140 + 2 x 196 x 60 cm

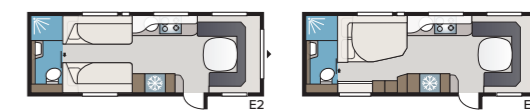



New! Imperial 740 CTDL

Imperial 740 CTDL takes KABE-living and a feeling of home to the next level. You will find a large and luxurious bathroom with a separate walk-in shower, KABE's new well-equipped L-shaped kitchen and an extra spacious seating area with TV storage built into the sofa back rest when it's not in use. TV is not included.

TECHNICAL SPECIFICATION	
Overall length	880 cm
Overall height	278 cm
Overall width KS	250 cm
Body length	755 cm
Interior body length	660 cm
Interior height	196 cm
Interior width KS	235 cm
Living area KS	15,2 m ²
Bed space KS – Front	225 x 220/140 cm
Rear E2	2 x 196 x 88 cm
E5	196 x 140/118 cm
E8	199 x 156/118 cm
E9	196 x 140 + 2 x 196 x 60 cm
TV max size	775 x 434 x 70 mm

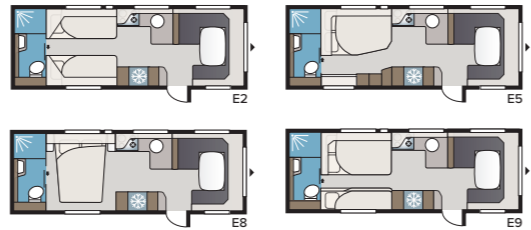

Imperial 780 DGLE

In Imperial 780 DGLE, shower and toilet are placed on opposite sides of the caravan. If you open both doors, the entire bedroom area is divided from the living area in the front. Practical and private! With our Flexline solutions, you can choose the bedroom option that works for you – two single beds, double bed or bunk beds.

TECHNICAL SPECIFICATION	
Overall length	940 cm
Overall height	278 cm
Overall width KS	250 cm
Body length	815 cm
Interior body length	720 cm
Interior height	196 cm
Interior width KS	235 cm
Living area KS	16,9 m ²
Bed space KS – Front	225 x 175/150 cm
Rear B2	2 x 196 x 88 cm
B5	196 x 160/138 cm
B8	190 x 150/60 cm
B10	196 x 156 cm
B14	196 x 129/102 + 2 x 196 x 68 cm
B15	196 x 129/102 + 188 x 63 + 2 x 196 x 68 cm
B16	199 x 156/118 cm

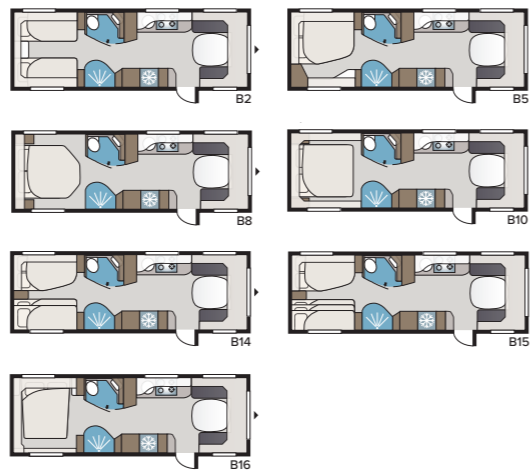

Imperial 780 TDL

Imperial 780 TDL is available in four floor plans with everything you need for comfortable caravan-living and a feeling of space.

TECHNICAL SPECIFICATION	
Overall length	940 cm
Overall height	278 cm
Overall width KS	250 cm
Body length	815 cm
Interior body length	720 cm
Interior height	196 cm
Interior width KS	235 cm
Living area KS	16,9 m ²
Bed space KS – Front	225 x 184/169 cm
Rear E2	2 x 196 x 88 cm
E5	196 x 140/118 cm
E8	199 x 156/118 cm
E9	196 x 140 + 2 x 196 x 60 cm

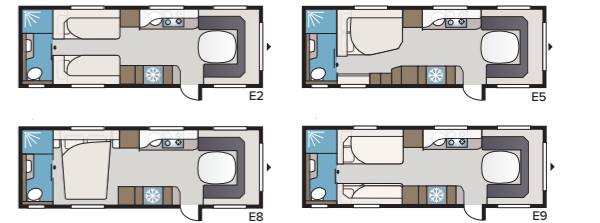

Imperial 780 TDL FK

This model was developed especially for those who love to cook! In the front of the caravan, you will find a 235 cm wide kitchen with an exclusive induction stove top, built-in oven, microwave and a panorama window. In addition, it features a generous living area, flexible bedroom solutions, a large bathroom and lots of storage.

TECHNICAL SPECIFICATION	
Overall length	940 cm
Overall height	278 cm
Overall width KS	250 cm
Body length	815 cm
Interior body length	720 cm
Interior height	196 cm
Interior width KS	235 cm
Living area KS	16,9 m ²
Bed space KS – Middle	211 x 117 cm
Rear E2	2 x 196 x 88 cm
E5	196 x 140/118 cm
E8	199 x 156/118 cm
E9	196 x 140 + 2 x 196 x 60 cm

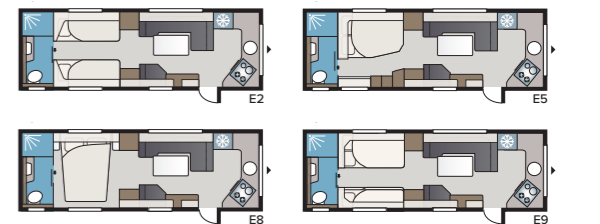



Imperial 880 TDL

The standard version of Royal Hacienda 880 TDL features four to five bed spaces. Choose between a double bed, transverse double bed, two single beds or bunk beds.

TECHNICAL SPECIFICATION	
Overall length	1040 cm
Overall height	278 cm
Overall width KS	250 cm
Body length	915 cm
Interior body length	820 cm
Interior height	196 cm
Interior width KS	235 cm
Living area KS	19,3 m ²
Bed space KS – Front	225 x 184/169 cm
Rear E2	2 x 196 x 88 cm
E5	196 x 140/118 cm
E8	199 x 156/118 cm
E9	196 x 140 + 2 x 196 x 60 cm
Dinette	191 x 88 cm

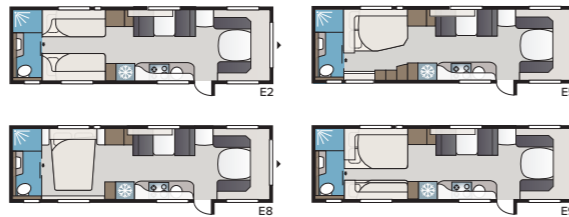

Imperial 880 TDL FK

This is the perfect choice if you love to cook. With a spacious kitchen that spans the entire width of the caravan's front and includes an exclusive induction stove top, built-in oven, microwave and a panorama window. 880 TDL FK has lots of room!

TECHNICAL SPECIFICATION	
Overall length	1040 cm
Overall height	278 cm
Overall width KS	250 cm
Body length	915 cm
Interior body length	820 cm
Interior height	196 cm
Interior width KS	235 cm
Living area KS	19,3 m ²
Bed space KS – Middle	211 x 117 cm
Rear E2	2 x 196 x 88 cm
E5	196 x 140/118 cm
E8	199 x 156/118 cm
E9	196 x 140 + 2 x 196 x 60 cm

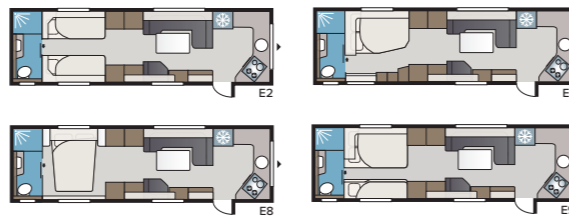

Imperial 880 BTDL

The standard version of this model features four to five bed spaces. The seating area in the front as well as the dinette area converts to extra beds and along with an overhead loft bed cabinet you can quickly fit up to nine people!

TECHNICAL SPECIFICATION	
Overall length	1040 cm
Overall height	278 cm
Overall width KS	250 cm
Body length	915 cm
Interior body length	820 cm
Interior height	196 cm
Interior width KS	235 cm
Living area KS	19,3 m ²
Bed space KS – Front	225 x 161/136 cm
Rear	196 x 140 cm
Dinette	191 x 88 cm
Double bunkbed	2 x 196 x 68 cm



Imperial 880 DTDL

Imperial 880 DTDL has lots of space! This model features an extra wide, transversed double bed and a bathroom that spans the entire width in the back of the caravan. A bedroom area just like home.

TECHNICAL SPECIFICATION	
Overall length	1040 cm
Overall height	278 cm
Overall width KS	250 cm
Body length	915 cm
Interior body length	820 cm
Interior height	196 cm
Interior width KS	235 cm
Living area KS	19,3 m ²
Bed space KS – Front	225 x 198/169 cm
Rear	188 x 156 cm

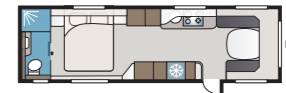



Imperial 880 GLE

Imperial 880 GLE is available in seven floor plans! You will definitely find an option that suits you and your family.

TECHNICAL SPECIFICATION	
Overall length	1040 cm
Overall height	278 cm
Overall width KS	250 cm
Body length	915 cm
Interior body length	820 cm
Interior height	196 cm
Interior width KS	235 cm
Living area KS	19,3 m ²
Bed space KS – Front	225 x 211/169 cm
Rear B2	2 x 196 x 88 cm
B5	196 x 160/138 cm
B8	190 x 150/60 cm
B10	196 x 156 cm
B14	196 x 129/102 + 2 x 196 x 68 cm
B15	196 x 129/102 + 188 x 63 + 2 x 196 x 68 cm
B16	199 x 156/118 cm
Dinette	191 x 88 cm

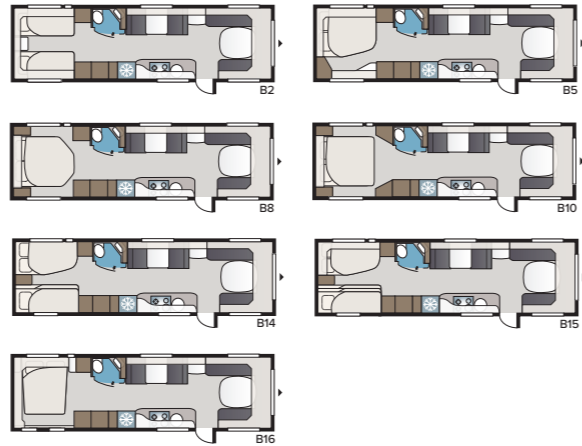

Imperial 1000 TDL

Imperial 1000 TDL measures an amazing 22 m². With our flexible floor plan solutions KABE Flexline, you can tailor the interior to suit your needs.

TECHNICAL SPECIFICATION	
Overall length	1160 cm
Overall height	278 cm
Overall width KS	250 cm
Body length	1035 cm
Interior body length	940 cm
Interior height	196 cm
Interior width KS	235 cm
Living area KS	22,0 m ²
Bed space KS – Front	225 x 198/169 cm
Rear E2	2 x 196 x 88 cm
E3	2 x 196 x 77 + 196 x 96 cm
E5	196 x 140 cm
E8	199 x 156/118 cm
E9	196 x 140 + 2 x 196 x 60 cm
DU	196 x 140 cm

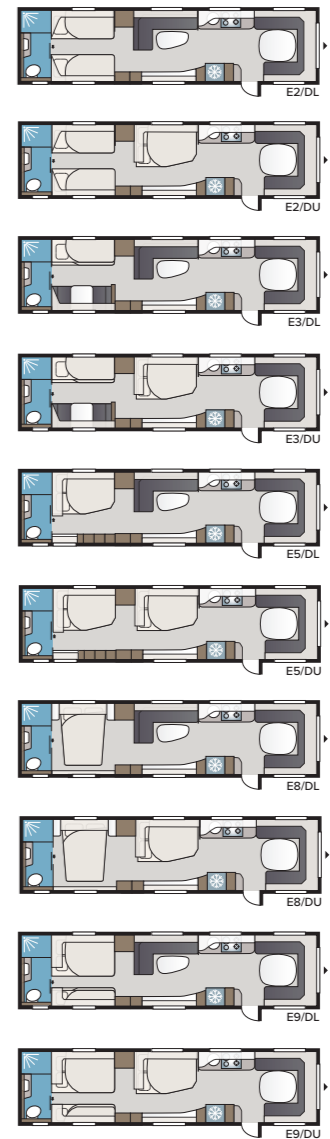

Options for Royal, Imperial

Give your KABE that little extra. We know what's needed for comfortable caravan living. Every KABE includes a generous list of standard equipment. To be honest, we offer many details that other manufacturers charge extra for. But we all have different needs. A wide range of options are available to complement your caravan and create the perfect solution for your family.

BODY



17" aluminium rims (standard in Imperial)



Tandem axles
Royal / Imperial 630 TDL
Royal 630 TDL FK
Royal 630 GLE
(standard in Imperial 630 TDL FK)

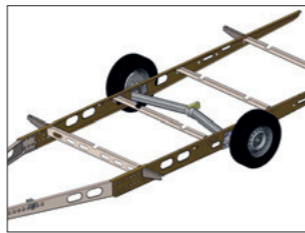

Total weight:
• 2000 kg (standard in Imperial)
• **NEW! 2300 kg** (single axle models 600-630)
• 2650 kg
• 2800 kg



Electric step



Panorama window in the front (only in KS, standard in FK)



Tinted windows



Entry door with a tinted window



NEW! Dometic Fresh Jet FJX4 2200 air conditioner (standard in Imperial)

CLIMATE / HEATING



Solar panel. Produce your own electricity! Environmentally friendly, easy and practical. The superior quality solar panel package from GoCamp provides 140 W. The panel's frame is constructed in heavy aluminium, with aerodynamic spoilers that reduce the wind noise when driving.

If you are free camping, the options large battery and solar panel are recommended.



Alde Flow in boiler 3030 Plus. With Alde Flow you can take a warm shower for as long as you like! Alde Flow is a separate warm water tank that can be connected to the glycol heating system. The tank preheats the fresh water before it reaches the boiler's ordinary hot water heater and provides constant flow of warm water.



SmartVent. A new, smart ventilation system is available as an option for Royal and Imperial. The ventilation is automatically controlled according to temperature and the amount of carbon dioxide and hydrocarbon in the air. The system consumes 7 percent less energy in cold weather compared to traditional ventilation and provides a higher quality of incoming air. A special filter reduces the amount of particles in the air and adjusts to a higher air exchange when the air becomes polluted (not for 630 TDL FK, 540 GLE).



Water purification system – Alde AquaClear UV-C (Alde Compact 3030 boiler). Efficient water purification that protects the user in a gentle and eco-friendly way. Unwanted viruses and bacteria, pesticides and chemicals are removed. The water is disinfected with UV-C light generated from LED's. In addition, the water passes through a carbon filter that removes any odour, bad taste and colour.

KITCHEN



Compressor refrigerator. Refrigerator with a 12 V compressor. Provides a spacious refrigerator with a generous freezer compartment.



Micro under the refrigerator (standard in Imperial, FK-modeller in lower kitchen cabinets)

LIVING ROOM



Removable table support (standard in FK-models, not for 540 GLE)



Hollywood leather upholstery
• Front seating
• Front seating + middle dinette (standard in Imperial)



Baltimore leather upholstery
• Front seating
• Front seating + middle dinette (standard in Imperial)



NEW! Lancaster artificial leather
• Front seating
• Front seating + middle dinette (standard in Imperial)

BEDROOM

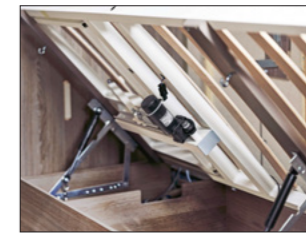

Electric adjustable headboard (standard in Imperial, not in E9 bed)

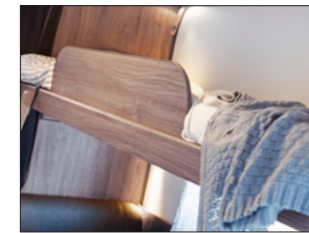

Loft bed cabinet with doors (only certain bedroom solutions and middle dinette area)



Fitted carpet

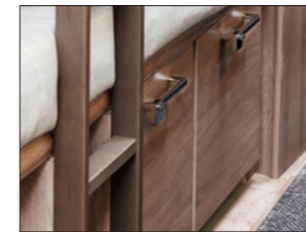

Storage under bunk bed (B14, E9)

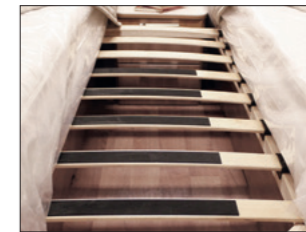

Grand Lit B2 (extra large bed) – convert two single beds to one double bed (only in GLE-models)

BATHROOM



Wood shower floor insert – Royal, Imperial (TDL, DXL)



Thetford toilet with a ceramic bowl (standard in Imperial)



Cinderella combustion toilet. Cinderella is a modern and environmentally friendly toilet solution with a large capacity and high operational reliability. Paper, urine and faeces are burned at a high temperature resulting in a minimal amount of ash, about one cup per person per month. Clean, hygienic and odourless (TDL-models in Royal and Imperial and 780 D GLE).

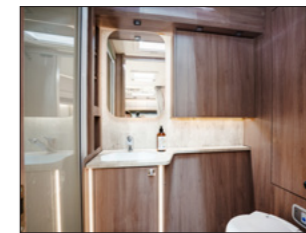

Mirror image TDL bathroom for the following Flexline solutions: E2, E8 (except for 630 TDL FK, Cinderella toilet or 880TDL with E8-solution)



Mirror image floor plan for bedroom and bathroom, E8-solution



Shower instead of console (DXL)



Fan in the shower stall (TDL, 780 D GLE)



Shower pump (TDL-models)

ELECTRIC / TECHNOLOGY



Electricity meter in the electrical box



AGM 130 Ah battery incl. case



Mover:
• Tandem axle
• Single axle



Converter DC121210 – Booster (reinforced charge while driving)



External antenna for router

ELECTRIC / TECHNOLOGY



KABE Smart D Remote. KABE Smart D Remote* enables you to manage the control panel remotely, from anywhere. KABE Smart D Remote is built with a 4G router with an internal antenna and a mobile modem (external antenna is available as an option). In addition to managing heating, lighting and keep track of the caravan's functions and alarms via your cell phone, you also have access to a wireless internet connection on the road.

* With your purchase of KABE Smart D Remote, a 36 month subscription is included. After 36 months, you will pay a yearly fee for the use of the app. A separate mobile data subscription is also required.

ADDITIONAL EQUIPMENT



NEW! Lithium battery 150 Ah



Duocontrol. Duocontrol has a built-in automatic gas switch, reduction valve and collision sensor which is triggered on impact with a G-force of 3.5 G. The supply of gas is shut off immediately to avoid a gas leak. Duo Control is approved in all of Europe and allows for the gas to be on while driving.



Direct drain – wastewater bypass tank (standard in Imperial)



City water



70 litre water tank (not for 600 TDL, 630 TDL / TDL FK)



KABE Smart Level – makes your KABE-life even simpler!

In 2023, we expanded our Smart D panel with KABE Smart Level which includes three useful functions. Smart Level tracks your gas level (with the use of one gas bottle, not for composite bottles), tyre air pressure and the inclination of the caravan. Don't worry about running out of gas in the middle of your trip, the panel displays your current gas level. The tyre air pressure sensor helps you ensure that the tyres have the right air pressure for a safe and fuel-efficient drive. Additionally, a level indicator is included with KABE Smart Level. When your caravan is parked, the display shows your caravan's inclination. An important factor for a pleasant and functional stay.

With KABE Smart Level, we improve your KABE-life even a bit more! (standard in Imperial)

ECO-PACKAGE



150 Ah lithium battery with battery sensor



AirVent



Solar panel

The eco-package is perfect when you want the freedom to camp anywhere for a longer period of time, without worrying about the supply of electricity. AirVent replaces AC and provides a more energy efficient cooling of the caravan. The new 150 Ah lithium battery is more durable than an ordinary battery and with solar panels you can produce your own electricity.



YOUR KABE DEALER